

OKLAHOMA DEPARTMENT OF TRANSPORTATION
SURVEY DIVISION

FLOOD INFORMATION FORM

| | |
|--|--|
| Division #: 7 | 1 <input type="checkbox"/> 2 <input type="checkbox"/> 3 <input type="checkbox"/> 4 <input type="checkbox"/> 5 <input type="checkbox"/> 6 <input type="checkbox"/> 7 <input checked="" type="checkbox"/> 8 <input type="checkbox"/> |
| County: | CADDO |
| Date Highwater occurred: | 08/18/07 |
| Highway Number: | S.H. 58 |
| Name of Stream: | N/A |
| Direction and distance from nearest town, or highway junction | LOCATION IS 6.6 MILES SOUTH OF JCT. S.H. 9 & S.H. 58 IN CARNAGIE. |
| Section, Township, Range: | BETWEN SECTIONS 7 & 8, T-6-N, R-13-W, I.M. |
| Description of Location: | 2-10'X10'X32' RDY. RCB. |
| Highwater Elevation: | 1406.8 (Asphalt, 1402.3) |
| Level Datum & Source: | FAS NO. S-680(3) |
| Method used: | Differential Leveling |
| Date Elevation Obtained: | 08/20/07 |
| Apparent Magnitude: | Normal <input type="checkbox"/> Medium <input type="checkbox"/> Extreme <input checked="" type="checkbox"/> Don't Know <input type="checkbox"/> |
| Was Highwater Mark obtained from actual water, drift, local resident, or other source? | HIGHWATER MARK WAS OBTAINED BY REMNANTS OF DRIFT. |
| Explanatory Remarks: | |

Note: Show Vicinity Map on back of form

Name (signature)

Name (Printed)

DANNY R. DEES, PLS

Date: 11/07/07

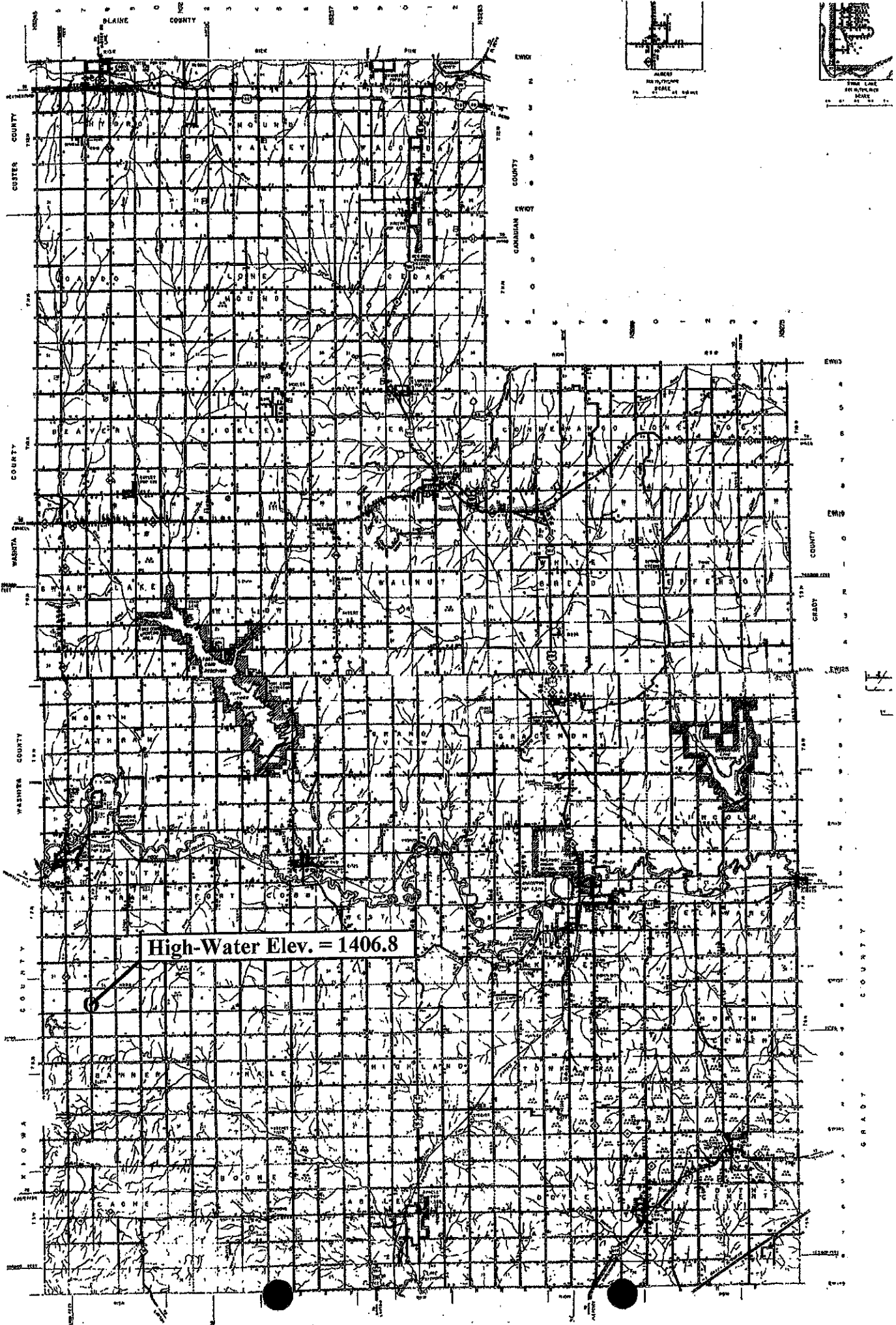

High-Water Elev. = 1406.8

F 17