

OKLAHOMA DEPARTMENT OF TRANSPORTATION
SURVEY DIVISION

FLOOD INFORMATION FORM

Division #: 7	1 <input type="checkbox"/> 2 <input type="checkbox"/> 3 <input type="checkbox"/> 4 <input type="checkbox"/> 5 <input type="checkbox"/> 6 <input type="checkbox"/> 7 <input checked="" type="checkbox"/> 8 <input type="checkbox"/>
County:	CADDO
Date Highwater occurred:	08/18/07
Highway Number:	S.H. 9
Name of Stream:	N/A
Direction and distance from nearest town, or highway junction	LOCATION IS 2.4 MILES NORTHEAST OF JCT. SH 9 & US 62 NORTH OF APACHE.
Section, Township, Range:	SECTION 30, T-7-N, R-12-W, I.M.
Description of Location:	CONCRETE BRIDGE
Highwater Elevation:	1282.4 (Asphalt, 1280.8)
Level Datum & Source:	FAP NO. 238 AND SAP NO. 599
Method used:	Differential Leveling
Date Elevation Obtained:	08/21/07
Apparent Magnitude:	Normal <input type="checkbox"/> Medium <input type="checkbox"/> Extreme <input checked="" type="checkbox"/> Don't Know <input type="checkbox"/>
Was Highwater Mark obtained from actual water, drift, local resident, or other source?	HIGHWATER MARK WAS OBTAINED BY REMNANTS OF DRIFT.
Explanatory Remarks:	

Note: Show Vicinity Map on back of form

Name (signature) D. R. Dees
Name (Printed) DANNY R. DEES, PLS
Date: 11/07/07

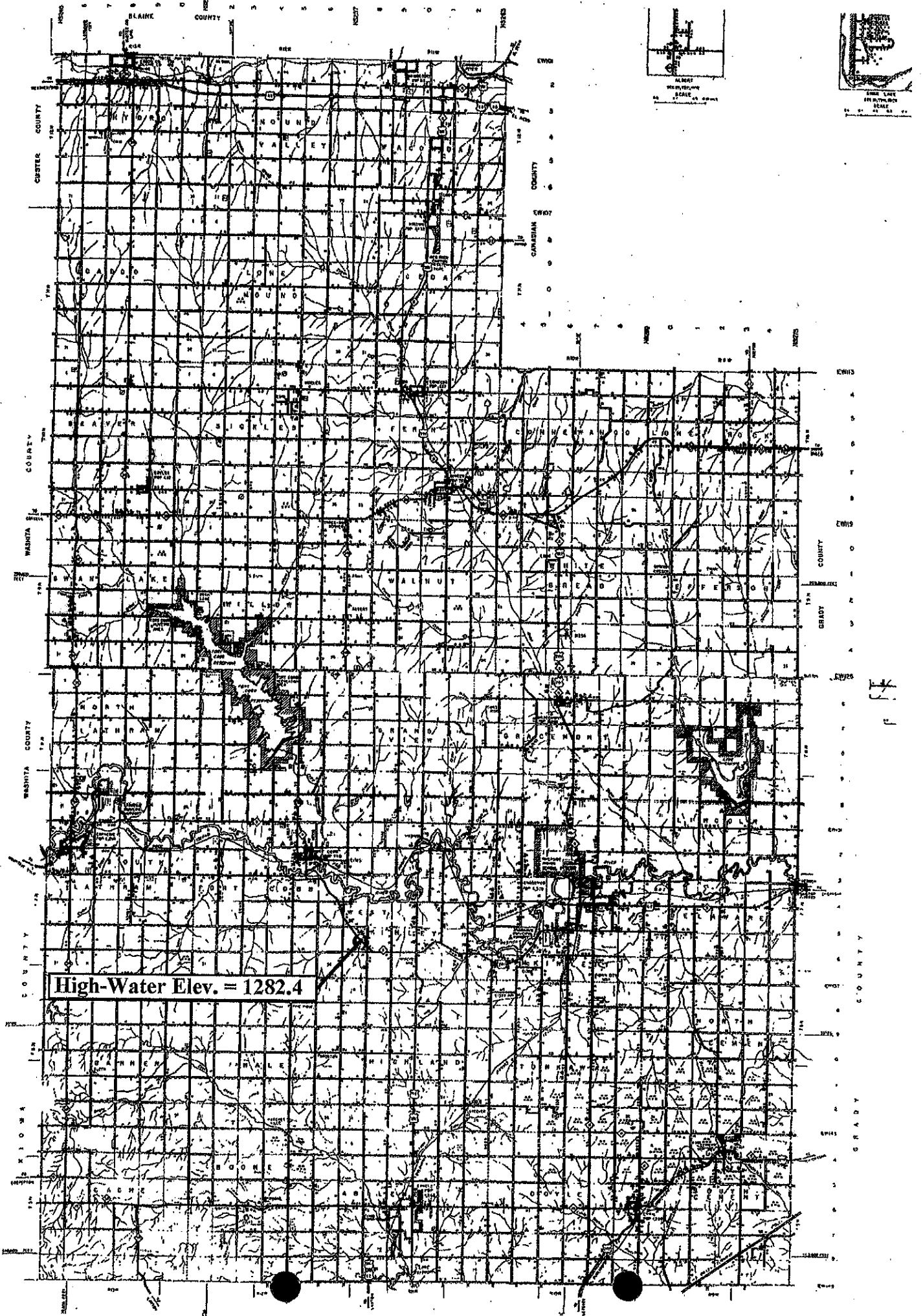

High-Water Elev. = 1282.4

117