

OKLAHOMA DEPARTMENT OF TRANSPORTATION
SURVEY DIVISION

FLOOD INFORMATION FORM

Division #: 7	1 <input type="checkbox"/> 2 <input type="checkbox"/> 3 <input type="checkbox"/> 4 <input type="checkbox"/> 5 <input type="checkbox"/> 6 <input type="checkbox"/> 7 <input checked="" type="checkbox"/> 8 <input type="checkbox"/>
County:	CADDO
Date Highwater occurred:	08/18/07
Highway Number:	S.H. 146
Name of Stream:	N/A
Direction and distance from nearest town, or highway junction	LOCATION IS 0.7 MILES NORTH OF JCT. S.H. 9 & S.H. 146 NORTH OF FORT COBB
Section, Township, Range:	BETWEEN SECTIONS 34 & 35, T-8-N, R-12-W, I.M.
Description of Location:	3-24" CGMPA CROSS-DRAIN
Highwater Elevation:	1320.1 (Asphalt, 1318.3)
Level Datum & Source:	LEVEL DATUM TAKEN FROM QUAD SHEET (NO PLANS)
Method used:	Differential Leveling
Date Elevation Obtained:	08/21/07
Apparent Magnitude:	Normal <input type="checkbox"/> Medium <input type="checkbox"/> Extreme <input checked="" type="checkbox"/> Don't Know <input type="checkbox"/>
Was Highwater Mark obtained from actual water, drift, local resident, or other source?	HIGHWATER MARK WAS OBTAINED BY REMNANTS OF DRIFT.
Explanatory Remarks:	

Note: Show Vicinity Map on back of form

Name (signature)

Name (Printed)

DANNY R. DEES, PLS

Date: 11/07/07

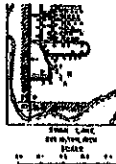
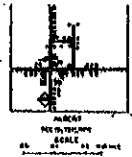
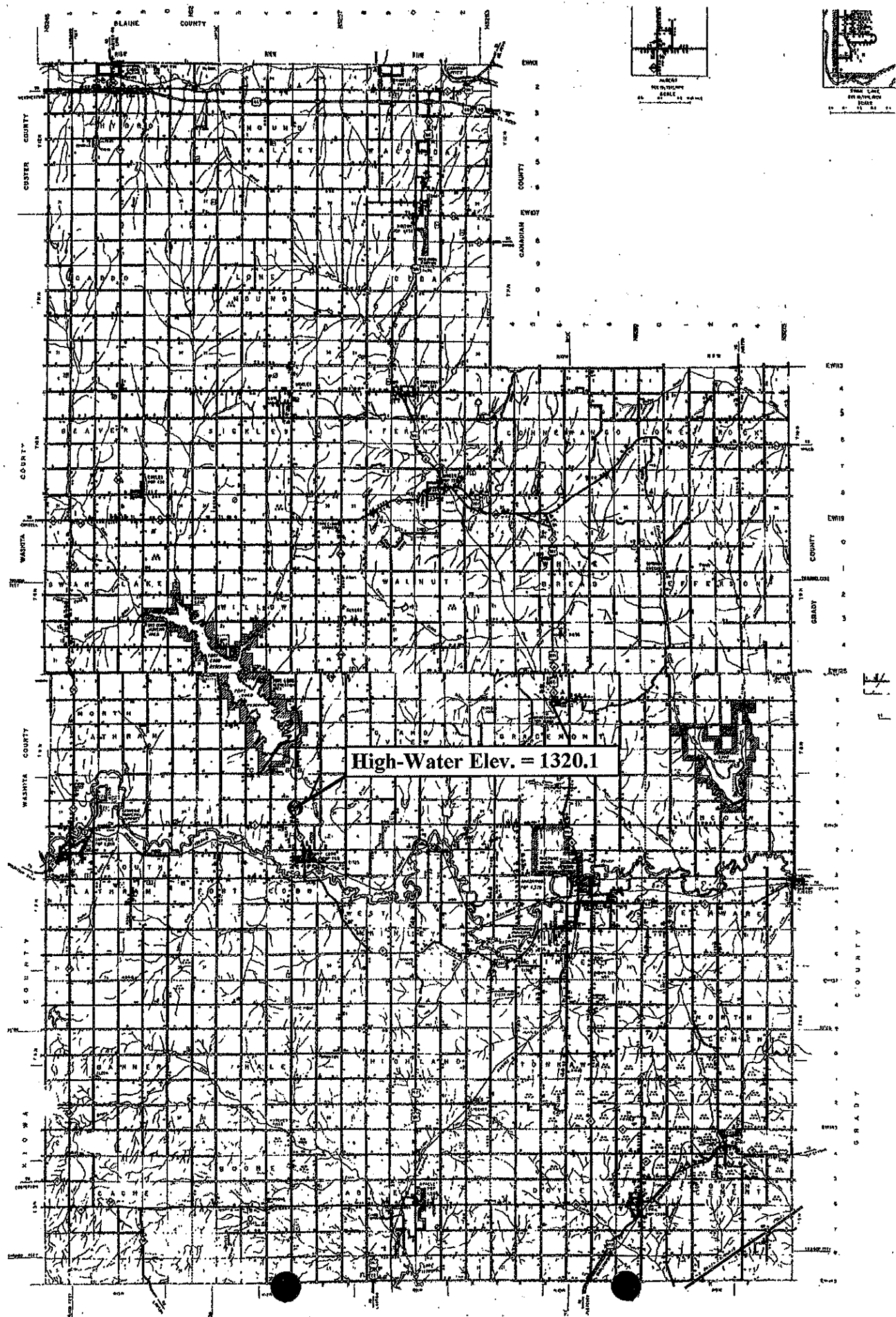

High-Water Elev. = 1320.1

F 11