

OKLAHOMA DEPARTMENT OF TRANSPORTATION
SURVEY DIVISION

FLOOD INFORMATION FORM

Division #: 7	1 <input type="checkbox"/> 2 <input type="checkbox"/> 3 <input type="checkbox"/> 4 <input type="checkbox"/> 5 <input type="checkbox"/> 6 <input type="checkbox"/> 7 <input checked="" type="checkbox"/> 8 <input type="checkbox"/>
County:	CADDO
Date Highwater occurred:	08/18/07
Highway Number:	U.S. 62
Name of Stream:	N/A
Direction and distance from nearest town, or highway junction	LOCATION IS 1.0 MILES SOUTH OF JCT. S.H. 19 & U.S. 62 AT NORTH EDGE OF APACHE.
Section, Township, Range:	BETWEN SECTIONS 21 & 28, T-5-N, R-11-W, I.M.
Description of Location:	INTERSECTION AT JULIA MAHSEET ROAD AND U.S. 62
Highwater Elevation:	1251.8 (Asphalt, 1249.8)
Level Datum & Source:	FAP NO. F-232(67)
Method used:	Differential Leveling
Date Elevation Obtained:	08/20/07
Apparent Magnitude:	Normal <input type="checkbox"/> Medium <input type="checkbox"/> Extreme <input checked="" type="checkbox"/> Don't Know <input type="checkbox"/>
Was Highwater Mark obtained from actual water, drift, local resident, or other source?	HIGHWATER MARK WAS OBTAINED BY REMNANTS OF WATER MARK ACROSS HIGHWAY.
Explanatory Remarks:	

Note: Show Vicinity Map on back of form

Name (signature)

Name (Printed)

Date: 11/07/07

DANNY R. DEES, PLS

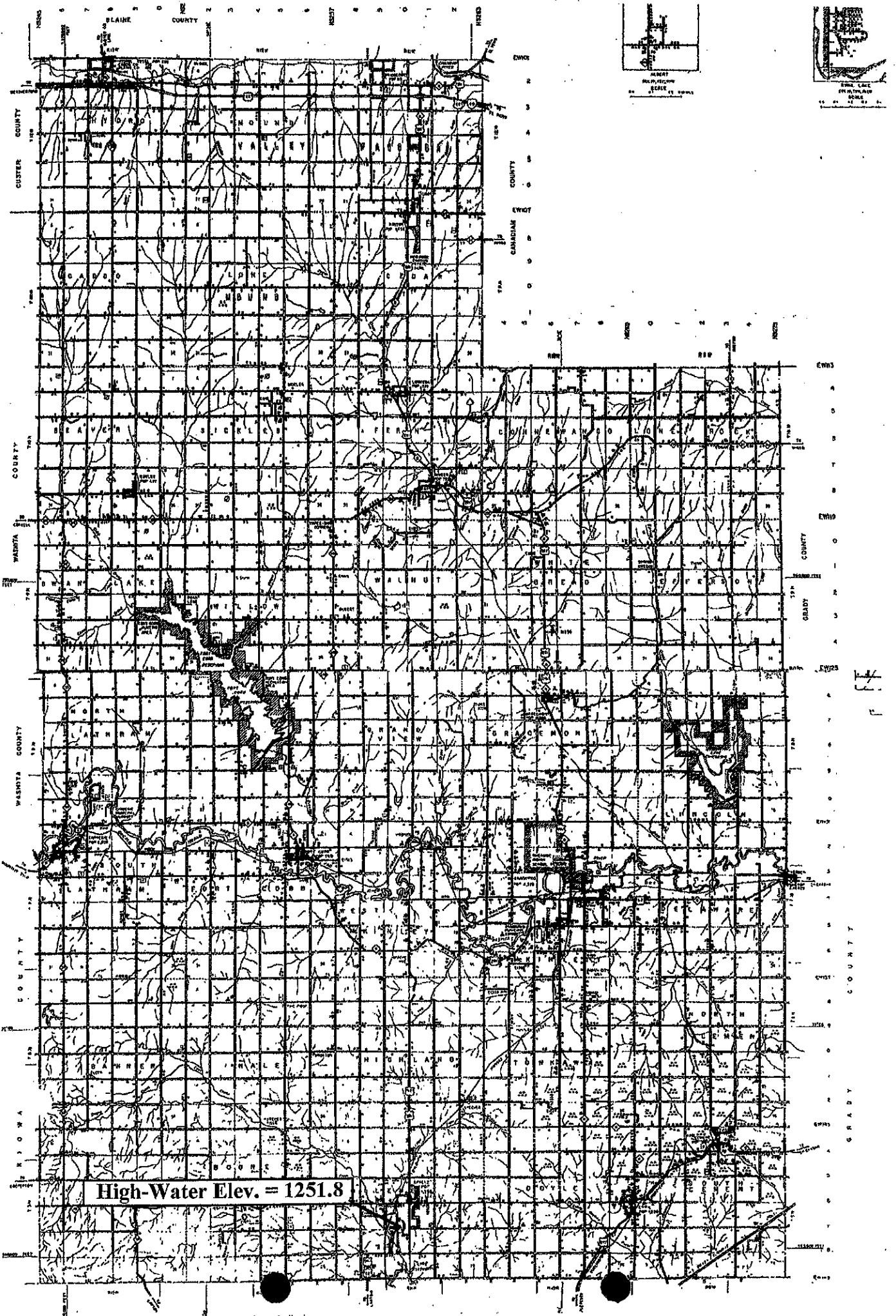

High-Water Elev. = 1251.8

177