



**OKLAHOMA DEPARTMENT OF TRANSPORTATION  
SURVEY DIVISION**

**FLOOD INFORMATION FORM**

<b>Division #:</b>	1 <input type="checkbox"/> 2 X 3 <input type="checkbox"/> 4 <input type="checkbox"/> 5 <input type="checkbox"/> 6 <input type="checkbox"/> 7 <input type="checkbox"/> 8 <input type="checkbox"/>
<b>County:</b>	Bryan
<b>Date High-water occurred:</b>	1944
<b>Highway Number:</b>	SH 78
<b>Name of Stream:</b>	Red River
<b>Direction and distance from nearest town, or highway junction</b>	From Achille on SH78 go 0.5 miles east, 1.5 miles south, 10.0 miles east, and 3.9 miles south southeast to bridge.
<b>Section, Township, Range:</b>	Section 19, T-9-S, R-11-E
<b>Description of Location:</b>	Station 126+02 on SWO4637(1)
<b>High-water Elevation:</b>	501.9 feet
<b>Level Datum &amp; Source:</b>	NAVD 88 from SWO 4637 (1)
<b>Method used:</b>	Total Station
<b>Date Elevation Obtained:</b>	10/26/2015
<b>Apparent Magnitude:</b>	Normal <input type="checkbox"/> Medium <input type="checkbox"/> Extreme X Don't Know <input type="checkbox"/>
<b>Was Highwater Mark obtained from actual water, drift, local resident, or other source?</b>	Highwater information was obtained from SWO 4637(1) and it states that high-water elevation was taken from U.S.P.W. No. N.R.S. 955 Plans (1935). Local residents state that the water level has not reached or exceeded this elevation since completion of the Denison Dam in 1944. High-water elevation recorded by field crew on 10/26/05 did not exceed the above stated elevation.
<b>Explanatory Remarks:</b>	Heavy rains in upper drainage area

Note: Show Vicinity Map on back of form

Name (signature) \_\_\_\_\_

Name (Printed)

Date:

DARREL RAY MASON

10/26/2015

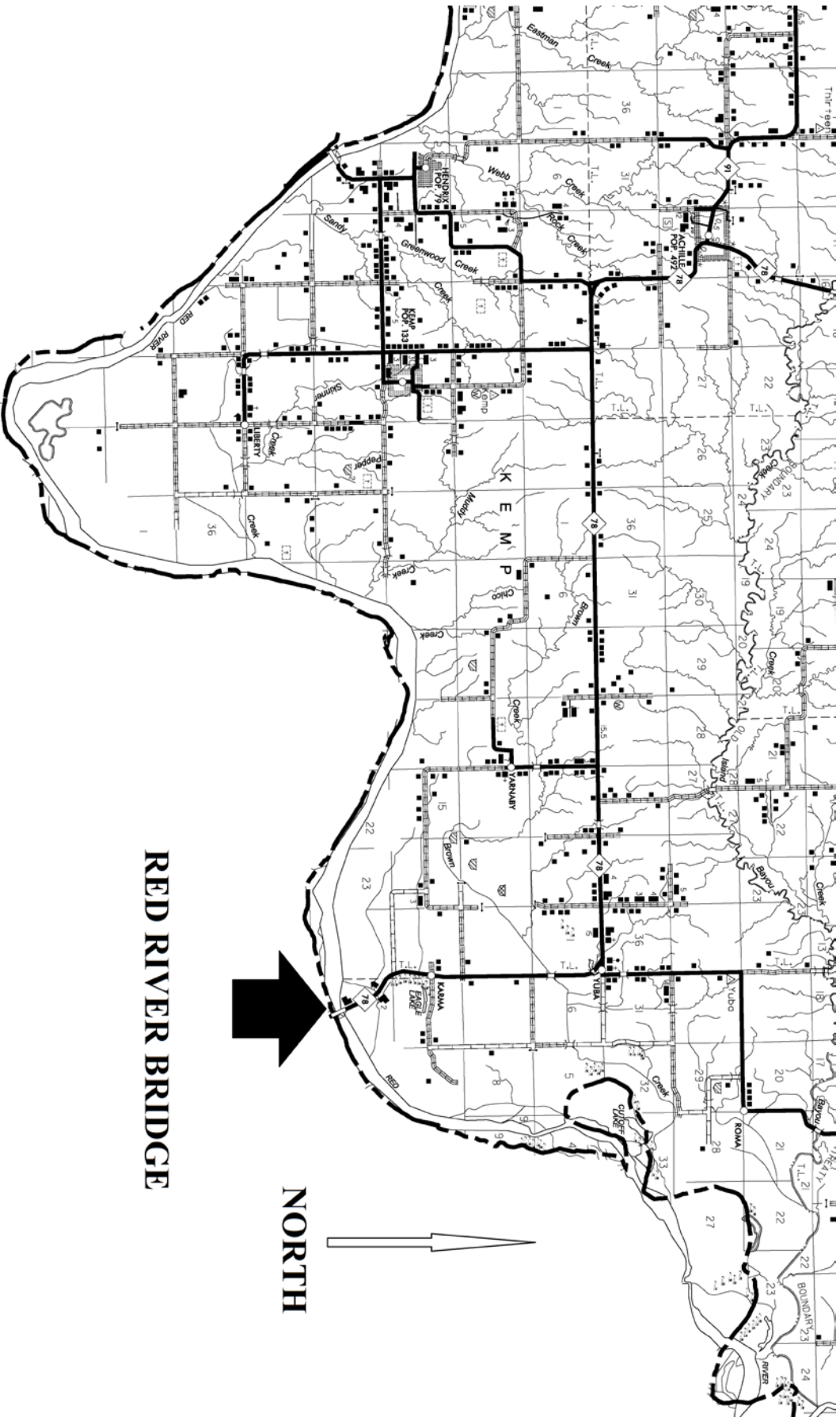

**RED RIVER BRIDGE**



**NORTH**

