

RECEIVED
NOV 2 1981
SURVEY DIVISION

Survey Division
Form No. 16
Rev. Sept. 10, 1961

STATE OF OKLAHOMA
DEPARTMENT OF HIGHWAYS
SURVEY DIVISION

FLOOD INFORMATION FORM

To be used in obtaining and transmitting flood water elevations for Survey Division office record files. This information to be obtained by all Chiefs of Party or others in their vicinity in times of unusual high water, or at any time available from a reliable source. The elevations can be recorded by level reading, by measurement from bridge floor, in relation to a house, above roadbed or any other dependable, clear manner that fits the situation, the highest order possible to be used. Separate report to be made on each crossing or place obtained.

County BRYAN Date highwater occurred OCTOBER 13; 1981

Highway number SH. 78 Name of stream Little BLUE RIVER

Direction and distance from nearest town, village or store APPROX. 1 MILE SOUTH AND 1/2 MILE EAST OF COBB, OKLA.

Section, Township and Range SEC. 31, T-5-S, R-9-E - AND SEC. 6, T-6-S, R-9-E.

Description of Location SH. 78 - BRIDGE OVER LITTLE BLUE RIVER.

Elevation 2.5 FT. ABOVE BRIDGE FLOOR Source of levels ASSUMED

Method obtained MEASURED FROM BRIDGE Date obtained OCTOBER 14, 1981

Did it appear to be normal medium extreme do not know

Was highwater mark obtained from actual water, drift, local resident, U. S. Engineers, etc.? DRIFT ON BRIDGE AND ACTUAL HIGHWATER

Explanatory Remarks HEAVY RAIN IN AREA AND UPPER STREAM DRAINAGE AREA. ROAD CLOSED FOR AWHILE

Location to be shown on back of this sheet as a check.

Field Note: To be sent to
Survey Engineer

Odafog Sib
~~CHIEF OF PARTY~~ LOC. ENGR.
OCTOBER 22, 1981
Date

Copy to Bridge Div. 11-1-81

Location No. 15

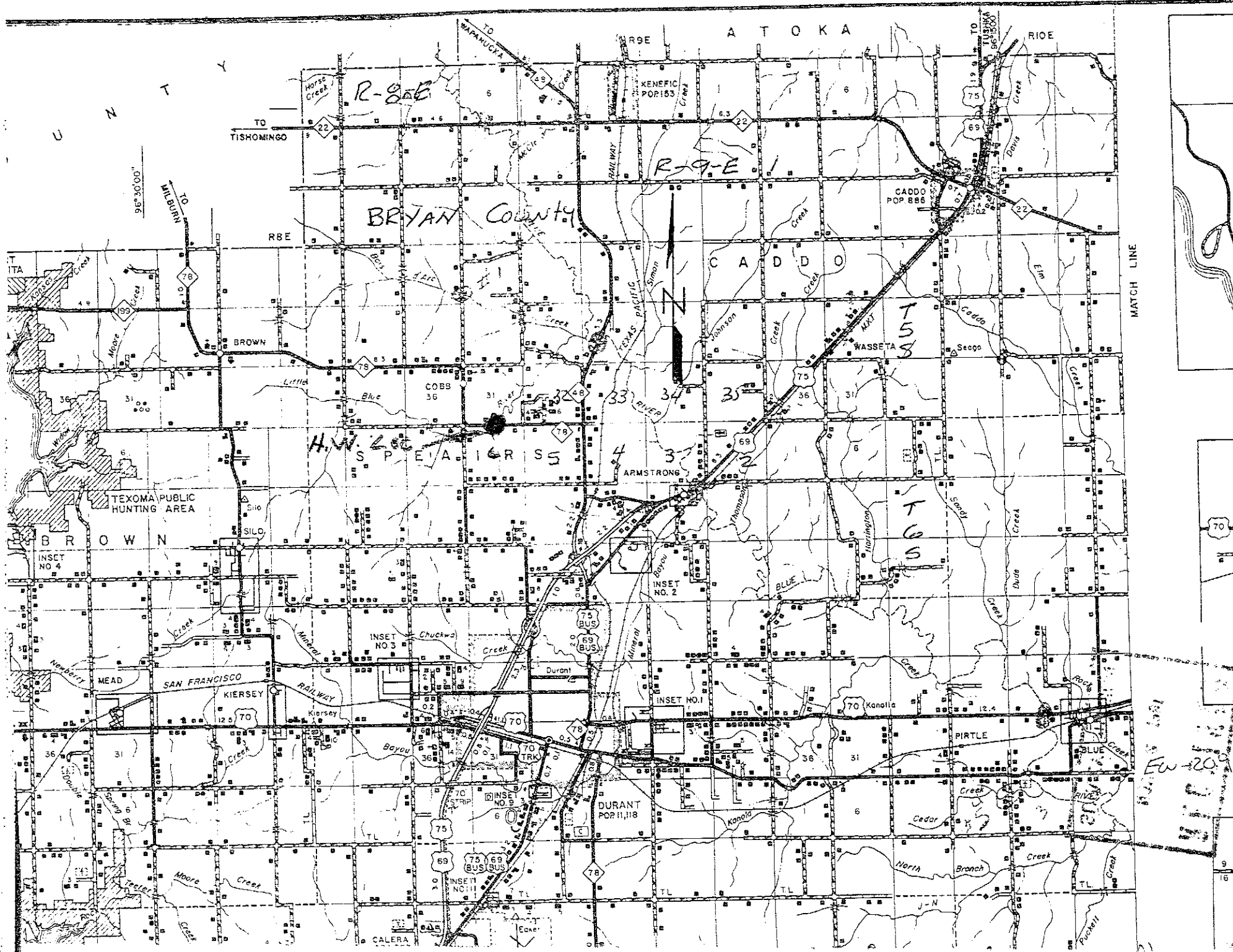

MATCH LINE

Handwritten notes and scribbles in the bottom right corner, including 'FW 20' and other illegible markings.