

**RECEIVED**  
NOV 2 1981  
SURVEY DIVISION

Survey Division  
Form No. 16  
Rev. Sept. 10, 1961

STATE OF OKLAHOMA  
DEPARTMENT OF HIGHWAYS  
SURVEY DIVISION

FLOOD INFORMATION FORM

To be used in obtaining and transmitting flood water elevations for Survey Division office record files. This information to be obtained by all Chiefs of Party or others in their vicinity in times of unusual high water, or at any time available from a reliable source. The elevations can be recorded by level reading, by measurement from bridge floor, in relation to a house, above roadbed or any other dependable, clear manner that fits the situation, the highest order possible to be used. Separate report to be made on each crossing or place obtained.

County BRYAN Date highwater occurred OCTOBER 13, 1981

Highway number SH. 48 Name of stream BLUE RIVER

Direction and distance from nearest town, village or store APPROX. 6.3 MILES NORTH ON SH. 48 FROM JCT. OF US 70 AND SH. 48 IN DURANT OKLA.

Section, Township and Range SECTION 28, T-5-S, R-9-E.

Description of Location APPROX. 16" OF WATER ON BRIDGE FLOOR.

Elevation 589.1 Source of levels FAS S-460 (3) PLANS.

Method obtained MEASURED FROM BRIDGE FLOOR Date obtained OCTOBER 14, 1981

Did it appear to be  normal  medium  extreme  do not know

Was highwater mark obtained from actual water, drift, local resident, U. S. Engineers, etc.? ACTUAL WATER

Explanatory Remarks THE ROAD TO THE NORTH WAS UNDER WATER FOR APPROX. 1/2 MILE FROM BRIDGE. THIS ROAD WAS CLOSED FOR APPROX. 12 HRS.

Location to be shown on back of this sheet as a check.

Field Note: To be sent to  
Survey Engineer

*R. D. Ray*  
~~CHIEF OF PARTY~~ LOC. ENGR.

OCTOBER 22, 1981  
Date

*copy to Bridge Div. 11-4-81*

*Location No. 21*

R-9-E

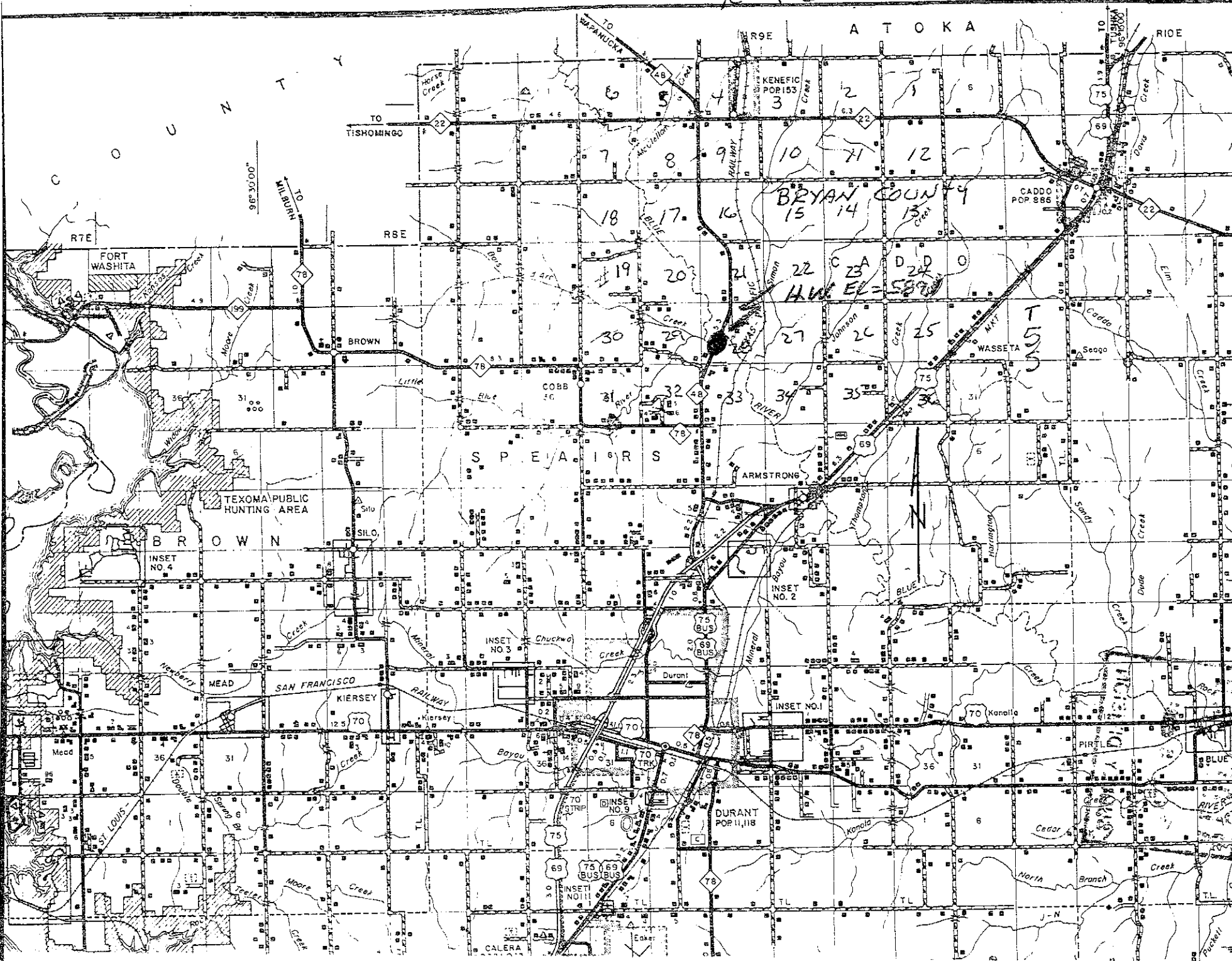

C O U N T Y

96° 30' 00"

TO MILBURN

TO TISHOMINGO

TO WAPATUCKA

TO RICE

TO LUSHK

BRYAN COUNTY

HULL EL = 5870

CADDO POP 886

ARMSTRONG

FORT WASHITA

BROWN

INSET NO. 4

TEXOMA PUBLIC HUNTING AREA

SPEARS

SAN FRANCISCO

KIERSEY

DURANT

DURANT POP 1,118

MEAD

MEAD

MEAD

MEAD

KANOLA

KANOLA

KANOLA

INSET NO. 9

INSET NO. 11

INSET NO. 1

INSET NO. 3

INSET NO. 2

INSET NO. 4

INSET NO. 4

INSET NO. 4

INSET NO. 4

INSET NO. 4

INSET NO. 4

INSET NO. 4

INSET NO. 4

INSET NO. 4

INSET NO. 4

INSET NO. 4

INSET NO. 4