

OKLAHOMA DEPARTMENT OF TRANSPORTATION
SURVEY DIVISION

FLOOD INFORMATION FORM

Division #:	1 <input type="checkbox"/> 2 <input type="checkbox"/> 3 <input type="checkbox"/> 4 <input type="checkbox"/> 5 <input checked="" type="checkbox"/> 6 <input type="checkbox"/> 7 <input type="checkbox"/> 8 <input type="checkbox"/>
County:	Blaine
Date Highwater occurred:	8/18/07
Highway Number:	S.H. 58
Name of Stream:	
Direction and distance from nearest town, or highway junction	5.5 miles north of the jct. of U.S.66 and S.H.58 or 4.5 miles southeast of the Custer, Blaine Co. line. Sta. 263+35 5x5 rcb
Section, Township, Range:	Between sec.17&20 T-13-N, R-13-W
Description of Location:	0.8 above road at structure
Highwater Elevation:	1658.35
Level Datum & Source:	FASP NO.S-701(5) & (6) C.S.
Method used:	Level
Date Elevation Obtained:	8/30/07
Apparent Magnitude:	Normal <input type="checkbox"/> Medium <input type="checkbox"/> Extreme <input checked="" type="checkbox"/> Don't Know <input type="checkbox"/>
Was Highwater Mark obtained from actual water, drift, local resident, or other source?	Drift
Explanatory Remarks:	

Note: Show Vicinity Map on back of form

Name (signature)

Daryl Williams

Name (Printed)

Daryl Williams

Date:

Survey Division

Form No. 16

Revised: 5/09/2007

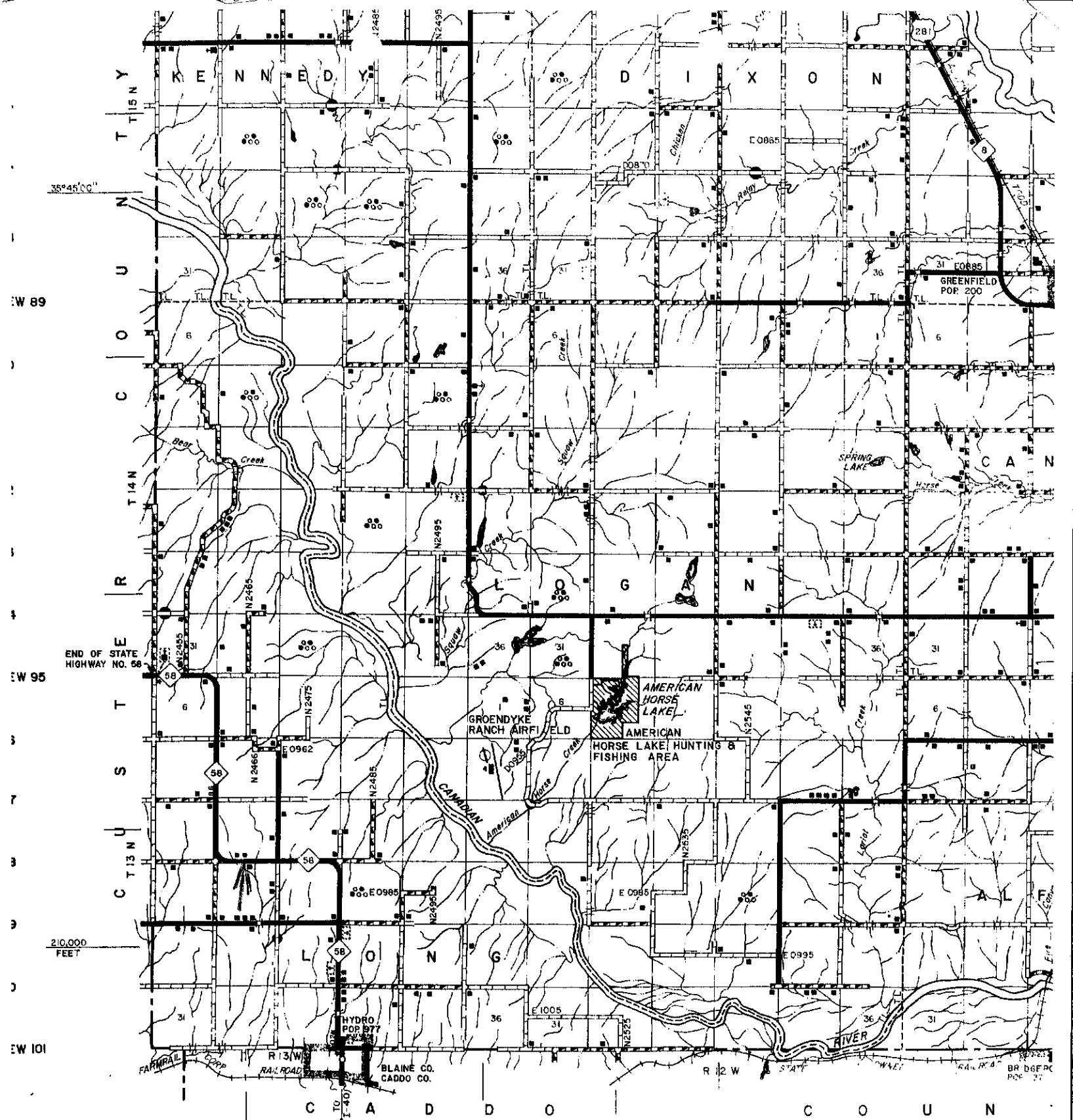

35°45'00"

EW 89

EW 95

210,000 FEET

EW 101

1820,000 FEET

98°30'00"

T 15 N
T 14 N
T 13 N

K E N N E D Y
D I X O N
G N
L O N G
C A D D O

FARM RAILROAD
R 13 W
RAILROAD
I-40
BLAINE CO.
CADDO CO.
R 12 W
STATE
WALTON
RAILROAD
BRIDGE
POP 200

GROENDYKE RANCH AIRFIELD
AMERICAN HORSE LAKE
HORSE LAKE HUNTING & FISHING AREA

GREENFIELD
POP 200

HYDRO.
POP 977