



OKLAHOMA DEPARTMENT OF TRANSPORTATION  
SURVEY DIVISION

FLOOD INFORMATION FORM

Division #:	1 <input type="checkbox"/> 2 <input type="checkbox"/> 3 <input type="checkbox"/> 4 <input type="checkbox"/> 5 <input checked="" type="checkbox"/> 6 <input type="checkbox"/> 7 <input type="checkbox"/> 8 <input type="checkbox"/>
County:	Blaine
Date Highwater occurred:	8/18/2007
Highway Number:	S.H. 33
Name of Stream:	
Direction and distance from nearest town, or highway junction	0.6 miles east of Jct. US281 & SH33 at Watonga. (12'x14'x12')x9' rcb
Section, Township, Range:	Between Sec. 30 & 19, T-16-N, R-11-W
Description of Location:	0.4' below centerline of Hwy. at str.
Highwater Elevation:	1513.01
Level Datum & Source:	NAVD88 from NGS OPUS solution
Method used:	RTK
Date Elevation Obtained:	8/21/2007
Apparent Magnitude:	Normal <input type="checkbox"/> Medium <input type="checkbox"/> Extreme <input checked="" type="checkbox"/> Don't Know <input type="checkbox"/>
Was Highwater Mark obtained from actual water, drift, local resident, or other source?	Water line on building.
Explanatory Remarks:	After 10" rain overnight.

Note: Show Vicinity Map on back of form

Name (signature) Daryl Williams  
Name (Printed) Daryl Williams  
Date: August 30, 2007

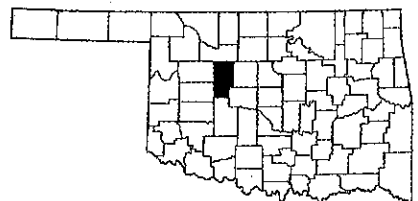
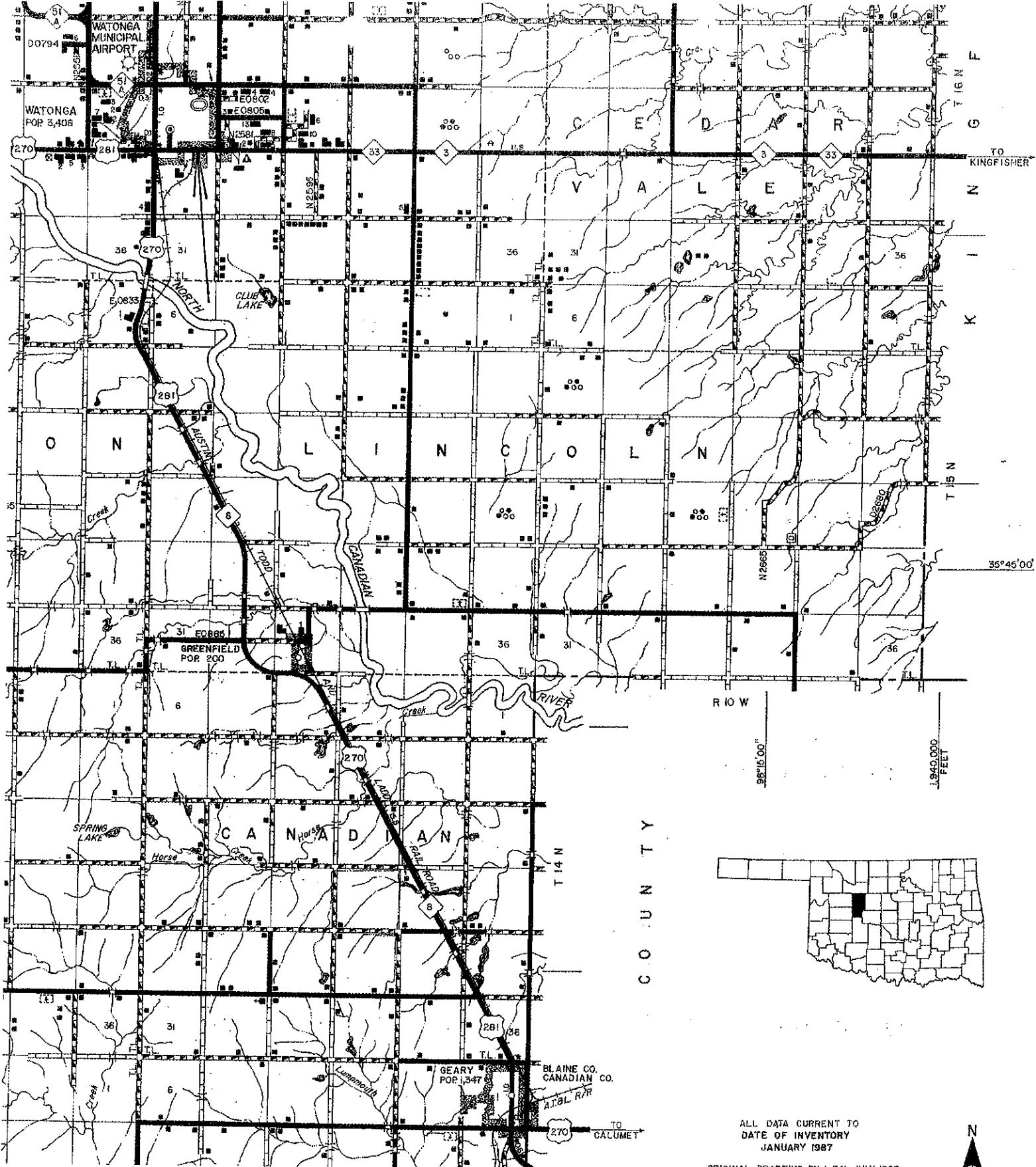

ALL DATA CURRENT TO  
 DATE OF INVENTORY  
 JANUARY 1987  
 ORIGINAL DRAFTING BY J R K JULY 1988

