

OKLAHOMA DEPARTMENT OF TRANSPORTATION  
SURVEY DIVISION

FLOOD INFORMATION FORM

Division #:	1 <input type="checkbox"/> 2 <input type="checkbox"/> 3 <input type="checkbox"/> 4 <input type="checkbox"/> 5 <input checked="" type="checkbox"/> 6 <input type="checkbox"/> 7 <input type="checkbox"/> 8 <input type="checkbox"/>
County:	Blaine
Date Highwater occurred:	8/18/2007
Highway Number:	S.H. 33
Name of Stream:	
Direction and distance from nearest town, or highway junction	1.5 miles east of Jct. US281 & SH33 at Watonga. F.A.P. No. 276-G(2) (1937) Sta. 551+96 6'x2' rcb
Section, Township, Range:	Between Sec. 29 & 20, T-16-N, R-11-W
Description of Location:	0.1' below centerline of Hwy. at str.
Highwater Elevation:	1518.11
Level Datum & Source:	NAVD88 from NGS OPUS solution
Method used:	RTK
Date Elevation Obtained:	8/21/2007
Apparent Magnitude:	Normal <input type="checkbox"/> Medium <input type="checkbox"/> Extreme <input checked="" type="checkbox"/> Don't Know <input type="checkbox"/>
Was Highwater Mark obtained from actual water, drift, local resident, or other source?	drift
Explanatory Remarks:	After 10" rain overnight.

Note: Show Vicinity Map on back of form

Name (signature)

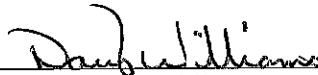

Name (Printed)

Daryl Williams

Date:

August 30, 2007

Survey Division

Form No. 16

Revised: 5/09/2007

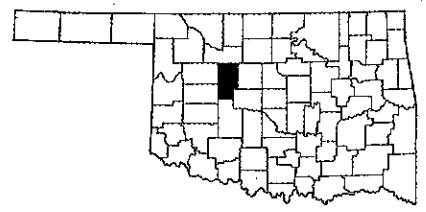
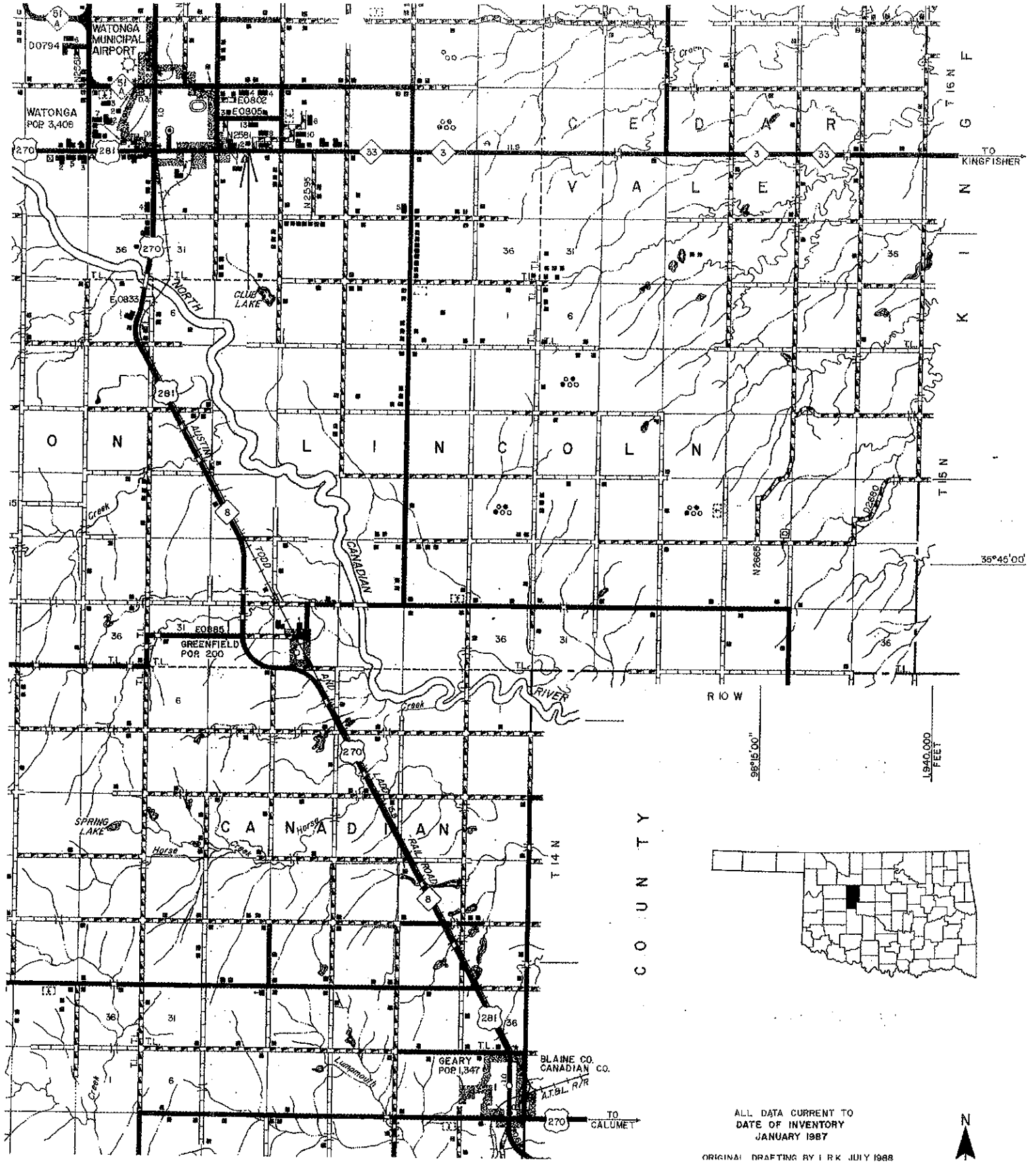

ALL DATA CURRENT TO  
DATE OF INVENTORY  
JANUARY 1987

ORIGINAL DRAFTING BY I R K JULY 1988

