

OKLAHOMA DEPARTMENT OF TRANSPORTATION
SURVEY DIVISION

FLOOD INFORMATION FORM

| | |
|--|--|
| Division #: | 1 <input type="checkbox"/> 2 <input type="checkbox"/> 3 <input type="checkbox"/> 4 <input type="checkbox"/> 5 <input checked="" type="checkbox"/> 6 <input type="checkbox"/> 7 <input type="checkbox"/> 8 <input type="checkbox"/> |
| County: | Blaine |
| Date Highwater occurred: | 8/18/2007 |
| Highway Number: | S.H. 33 |
| Name of Stream: | |
| Direction and distance from nearest town, or highway junction | 2.4 miles east of Jct. US281 & SH33 at Watonga. F.A.P. No. 276-G(2) (1937) Sta. 505+00 6' x 2' rcb. |
| Section, Township, Range: | Between Sec. 28 & 21, T-16-N, R-11-W |
| Description of Location: | 0.3' below centerline of Hwy. at str. |
| Highwater Elevation: | 1535.78 |
| Level Datum & Source: | NAVD88 from NGS OPUS solution |
| Method used: | RTK |
| Date Elevation Obtained: | 8/21/2007 |
| Apparent Magnitude: | Normal <input type="checkbox"/> Medium <input type="checkbox"/> Extreme <input checked="" type="checkbox"/> Don't Know <input type="checkbox"/> |
| Was Highwater Mark obtained from actual water, drift, local resident, or other source? | drift |
| Explanatory Remarks: | After 10" rain overnight. |

Note: Show Vicinity Map on back of form

Name (signature) Daisy Williams
Name (Printed) Daisy Williams
Date: August 30, 2007

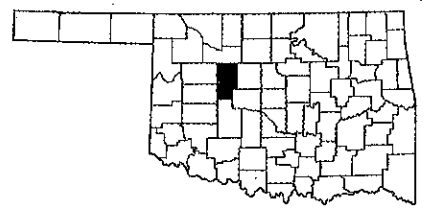
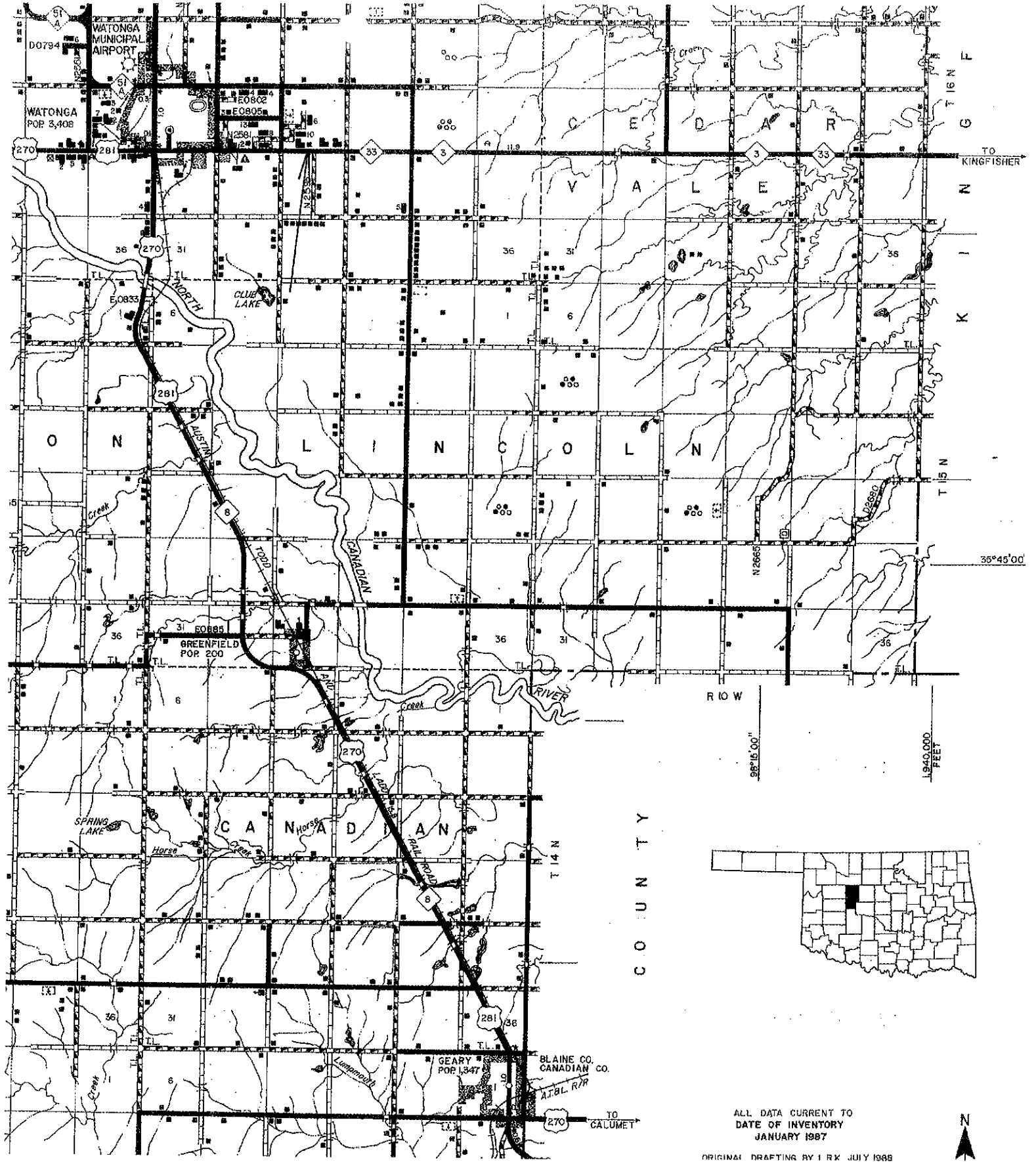

ALL DATA CURRENT TO
DATE OF INVENTORY
JANUARY 1987

ORIGINAL DRAFTING BY I R K JULY 1988

