



OKLAHOMA DEPARTMENT OF TRANSPORTATION  
SURVEY DIVISION

FLOOD INFORMATION FORM

Division #:	1 <input type="checkbox"/> 2 <input type="checkbox"/> 3 <input type="checkbox"/> 4 <input type="checkbox"/> 5 <input checked="" type="checkbox"/> 6 <input type="checkbox"/> 7 <input type="checkbox"/> 8 <input type="checkbox"/>
County:	Blaine
Date Highwater occurred:	8/18/2007
Highway Number:	S.H. 33
Name of Stream:	
Direction and distance from nearest town, or highway junction	9.2 miles east of Jct. US281 & SH33 at Watonga. F.A.P. No. 276-F(2) (1941) Sta. 140+97.3 5' x 5' rcb.
Section, Township, Range:	Between Sec. 27 & 22, T-16-N, R-10-W
Description of Location:	1.5' above centerline of Hwy. at str.
Highwater Elevation:	1244.17
Level Datum & Source:	NAVD88 from NGS OPUS solution
Method used:	RTK
Date Elevation Obtained:	8/20/2007
Apparent Magnitude:	Normal <input type="checkbox"/> Medium <input type="checkbox"/> Extreme <input checked="" type="checkbox"/> Don't Know <input type="checkbox"/>
Was Highwater Mark obtained from actual water, drift, local resident, or other source?	drift
Explanatory Remarks:	After 10" rain overnight.

Note: Show Vicinity Map on back of form

Name (signature)

*Daryl Williams*

Name (Printed)

Daryl Williams

Date:

August 30, 2007

Survey Division

Form No. 16

Revised: 5/09/2007

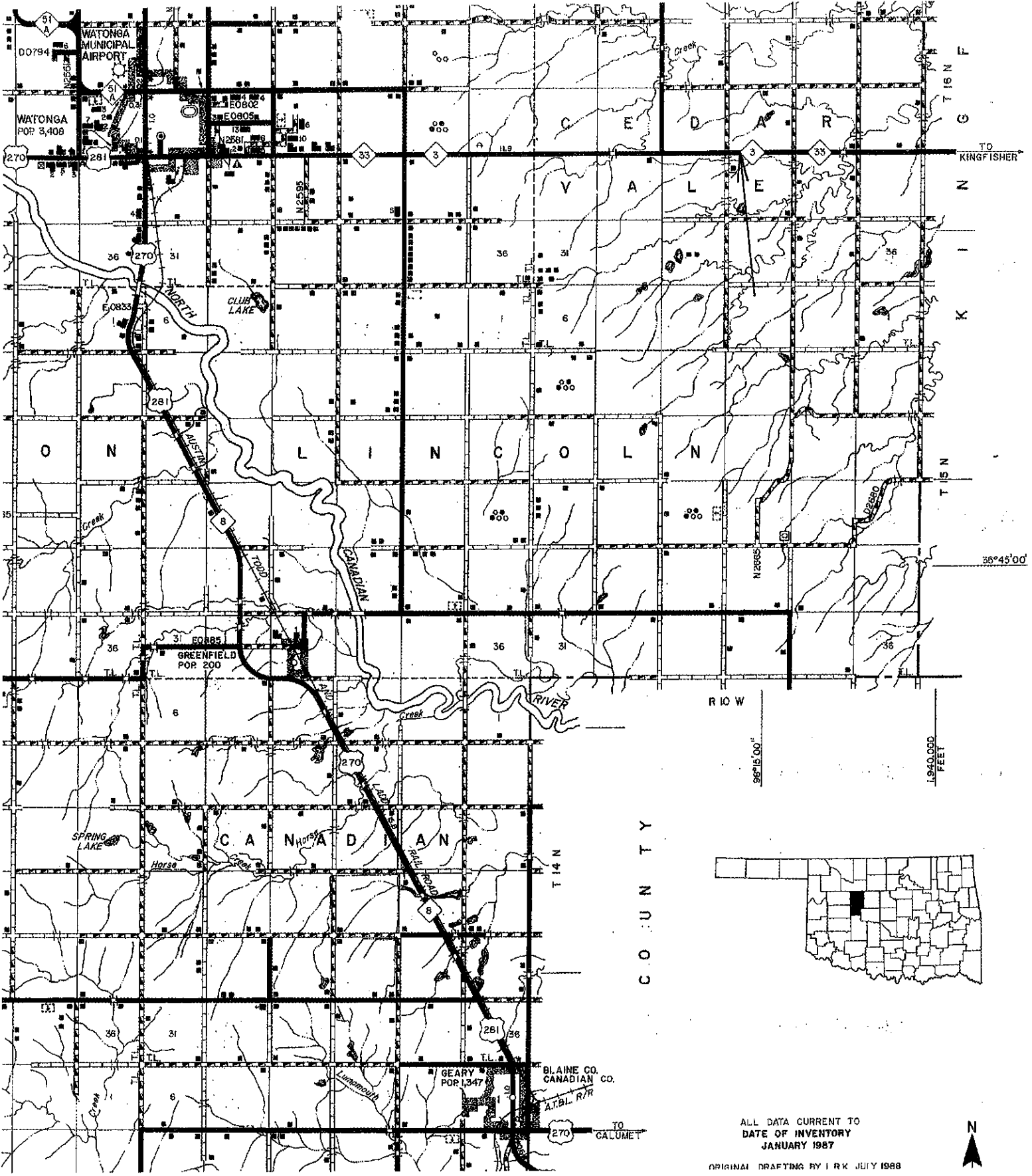

R 10 W

1:940,000 FEET

1:940,000 FEET

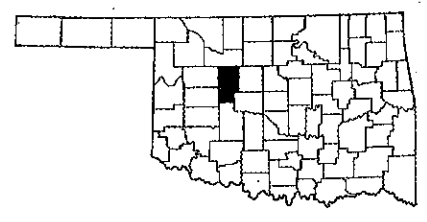

C O U N T Y

ALL DATA CURRENT TO  
DATE OF INVENTORY  
JANUARY 1987

ORIGINAL DRAFTING BY I R K JULY 1988

