

OKLAHOMA DEPARTMENT OF TRANSPORTATION  
SURVEY DIVISION

FLOOD INFORMATION FORM

Division #:	1 <input type="checkbox"/> 2 <input type="checkbox"/> 3 <input type="checkbox"/> 4 <input type="checkbox"/> 5 <input checked="" type="checkbox"/> 6 <input type="checkbox"/> 7 <input type="checkbox"/> 8 <input type="checkbox"/>
County:	Blaine
Date Highwater occurred:	8/18/2007
Highway Number:	U.S 281
Name of Stream:	
Direction and distance from nearest town, or highway junction	4.0 miles south of Jct. US281 & SH33 at Watonga. Sta. 684+06.4 3 - 10' x 4' rcb
Section, Township, Range:	Between Sec. 7, T-15-N, R-11-W
Description of Location:	1.5' above west headwall
Highwater Elevation:	1476.66
Level Datum & Source:	USC&GS from SWO2767(2) Survey.
Method used:	Level
Date Elevation Obtained:	8/21/2007
Apparent Magnitude:	Normal <input type="checkbox"/> Medium <input type="checkbox"/> Extreme <input checked="" type="checkbox"/> Don't Know <input type="checkbox"/>
Was Highwater Mark obtained from actual water, drift, local resident, or other source?	drift
Explanatory Remarks:	After 10" overnight rain.

Note: Show Vicinity Map on back of form

Name (signature) Daryl Williams  
Name (Printed) Daryl Williams  
Date: August 30, 2007

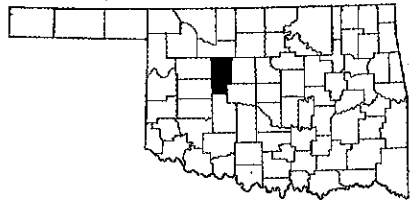
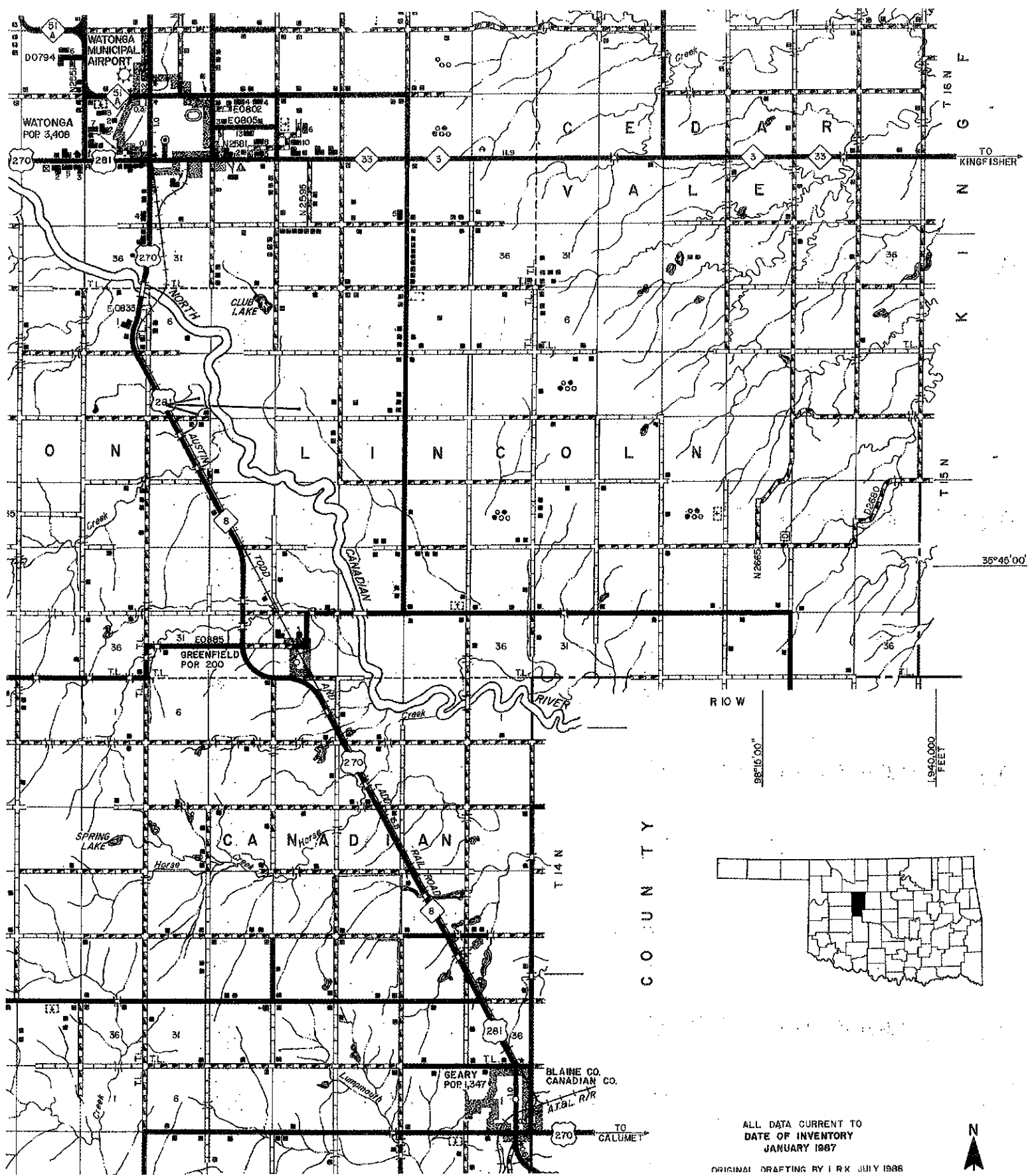

ALL DATA CURRENT TO  
DATE OF INVENTORY  
JANUARY 1987  
ORIGINAL DRAFTING BY I R K JULY 1986

