



**OKLAHOMA DEPARTMENT OF TRANSPORTATION
SURVEY DIVISION**

FLOOD INFORMATION FORM

Division #:	1 <input type="checkbox"/> 2 <input type="checkbox"/> 3 <input type="checkbox"/> 4 <input type="checkbox"/> 5 <input checked="" type="checkbox"/> 6 <input type="checkbox"/> 7 <input type="checkbox"/> 8 <input type="checkbox"/>
County:	Blaine
Date Highwater occurred:	8/18/2007
Highway Number:	U.S 281
Name of Stream:	
Direction and distance from nearest town, or highway junction	5.8 miles south of Jct. US281 & SH33 at Watonga. Metric Sta. 17+800 0.45 RCP
Section, Township, Range:	Sec. 20, T-15-N, R-11-W
Description of Location:	0.1' above centerline of road at str.
Highwater Elevation:	1476.01'
Level Datum & Source:	FAP No. NHY-010N(016)
Method used:	Level
Date Elevation Obtained:	8/22/2007
Apparent Magnitude:	Normal <input type="checkbox"/> Medium <input type="checkbox"/> Extreme <input checked="" type="checkbox"/> Don't Know <input type="checkbox"/>
Was Highwater Mark obtained from actual water, drift, local resident, or other source?	drift
Explanatory Remarks:	After 10" overnight rain.

Note: Show Vicinity Map on back of form

Name (signature) Daryl Williams
Name (Printed) Daryl Williams
Date: August 30, 2007

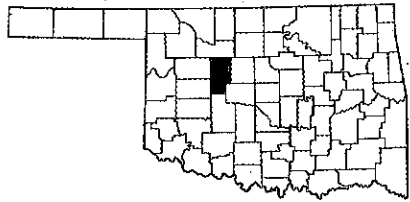
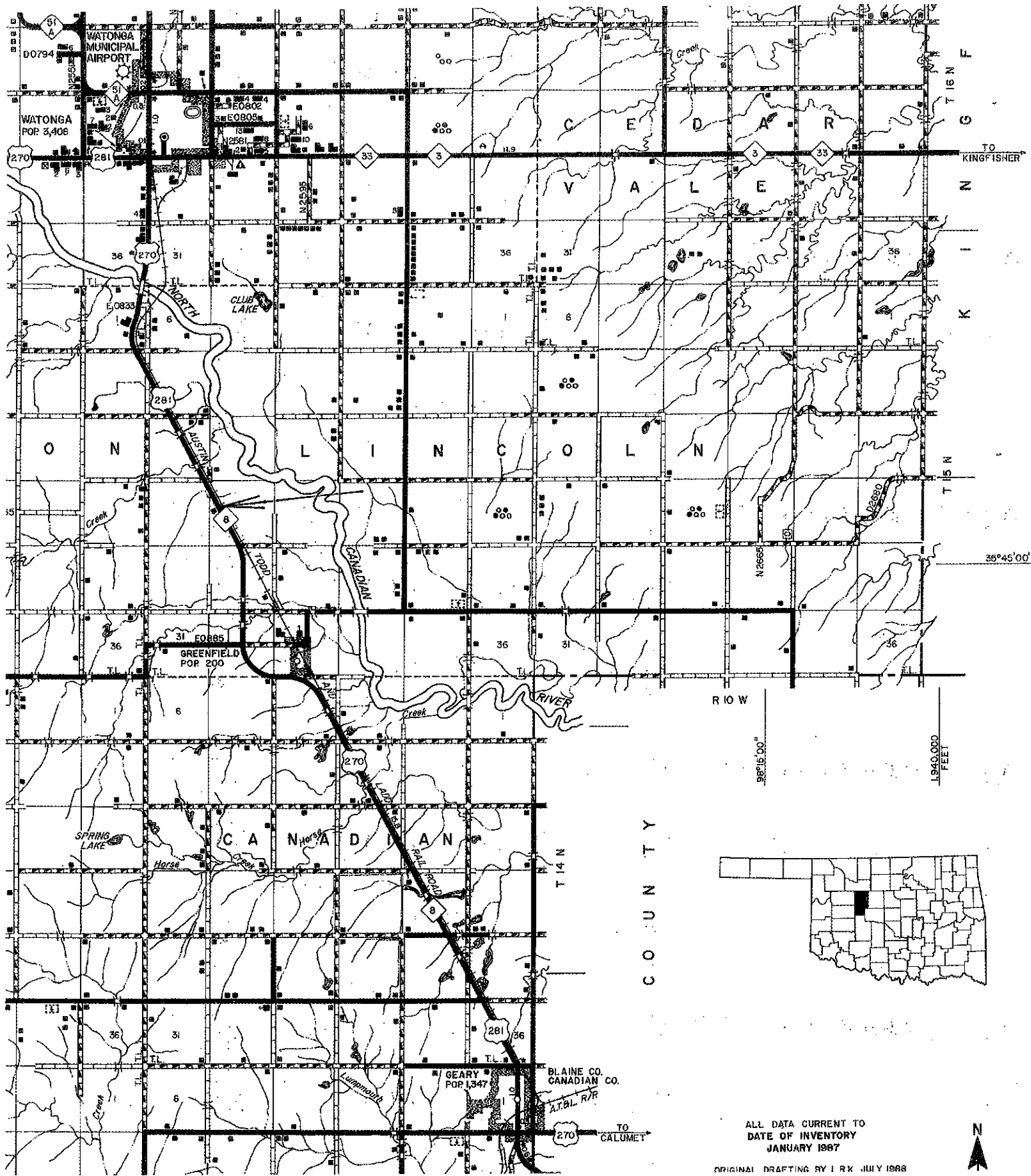

ALL DATA CURRENT TO
DATE OF INVENTORY
JANUARY 1987

ORIGINAL DRAFTING BY I R X JULY 1988

