

OKLAHOMA DEPARTMENT OF TRANSPORTATION  
SURVEY DIVISION

FLOOD INFORMATION FORM

Division #:	1 <input type="checkbox"/> 2 <input type="checkbox"/> 3 <input type="checkbox"/> 4 <input type="checkbox"/> 5 <input checked="" type="checkbox"/> 6 <input type="checkbox"/> 7 <input type="checkbox"/> 8 <input type="checkbox"/>
County:	Blaine
Date Highwater occurred:	8/18/2007
Highway Number:	U.S 281
Name of Stream:	
Direction and distance from nearest town, or highway junction	8.55 miles south of Jct. US281 & SH33 at Watonga. Metric Sta. 13+255 2-1.8x1.2 RCB
Section, Township, Range:	Between Sec. 4, T-14-N, R-11-W & Sec. 33, T-15-N, R-11-W
Description of Location:	2.2' above the centerline of North lane at Str.
Highwater Elevation:	1493.85'
Level Datum & Source:	FAP No. NHY-010N(016)
Method used:	Level
Date Elevation Obtained:	8/22/2007
Apparent Magnitude:	Normal <input type="checkbox"/> Medium <input type="checkbox"/> Extreme <input checked="" type="checkbox"/> Don't Know <input type="checkbox"/>
Was Highwater Mark obtained from actual water, drift, local resident, or other source?	drift
Explanatory Remarks:	After 10" overnight rain.

Note: Show Vicinity Map on back of form

Name (signature)

*Daryl Williams*

Name (Printed)

Daryl Williams

Date:

August 30, 2007

Survey Division

Form No. 16

Revised: 5/09/2007

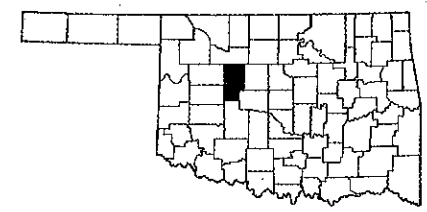
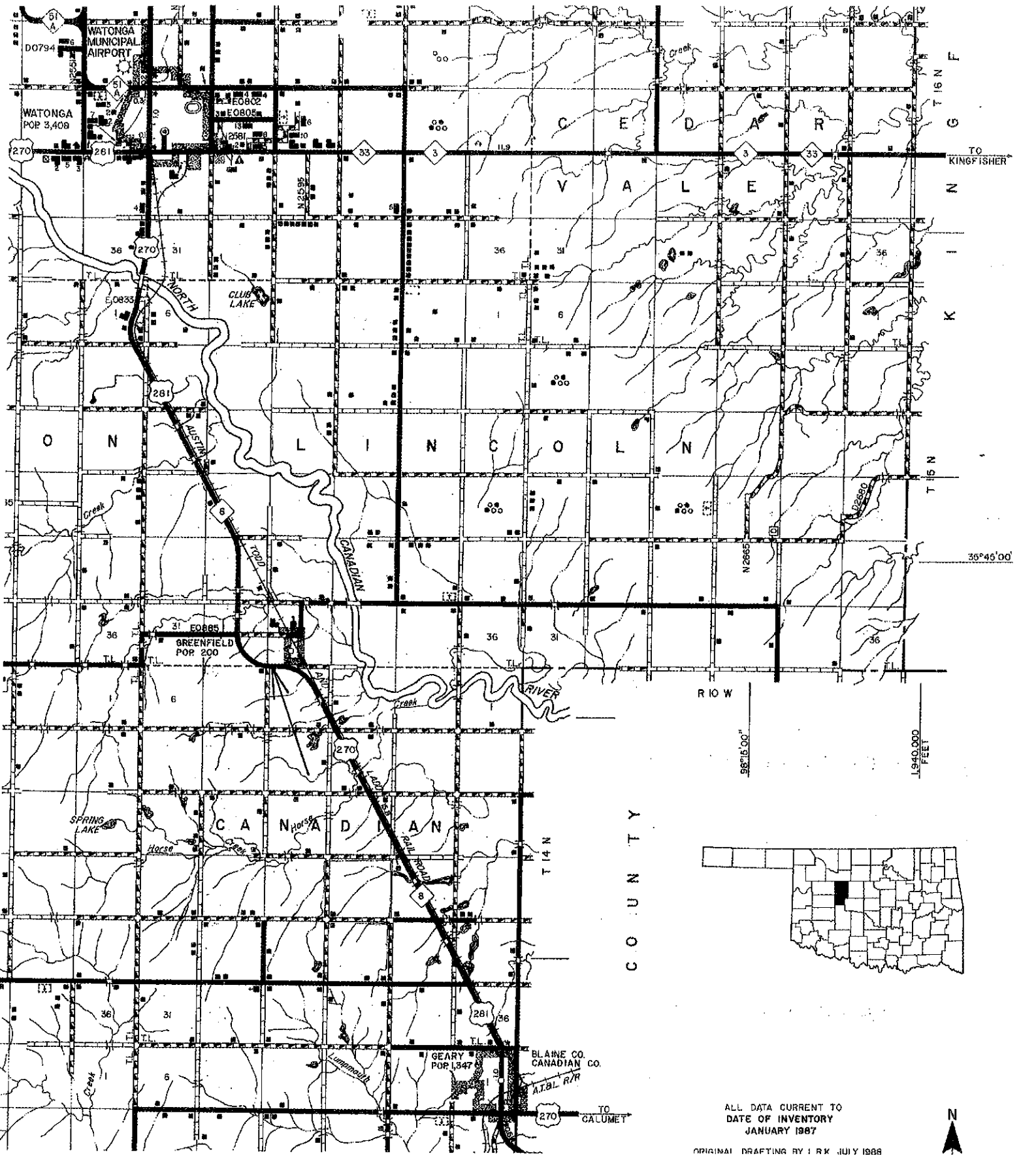

ALL DATA CURRENT TO  
DATE OF INVENTORY  
JANUARY 1987

ORIGINAL DRAFTING BY I RK JULY 1988

