



OKLAHOMA DEPARTMENT OF TRANSPORTATION
SURVEY DIVISION

FLOOD INFORMATION FORM

Division #:	1 <input type="checkbox"/> 2 <input type="checkbox"/> 3 <input type="checkbox"/> 4 <input type="checkbox"/> 5 <input checked="" type="checkbox"/> 6 <input type="checkbox"/> 7 <input type="checkbox"/> 8 <input type="checkbox"/>
County:	Blaine
Date Highwater occurred:	8/18/2007
Highway Number:	U.S 281
Name of Stream:	
Direction and distance from nearest town, or highway junction	9.1 miles south of Jct. US281 & SH33 at Watonga. Metric Sta. 12+287 2-2.4x1.2 RCB
Section, Township, Range:	Sec. 4, T-14-N, R-11-W
Description of Location:	2.3' above the centerline of South lane at Str.
Highwater Elevation:	1467.70'
Level Datum & Source:	FAP No. NHY-010N(016)
Method used:	Level
Date Elevation Obtained:	8/22/2007
Apparent Magnitude:	Normal <input type="checkbox"/> Medium <input type="checkbox"/> Extreme <input checked="" type="checkbox"/> Don't Know <input type="checkbox"/>
Was Highwater Mark obtained from actual water, drift, local resident, or other source?	drift
Explanatory Remarks:	After 10" overnight rain.

Note: Show Vicinity Map on back of form

Name (signature) _____

Name (Printed) _____

Date: _____

Daryl Williams

Daryl Williams

August 30, 2007

Survey Division

Form No. 16

Revised: 5/09/2007

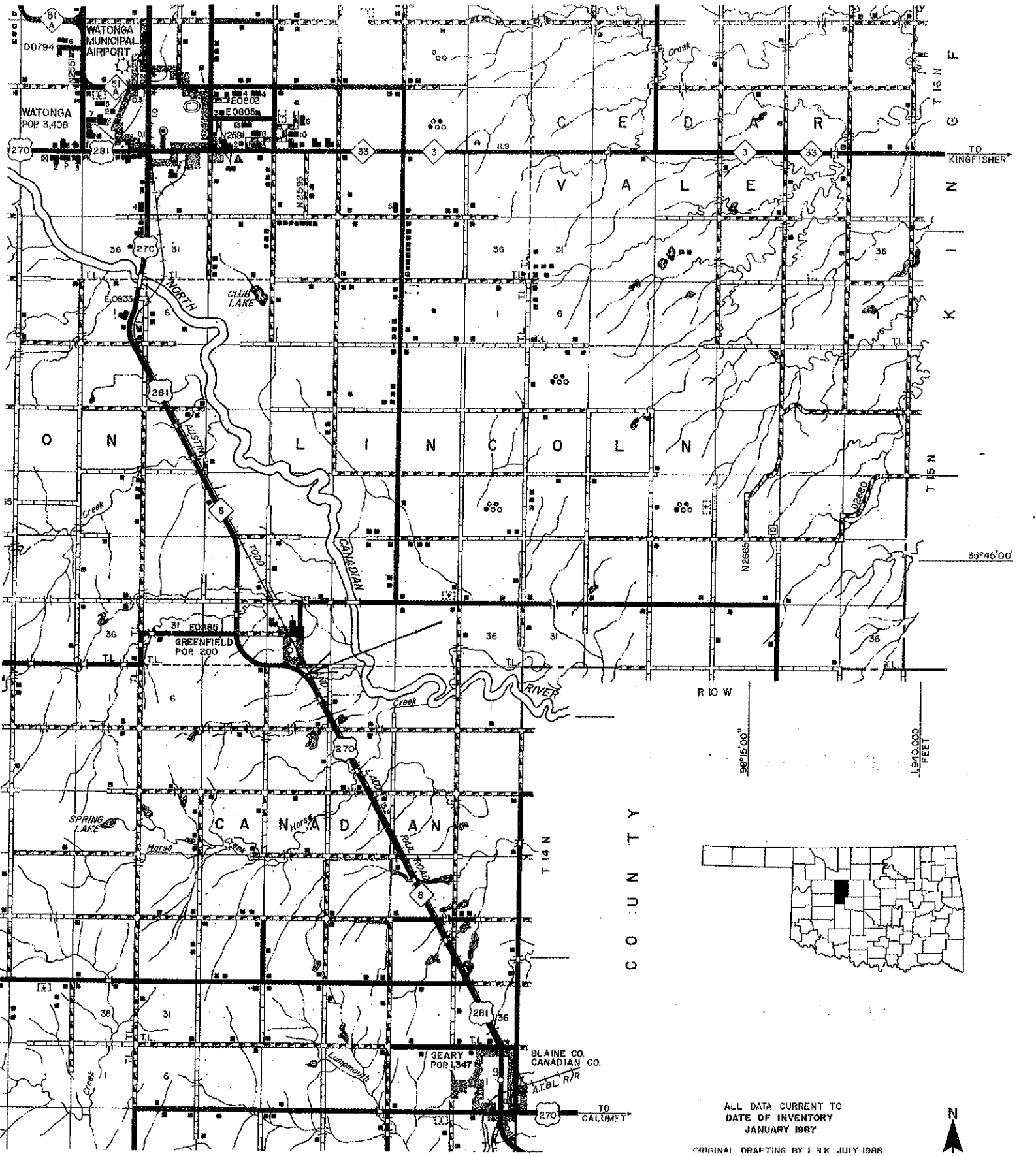

ALL DATA CURRENT TO
DATE OF INVENTORY
JANUARY 1987
ORIGINAL DRAFTING BY I R K JULY 1988

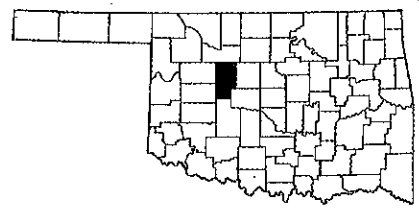

C O U N T Y

T 16 N
T 15 N
T 14 N

TO KINGFISHER

T 15 N

36°46'00"

R 10 W

98°15'00"

1:940,000
FEET

T 14 N

TO CALUMET

WATONGA
MUNICIPAL
AIRPORT
POP 3,408

CLUB LAKE

GREENFIELD
POP 200

GEARY
POP 1,347

BLAINE CO.
CANADIAN CO.

A.T. & T. R.R.

NORTH

CANADIAN
RIVER

SPRING
LAKE

CANADIAN

LUMPHAM

HORSE
CREEK

HORSE
CREEK

HORSE
CREEK

HORSE
CREEK

HORSE
CREEK

HORSE
CREEK

HORSE
CREEK

HORSE
CREEK

HORSE
CREEK

HORSE
CREEK

HORSE
CREEK

HORSE
CREEK

HORSE
CREEK

HORSE
CREEK

HORSE
CREEK

HORSE
CREEK

HORSE
CREEK

HORSE
CREEK

HORSE
CREEK