

**OKLAHOMA DEPARTMENT OF TRANSPORTATION  
SURVEY DIVISION**

**FLOOD INFORMATION FORM**

<b>Division #:</b>	1 <input type="checkbox"/> 2 <input type="checkbox"/> 3 <input type="checkbox"/> 4 <input type="checkbox"/> 5 <input checked="" type="checkbox"/> 6 <input type="checkbox"/> 7 <input type="checkbox"/> 8 <input type="checkbox"/>
<b>County:</b>	Blaine
<b>Date Highwater occurred:</b>	8/18/2007
<b>Highway Number:</b>	U.S 281
<b>Name of Stream:</b>	
<b>Direction and distance from nearest town, or highway junction</b>	12.35 miles south of Jct. US281 & SH33 at Watonga. Metric Sta. 16+920 0.6 RCP
<b>Section, Township, Range:</b>	Sec. 23, T-14-N, R-11-W
<b>Description of Location:</b>	0.6' above centerline of West lane at Str.
<b>Highwater Elevation:</b>	1464.85'
<b>Level Datum &amp; Source:</b>	FAP No. NHY-10N(005)
<b>Method used:</b>	Level
<b>Date Elevation Obtained:</b>	8/23/2007
<b>Apparent Magnitude:</b>	Normal <input type="checkbox"/> Medium <input type="checkbox"/> Extreme <input checked="" type="checkbox"/> Don't Know <input type="checkbox"/>
<b>Was Highwater Mark obtained from actual water, drift, local resident, or other source?</b>	drift
<b>Explanatory Remarks:</b>	After 10" overnight rain.

Note: Show Vicinity Map on back of form

Name (signature)

Name (Printed)

Date:

*Daryl Williams*

Daryl Williams

August 30, 2007

Survey Division

Form No. 16

Revised: 5/09/2007

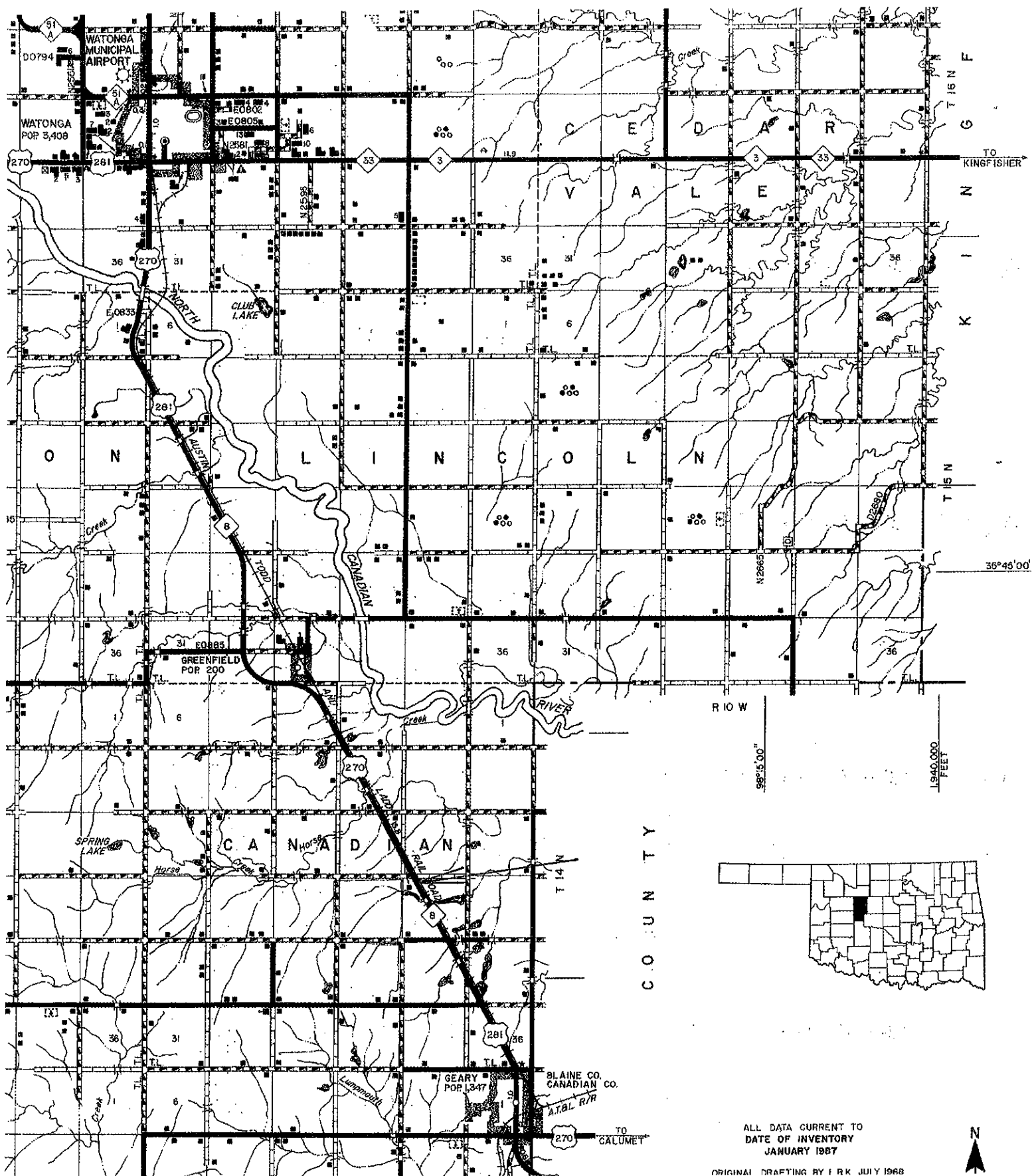

ALL DATA CURRENT TO  
DATE OF INVENTORY  
JANUARY 1987  
ORIGINAL DRAFTING BY I R K JULY 1968