



OKLAHOMA DEPARTMENT OF TRANSPORTATION  
SURVEY DIVISION

FLOOD INFORMATION FORM

|  |  |
|--|--|
| Division #:  | 1 <input type="checkbox"/> 2 <input type="checkbox"/> 3 <input type="checkbox"/> 4 <input type="checkbox"/> 5 <input checked="" type="checkbox"/> 6 <input type="checkbox"/> 7 <input type="checkbox"/> 8 <input type="checkbox"/> |
| County:  | Blaine   |
| Date Highwater occurred:   | 8/18/2007  |
| Highway Number:  | U.S 281  |
| Name of Stream:  |  |
| Direction and distance from nearest town, or highway junction                          | 12.9 miles south of Jct. US281 & SH33 at Watonga.<br>Metric Sta. 16+060 0.6 RCP  |
| Section, Township, Range:  | Sec. 23, T-14-N, R-11-W  |
| Description of Location:   | 1.4' below centerline of West lane at Str.   |
| Highwater Elevation:   | 1463.80'   |
| Level Datum & Source:  | FAP No. NHY-10N(005)   |
| Method used:   | Level  |
| Date Elevation Obtained:   | 8/23/2007  |
| Apparent Magnitude:  | Normal <input type="checkbox"/> Medium <input type="checkbox"/> Extreme <input checked="" type="checkbox"/> Don't Know <input type="checkbox"/>  |
| Was Highwater Mark obtained from actual water, drift, local resident, or other source? | drift  |
| Explanatory Remarks:   | After 10" overnight rain.  |

Note: Show Vicinity Map on back of form

Name (signature)

*Daryl Williams*

Name (Printed)

Daryl Williams

Date:

August 30, 2007

Survey Division

Form No. 16

Revised: 5/09/2007

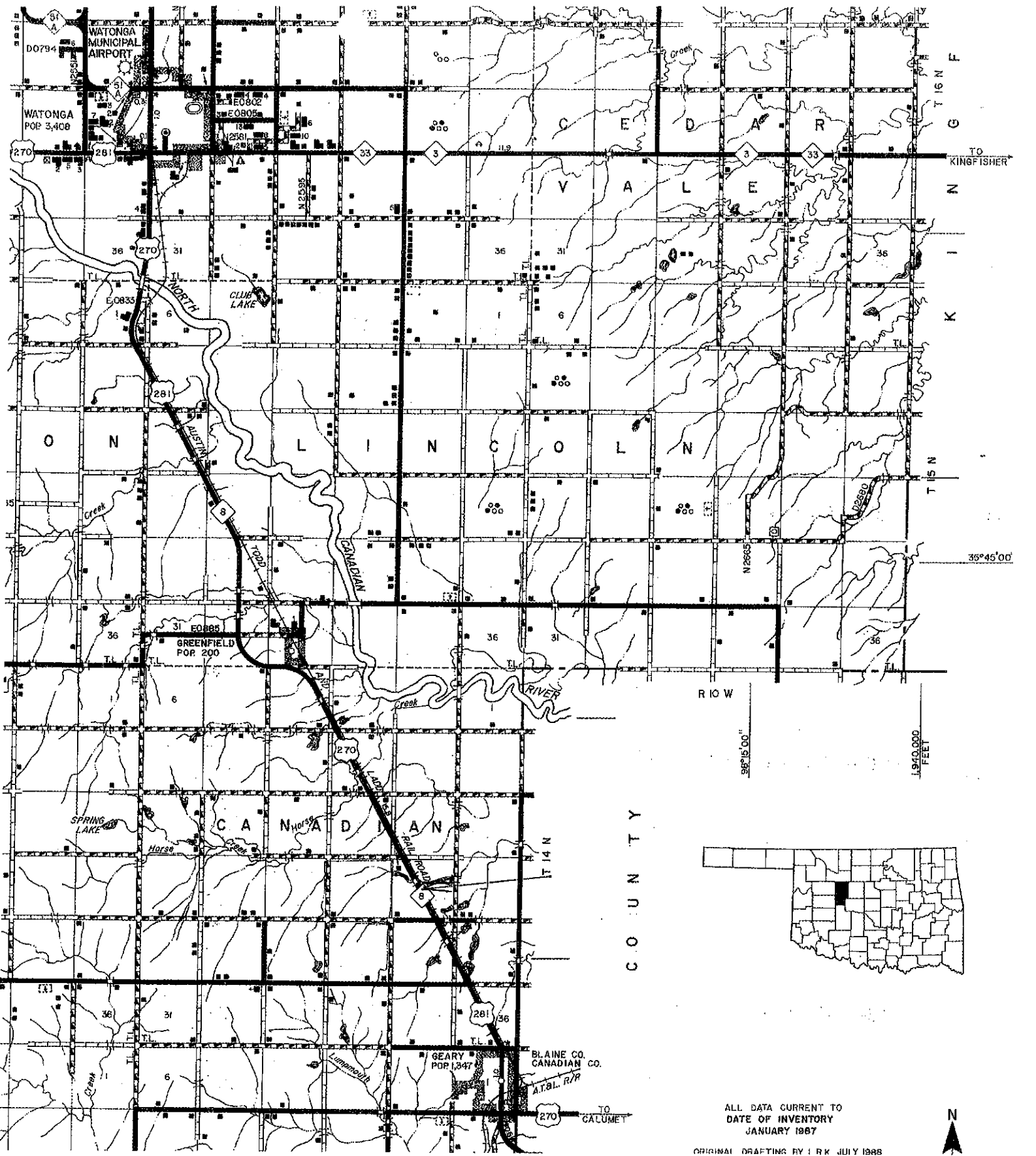

ALL DATA CURRENT TO  
 DATE OF INVENTORY  
 JANUARY 1987  
 ORIGINAL DRAFTING BY I R K JULY 1988

