

**OKLAHOMA DEPARTMENT OF TRANSPORTATION
SURVEY DIVISION**

FLOOD INFORMATION FORM

Division #:	1 <input type="checkbox"/> 2 <input type="checkbox"/> 3 <input type="checkbox"/> 4 <input type="checkbox"/> 5 <input checked="" type="checkbox"/> 6 <input type="checkbox"/> 7 <input type="checkbox"/> 8 <input type="checkbox"/>
County:	Blaine
Date Highwater occurred:	8/18/2007
Highway Number:	U.S 281
Name of Stream:	
Direction and distance from nearest town, or highway junction	15.6 miles south of Jct. US281 & SH33 at Watonga. (EW-95 North edge of Geary, Okla.) Metric Sta. 11+621.52 2-2.4x0.9 RCB
Section, Township, Range:	Sec. 36, T-14-N, R-11-W
Description of Location:	1.63' below centerline of West lane at Str.
Highwater Elevation:	1503.11'
Level Datum & Source:	FAP No. NHY-10N(005)
Method used:	Level
Date Elevation Obtained:	8/23/2007
Apparent Magnitude:	Normal <input type="checkbox"/> Medium <input type="checkbox"/> Extreme <input checked="" type="checkbox"/> Don't Know <input type="checkbox"/>
Was Highwater Mark obtained from actual water, drift, local resident, or other source?	drift
Explanatory Remarks:	After 10" overnight rain.

Note: Show Vicinity Map on back of form

Name (signature) *Daryl Williams*
 Name (Printed) Daryl Williams
 Date: August 30, 2007

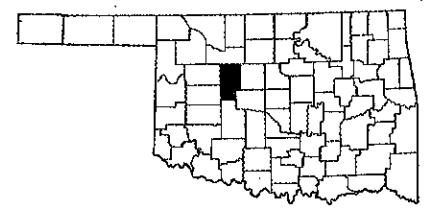
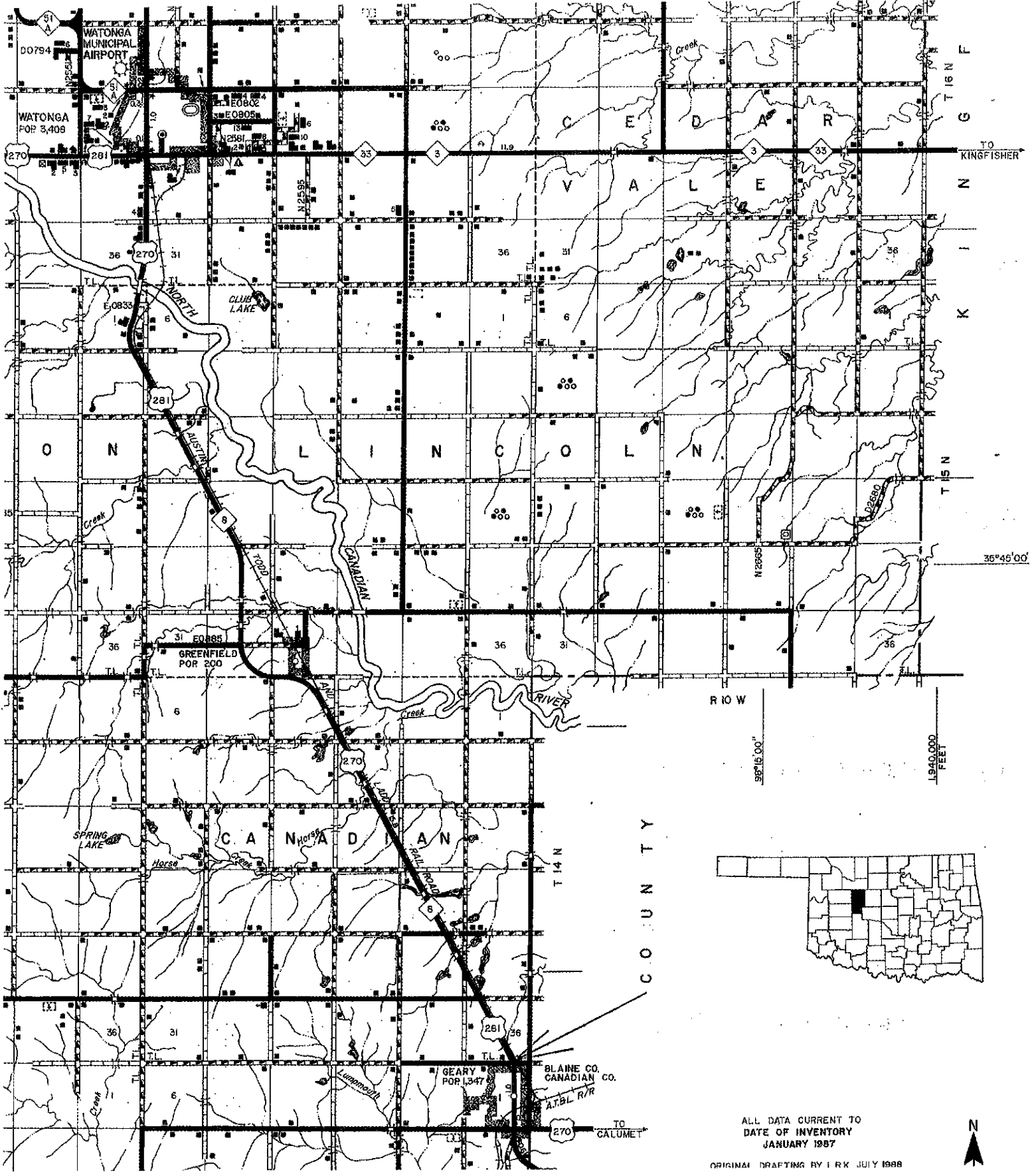

ALL DATA CURRENT TO
DATE OF INVENTORY
JANUARY 1987

ORIGINAL DRAFTING BY I R K JULY 1988

