

STATE OF OKLAHOMA
DEPARTMENT OF HIGHWAYS
SURVEY DIVISION

FLOOD INFORMATION FORM

To be used in obtaining and transmitting flood water elevations for Survey Division office record files. This information to be obtained by all Chiefs of Party or others in their vicinity in times of unusual high water, or at any time available from a reliable source. The elevations can be recorded by level reading, by measurement from bridge floor, in relation to a house, above roadbed or any other dependable, clear manner that fits the situation, the highest order possible to be used. Separate report to be made on each crossing or place obtained.

County BLAINE Date highwater occurred OCTOBER 4, 1986

Highway number U.S. 281 Name of stream NORTH CANADIAN RIVER

Direction and distance from nearest town, village or store _____

2.0 MILES SOUTH OF WATONGA ON U.S. 281

Section, Township and Range S.W. CORNER SECTION 31, T-11-N, R-11-W

Description of Location 13.5' BELOW O.H.D. BRASS MONUMENT NO. B-6-28(1970) SET IN

S.W. PARAPET WALL - ELEVATION 1486.46.

Elevation 1473.0 Source of levels F.A.P. NO. F-170-(4)-U.S. 270 PLANS U.S.C.&G.S.

Method obtained LEVEL ROD Date obtained OCTOBER 6, 1986

Did it appear to be normal medium extreme do not know

Was highwater mark obtained from actual water, drift, local resident, U. S. Engineers, etc.? DRIFT AND WATER MARK

Explanatory Remarks OCCURED BECAUSE OF DAILY RAINS FOR 5 DAYS STRAIGHT.

TOTAL OF 10" OF RAIN.

Location to be shown on back of this sheet as a check.

Field Note: To be sent to
Survey Engineer

Bruce A. Lefgrenell
TRANS. SPECIALIST 11th

OCTOBER 8, 1986

Date

LOCATION No. 7

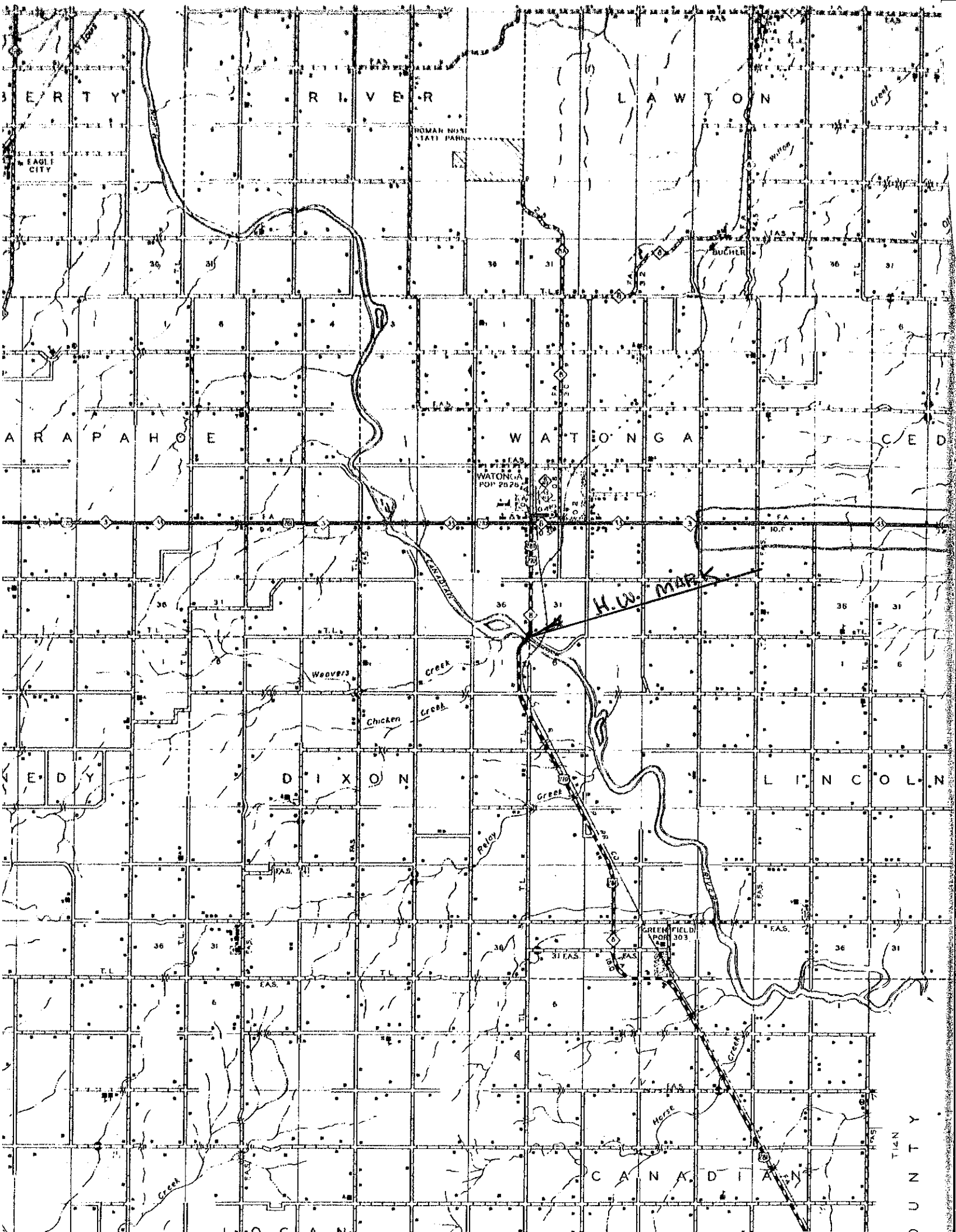

BERTY

RIVER

LAWTON

ARAPAHOE

WATONGA

CED

E D Y

DIXON

LINCOLN

H.W. MARK

CANADIAN

T.14 N.

R.10 W.

EAGLE CITY

ROMAN MON. STATE PARK

BUCHER

WATONGA POP. 2020

GREENFIELD POP. 303

Weavers Creek

Chicken Creek

Rego Creek

Horse Creek

Creek

30

31

30

31

36

31

36

31

36

31

36

31

36

31

30

31

36

31