

STATE OF OKLAHOMA
DEPARTMENT OF HIGHWAYS
SURVEY DIVISION

FLOOD INFORMATION FORM

To be used in obtaining and transmitting flood water elevations for Survey Division office record files. This information to be obtained by all Chiefs of Party or others in their vicinity in times of unusual high water, or at any time available from a reliable source. The elevations can be recorded by level reading, by measurement from bridge floor, in relation to a house, above roadbed or any other dependable, clear manner that fits the situation, the highest order possible to be used. Separate report to be made on each crossing or place obtained.

County BLAINE Date highwater occurred MAY 9, 1993

Highway number U.S. 281 Name of stream DRAIN

Direction and distance from nearest town, village or store 2.9 MILES NORTH OF GEARY, OKLAHOMA ALONG U.S. 281

Section, Township and Range SECTION 14, T-14-N, R-11-W

Description of Location DRIFT 0.2 ABOVE BRIDGE SEAT

Elevation 1461.0 Source of levels F.A.P. NO. 170 ABC S.H. 8 1930 PLANS

Method obtained HAND GUN Date obtained MAY 10, 1993

Did it appear to be normal medium extreme do not know

Was highwater mark obtained from actual water, drift, local resident, U. S. Engineers, etc.? DRIFT BETWEEN BRIDGE SEAT & STRINGERS

Explanatory Remarks 6" RAIN IN A 2 DAY PERIOD

Location to be shown on back of this sheet as a check.

Field Note: To be sent to
Survey Engineer

G. D. Stratton
PROFESSIONAL LAND SURVEYOR

Date
MAY 14 1993

COPY TO BRIDGE

LOCATION No. 8

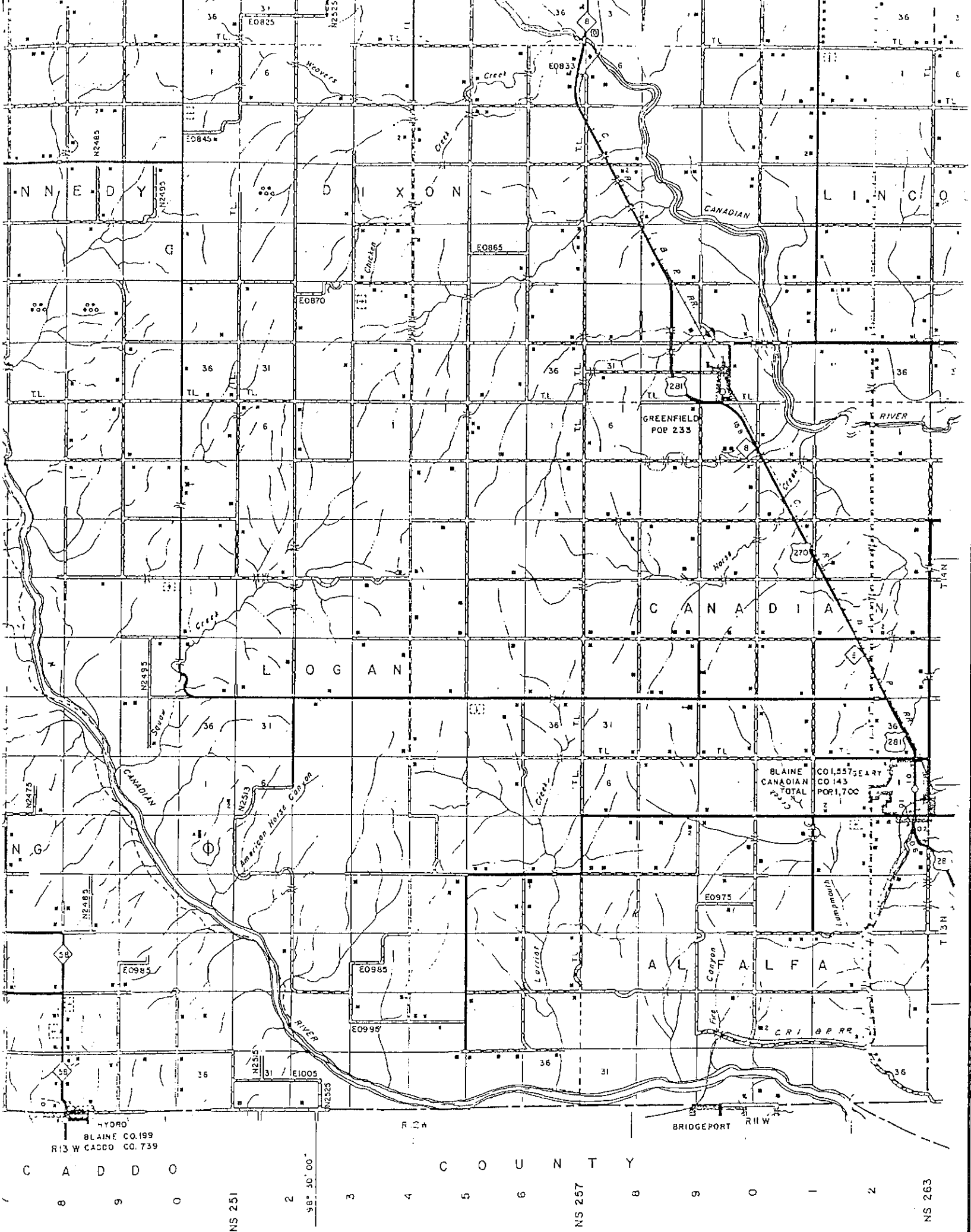

GREENFIELD
POP 233

BLAINE
CANADIAN
TOTAL
CO. 157, SEARY
CO. 143
POP. 1,700

HYDRO
BLAINE CO. 199
R13 W CACCO CO. 739

C A D D O

C O U N T Y

NS 251

NS 257

NS 263

98° 30' 00"