

STATE OF OKLAHOMA
DEPARTMENT OF HIGHWAYS
SURVEY DIVISION

FLOOD INFORMATION FORM

To be used in obtaining and transmitting flood water elevations for Survey Division office record files. This information to be obtained by all Chiefs of Party or others in their vicinity in times of unusual high water, or at any time available from a reliable source. The elevations can be recorded by level reading, by measurement from bridge floor, in relation to a house, above roadbed or any other dependable, clear manner that fits the situation, the highest order possible to be used. Separate report to be made on each crossing or place obtained.

County BLAINE Date highwater occurred MAY 9, 1993

Highway number U.S. 281 Name of stream DRAIN

Direction and distance from nearest town, village or store 1.0 MILE SOUTH OF GREENFIELD, OKLAHOMA ALONG U.S. 281

Section, Township and Range BETWEEN SECTIONS 3 & 4 T-14-N, R-11-W

Description of Location DELINEATOR POST 200' SOUTH OF BOX 11.5 ABOVE BOX FLOW

Elevation 1469.0 Source of levels F.A.P. NO. 170 ABC S.H. 8 1930 PLANS

Method obtained HAND GUN Date obtained MAY 10, 1993

Did it appear to be normal medium extreme do not know

Was highwater mark obtained from actual water, drift, local resident, U. S. Engineers, etc.? COUNTY FOREMAN, DRIFT & H.W. MARK

Explanatory Remarks 6" RAIN IN A 2 DAY PERIOD

Location to be shown on back of this sheet as a check.

Field Note: To be sent to
Survey Engineer

G.P. Stratten
PROFESSIONAL LAND SURVEYOR

Date

MAY 14 1993
LOCATION No. 10

COPY TO BRIDGE

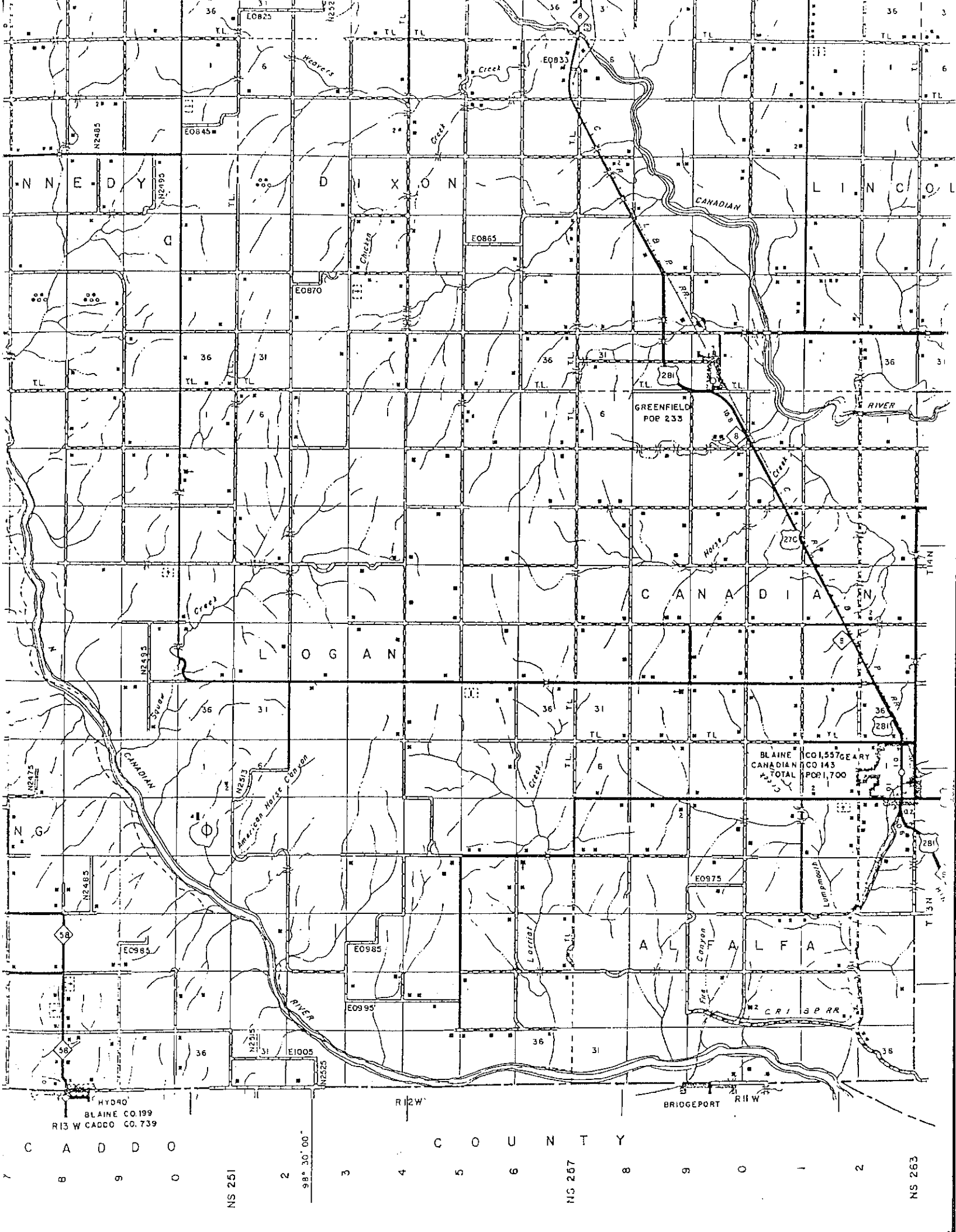

N N E D Y

D I X O N

L I N C O L N

L O G A N

C A N A D I A

A L F A

BLAINE CO. 143
CANADIAN CO. 157
TOTAL POP. 1,700

C R I S P R R

HYDRO
BLAINE CO. 199
R13 W CADDO CO. 739

NS 251

98° 30' 00"

R12W

BRIDGEPORT R11W

NS 267

NS 263

C A D D O

C O U N T Y

7 8 9 0

2

3

4

5

6

8

9

0

1

2