



**OKLAHOMA DEPARTMENT OF TRANSPORTATION  
SURVEY DIVISION**

**FLOOD INFORMATION FORM**

<b>Division #:</b>	1 <input type="checkbox"/> 2 <input type="checkbox"/> 3 <input type="checkbox"/> 4 <input type="checkbox"/> 5 <input checked="" type="checkbox"/> 6 <input type="checkbox"/> 7 <input type="checkbox"/> 8 <input type="checkbox"/>
<b>County:</b>	Blaine
<b>Date Highwater occurred:</b>	8/18/2007
<b>Highway Number:</b>	U.S 281
<b>Name of Stream:</b>	
<b>Direction and distance from nearest town, or highway junction</b>	9.85 miles south of Jct. US281 & SH33 at Watonga. Metric Sta. 11+100 bridge
<b>Section, Township, Range:</b>	Sec. 4, T-14-N, R-11-W
<b>Description of Location:</b>	0.6' below Northwest bridge seat
<b>Highwater Elevation:</b>	1467.45'
<b>Level Datum &amp; Source:</b>	FAP No. NHY-010N(016)
<b>Method used:</b>	Level
<b>Date Elevation Obtained:</b>	8/22/2007
<b>Apparent Magnitude:</b>	Normal <input type="checkbox"/> Medium <input type="checkbox"/> Extreme <input checked="" type="checkbox"/> Don't Know <input type="checkbox"/>
<b>Was Highwater Mark obtained from actual water, drift, local resident, or other source?</b>	drift
<b>Explanatory Remarks:</b>	After 10" overnight rain.

Note: Show Vicinity Map on back of form

Name (signature) Daryl Williams  
Name (Printed) Daryl Williams  
Date: August 30, 2007

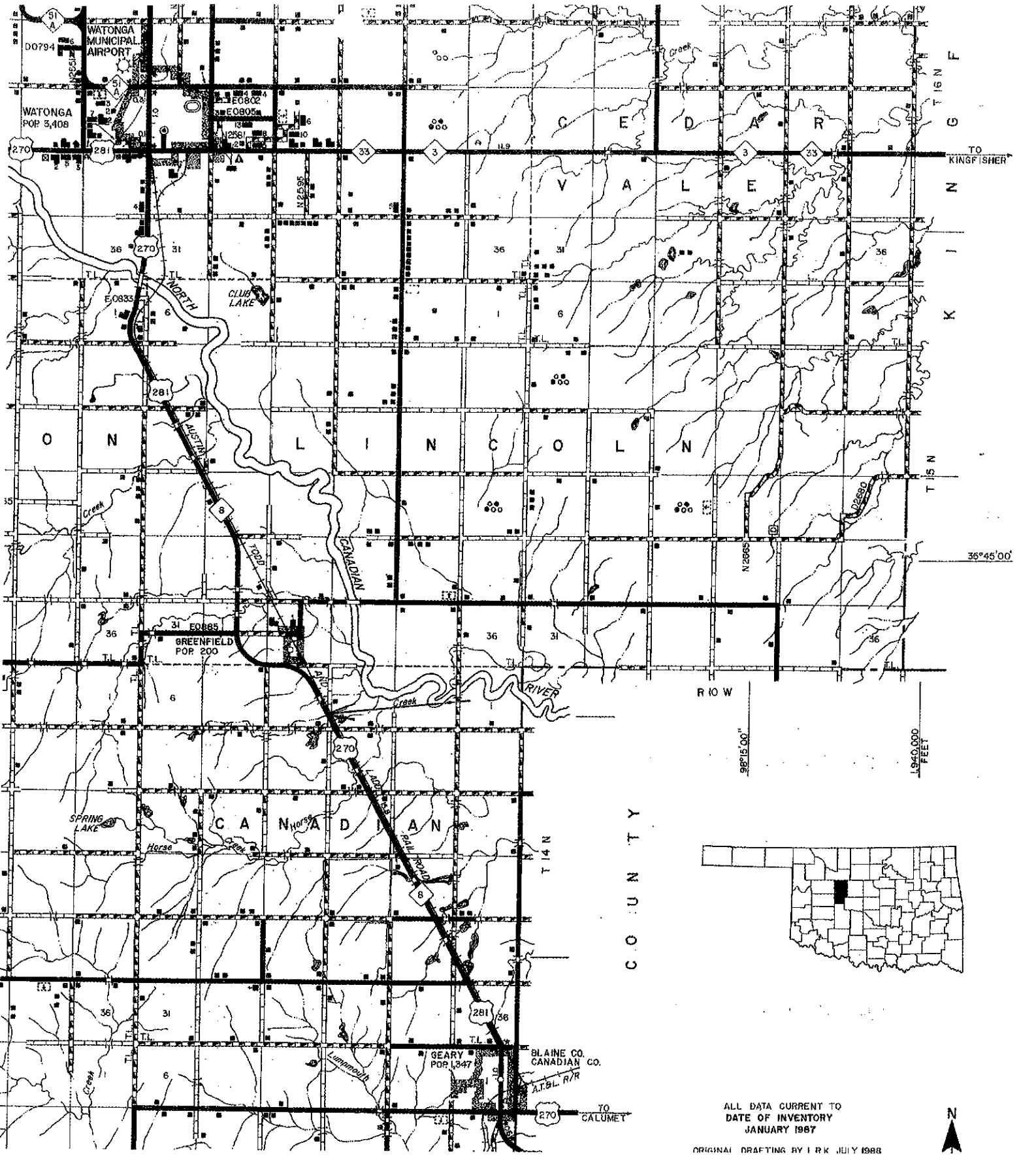

R 10 W

99° 15' 00"

1940,000 FEET

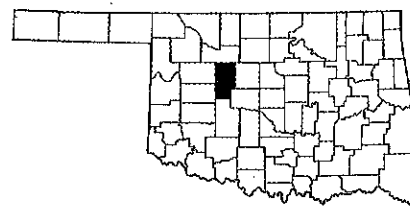

C O U N T Y

ALL DATA CURRENT TO  
DATE OF INVENTORY  
JANUARY 1987

ORIGINAL DRAFTING BY I R K JULY 1988

