

STATE OF OKLAHOMA
DEPARTMENT OF HIGHWAYS
SURVEY DIVISION

FLOOD INFORMATION FORM

To be used in obtaining and transmitting flood water elevations for Survey Division office record files. This information to be obtained by all Chiefs of Party or others in their vicinity in times of unusual high water, or at any time available from a reliable source. The elevations can be recorded by level reading, by measurement from bridge floor, in relation to a house, above roadbed or any other dependable, clear manner that fits the situation, the highest order possible to be used. Separate report to be made on each crossing or place obtained.

County BLAINE Date highwater occurred MAY 9, 1993

Highway number S.H. 51 Name of stream DRAIN

Direction and distance from nearest town, village or store 2.6 MILES WEST OF
OKEENE, OKLAHOMA ALONG S.H. 51

Section, Township and Range BETWEEN SECTIONS 15 & 22 T-19-N, R-11-W

Description of Location DRIFT & H.W. MARK 2.6 ABOVE HDWL.

Elevation 1246.6 Source of levels O.F.A.P. NO. F354 (3)(6)
S.H. 51 PLANS

Method obtained HAND GUN Date obtained MAY 11, 1993

Did it appear to be normal medium extreme do not know

Was highwater mark obtained from actual water, drift, local resident,
U. S. Engineers, etc.? DRIFT & H.W. MARK, LOCAL RESIDENT & NEARBY LAND OWNER ELMA
LAVIC

Explanatory Remarks MRS. LAVIC STATED THAT 6" RAIN IN A 2 DAY PERIOD LEFT MORE WATER
ON ROADWAY AND AREA PASTURES THAN SHE COULD REMEMBER IN OVER 50 YEARS IN THAT LOCATION

Location to be shown on back of this sheet as a check.

Field Note: To be sent to
Survey Engineer

G. B. Stratton
PROFESSIONAL LAND SURVEYOR

Date

COPY TO BRIDGE

LOCATION No. 13

MAY 14 1993

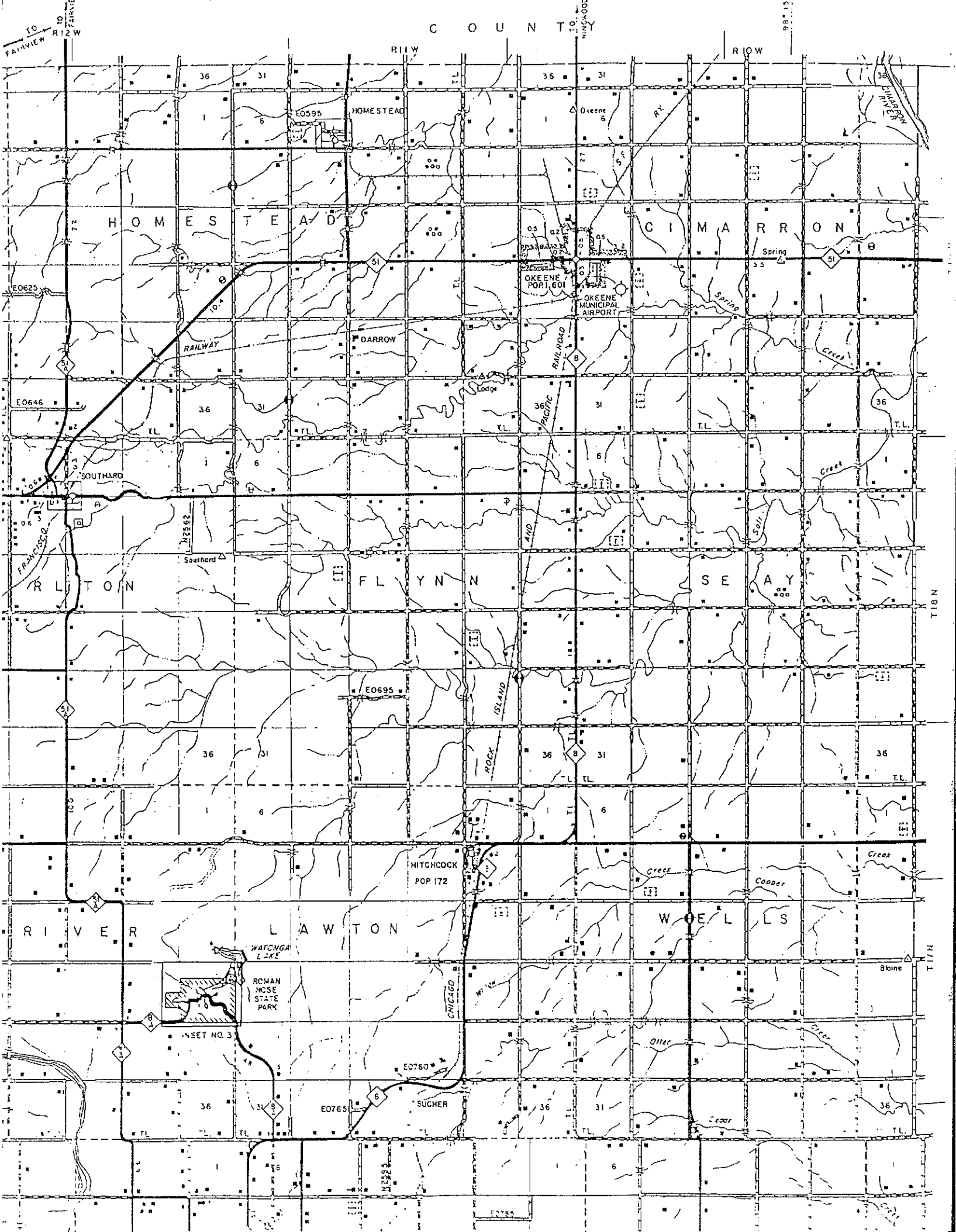

TO FAIRVIEW R12 W

R11 W

R10 W

E0625

E0595

36 31

E0646

05 02 05

SOUTHARD

DARROW

OKEENE POP. 601
OKEENE MUNICIPAL AIRPORT

R L I T O N

F L Y N N

C I M A R R O N

Spring

Spring

Southard

F L Y N N

S E A Y

E0695

ROCK ISLAND

36 31

R I V E R

L A W T O N

W O O L L Y

HITCHCOCK
POP. 172

WATCHKA LAKE

ROMAN NOSE STATE PARK

INSET NO. 3

CHICAGO

E0760

E0765

SUGHER

8line

T17N

T18N

987.15

TO FAIRVIEW R12 W