

STATE OF OKLAHOMA  
DEPARTMENT OF HIGHWAYS  
SURVEY DIVISION

FLOOD INFORMATION FORM

To be used in obtaining and transmitting flood water elevations for Survey Division office record files. This information to be obtained by all Chiefs of Party or others in their vicinity in times of unusual high water, or at any time available from a reliable source. The elevations can be recorded by level reading, by measurement from bridge floor, in relation to a house, above roadbed or any other dependable, clear manner that fits the situation, the highest order possible to be used. Separate report to be made on each crossing or place obtained.

County BLAINE Date highwater occurred MAY 9, 1993 "

Highway number U.S. 281 Name of stream DRAIN "

Direction and distance from nearest town, village or store 2.5 MILES NORTH OF GREENFIELD, OKLAHOMA ALONG U.S. 281

Section, Township and Range SECTION 28, T-15-N, R-11-W

Description of Location DRIFT ON BRIDGE 0.6 ABOVE BRIDGE SEAT

Elevation 1480.1 Source of levels F.A.P. NO. 170 ABC  
S.H. 8 1930 PLANS

Method obtained HAND GUN Date obtained MAY 10, 1993

Did it appear to be  normal  medium  extreme  do not know

Was highwater mark obtained from actual water, drift, local resident, U. S. Engineers, etc.? DRIFT & H.W. MARK & COUNTY FOREMAN

Explanatory Remarks 6" RAIN IN A 2 DAY PERIOD

Location to be shown on back of this sheet as a check.

Field Note: To be sent to  
Survey Engineer

G.D. Stratton  
PROFESSIONAL LAND SURVEYOR

Date MAY 14 1993

COPY TO BRIDGE

Location No. 14

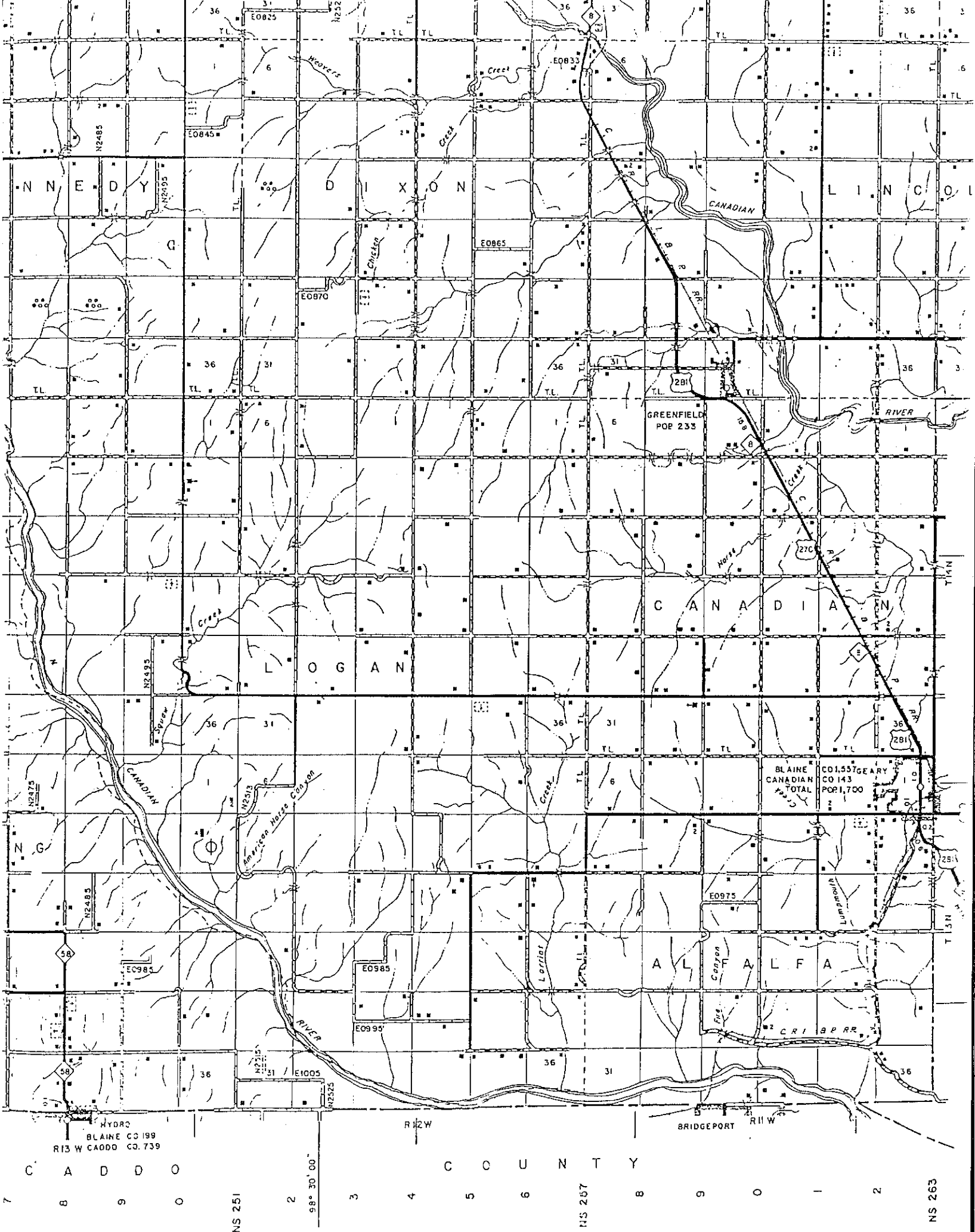

N N E D Y      D I X O N      L I N C O L N

L O G A N

C A N A D I A N

A L A L F A

BLAINE CANADIAN CO 143  
 GEARY CO 157  
 TOTAL POP 1,700

HYDRO  
 BLAINE CO 199  
 R13 W CAODD CO. 739

C A D D O      C O U N T Y

7 8 9 0 NS 251 2 3 4 5 6 NS 267 8 9 0 1 2 NS 263