

STATE OF OKLAHOMA
DEPARTMENT OF HIGHWAYS
SURVEY DIVISION

FLOOD INFORMATION FORM

To be used in obtaining and transmitting flood water elevations for Survey Division office record files. This information to be obtained by all Chiefs of Party or others in their vicinity in times of unusual high water, or at any time available from a reliable source. The elevations can be recorded by level reading, by measurement from bridge floor, in relation to a house, above roadbed or any other dependable, clear manner that fits the situation, the highest order possible to be used. Separate report to be made on each crossing or place obtained.

County BECKHAM Date highwater occurred 5-17-77

Highway number US 66 Name of stream NORTH FORK OF RED RIVER

Direction and distance from nearest town, village or store 1.0 MILES SOUTH OF JCT. OF US 66, US 283, & SH 152 ON US 66 (CARMICHAEL BRIDGE)

Section, Township and Range SECTION 9, T9N, R23W.

Description of Location SAYRE CITY PARK SIGN ADJACENT TO U.S. 66 (1 MILE SOUTH OF SAYRE).

Elevation 1798.6 Source of levels F. 213(9) PART 2 BRIDGE PLANS

Method obtained LEVEL Date obtained 5-19-77

Did it appear to be normal medium extreme do not know

Was highwater mark obtained from actual water, drift, local resident, U. S. Engineers, etc.? WATER MARK ON SIGN (SEE ATTACHED FORM AND PICTURE)

Explanatory Remarks A 3" TO 5.25" RAIN FELL OVERNIGHT ON MAY 16, 1977. AND THE EXT. H.W. ROSE TO THIS HEIGHT AT NOON MAY 18, 1977. THE SAYRE NEWS-PAPER REPORTED ON MAY 18, 1977. THAT THIS WAS APPROX. 1.5' HIGHER THAN THE PREVIOUS RECORD. SEE HIGHWATER LETTER DATED JUNE 9, 1977.

Location to be shown on back of this sheet as a check.

Field Note: To be sent to
Survey Engineer

Rewayne Walden
Location Engineer

6-2-77
Date

Location No. 5

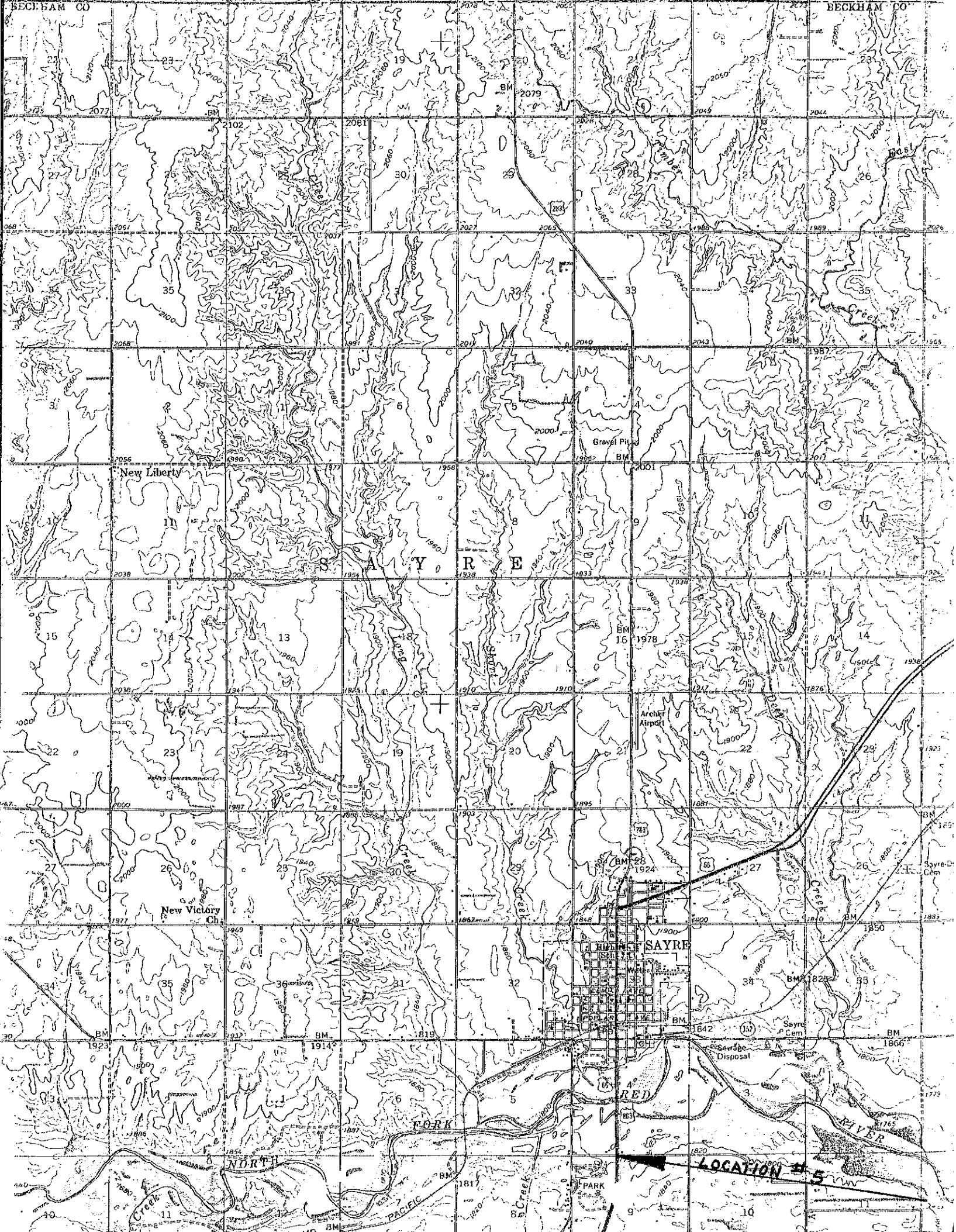

New Liberty

New Victory Ch

SAYRE

LOCATION # 5

STATE OF OKLAHOMA
DEPARTMENT OF HIGHWAYS
SURVEY DIVISION

SD Form No. 40
12-18-69

THIS FORM IS FOR IDENTIFYING, EXPLAINING
AND RECORDING INFORMATIVE PHOTOGRAPHS.

1. Location SAYRE CITY PARK ADJACENT TO U.S. 66
(1.0 MILE SOUTH OF SAYRE, OKLAHOMA)
2. Subject EXTREME HIGHWATER MARK ON NORTH FORK OF RED RIVER
3. Purpose PHOTOGRAPH DEPICTS EXTREME HIGHWATER WATER AT SAYRE CITY
PARK SIGN (EL 1798.6) LEVEL DATUM TAKEN FROM F 213(9) PART 2
BRIDGE PLANS.
4. For Use SAYRE NEWSPAPER OFFICE TOOK PHOTOGRAPH
5. History and Explanations THE PHOTOGRAPH BELOW DEPICTS EXTREME
HIGHWATER AT NOON ON MAY 17, 1977.
LEVEL DATUM FROM F 213(9) PART 2 BRIDGE PLANS

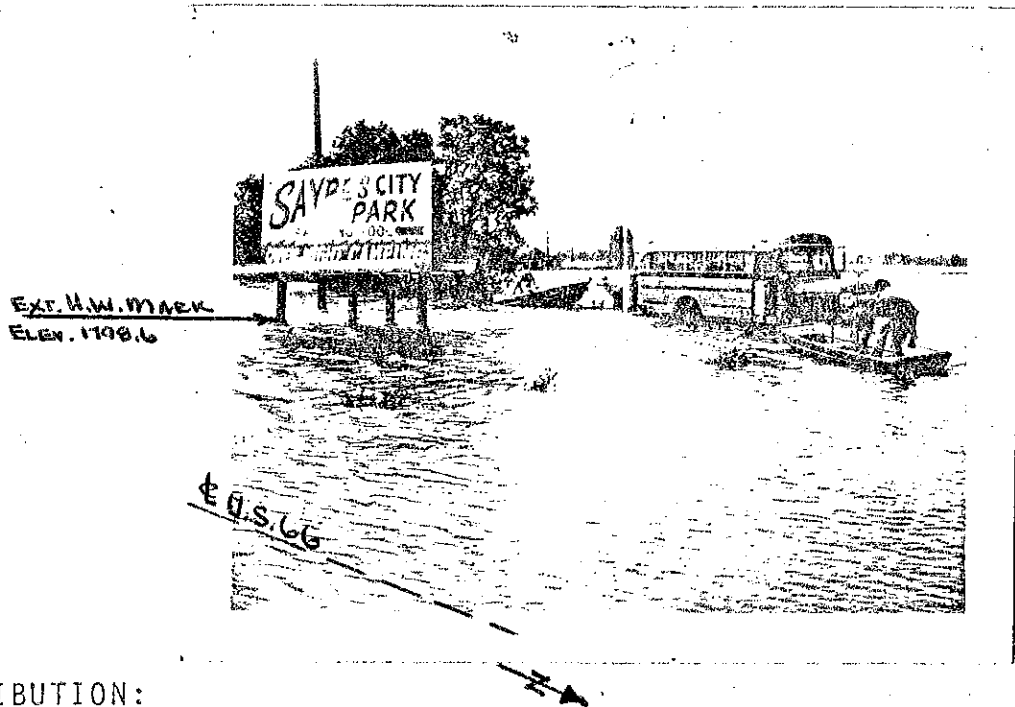

DISTRIBUTION:
Original -
Copy -

Instructions - Reduce as necessary.

D. WALDEN
Loc. ENGR.
6-2-77

Location No. 5