

STATE OF OKLAHOMA
DEPARTMENT OF HIGHWAYS
SURVEY DIVISION

FLOOD INFORMATION FORM

To be used in obtaining and transmitting flood water elevations for Survey Division office record files. This information to be obtained by all Chiefs of Party or others in their vicinity in times of unusual high water, or at any time available from a reliable source. The elevations can be recorded by level reading, by measurement from bridge floor, in relation to a house, above roadbed or any other dependable, clear manner that fits the situation, the highest order possible to be used. Separate report to be made on each crossing or place obtained.

County BECKHAM Date highwater occurred 5-17-77

Highway number SH 34 Name of stream SLOUGH BRIDGE

Direction and distance from nearest town, village or store 4.8 MILES SOUTH ON SH 34 FROM THE INTERSECTION OF SH 34 AND MAIN STREET IN CARTER, OKLA.

Section, Township and Range SECTION 22, T8N, R22W

Description of Location AT BRIDGE SEAT, AT SOUTH END OF BRIDGE

NOTE: WATER DAMAGED THIS BRIDGE TO THE EXTENT OF CLOSING HIGHWAY FOR A FEW DAYS.

Elevation 1680.2 Source of levels SAP 816-A PLANS

Method obtained LEVEL Date obtained 5-19-77

Did it appear to be normal medium extreme do not know

Was highwater mark obtained from actual water, drift, local resident, U. S. Engineers, etc.? DRIFT AND LOCAL RESIDENT

Explanatory Remarks WITNESSED BY A.D. CECIL, ROUTE #1 WILLOW, OKLA. A RESIDENT IN THIS AREA FOR OVER 40 YEARS, HE STATED THIS IS THE HIGHEST HE HAS EVER SEEN THE WATER. THIS WAS OVERFLOW WATER FROM NORTH FORK OF RED RIVER AN APPROX 3" TO 5" RAIN UPSTREAM ON MAY 16, 1977. SEE HIGHWATER LETTER DATED JUNE 9, 1977.

Location to be shown on back of this sheet as a check.

Field Note: To be sent to
Survey Engineer

Raymond Wadden
Location Engineer
6-9-77
Date

Location No. 12

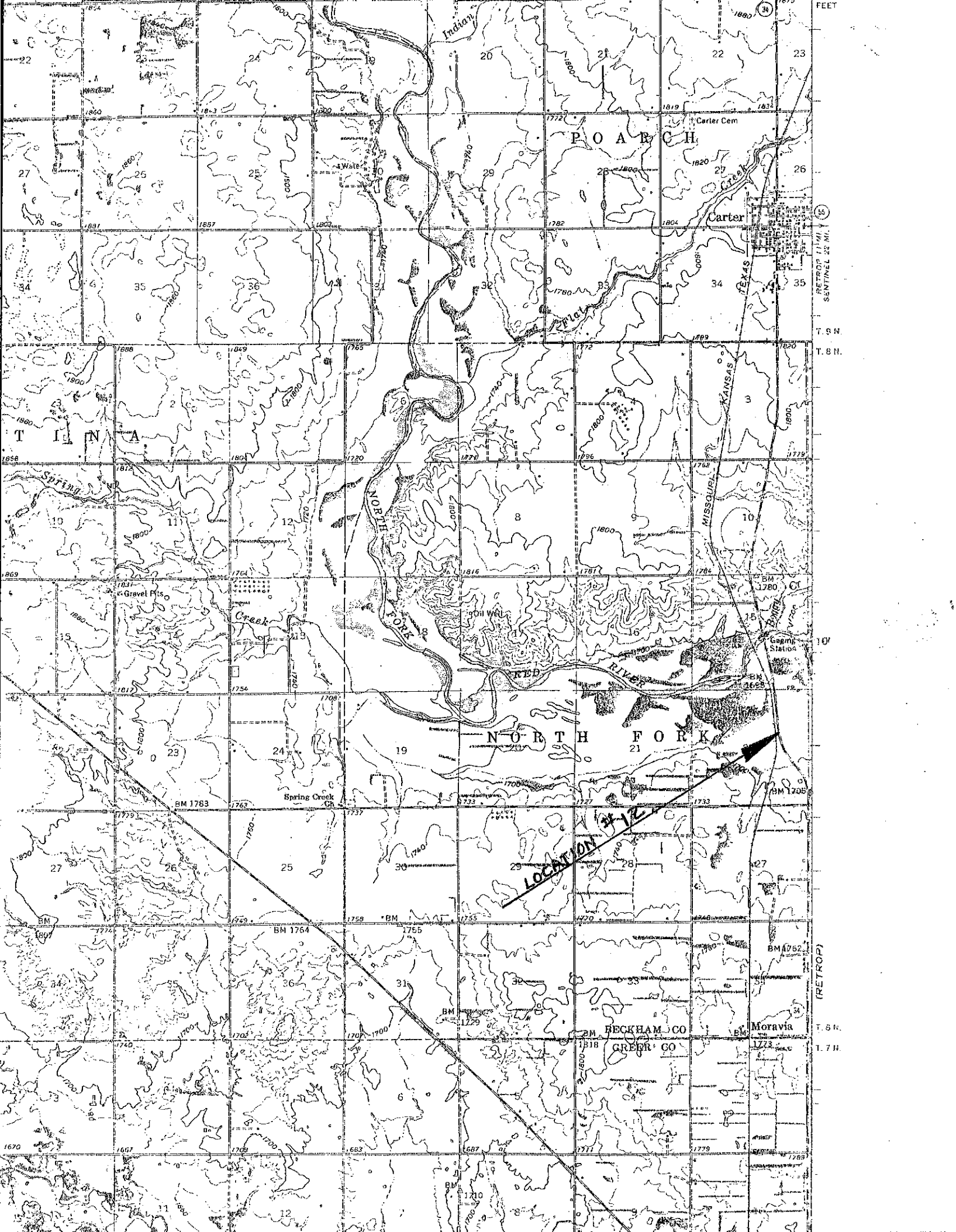

FEET

RETROP 11 MI SENTINEL 22 MI

T. 9 N.
T. 8 N.

(RETROP)

T. 8 N.
T. 7 N.

POARCH

Carter

T I N A

NORTH FORK

NORTH FORK

LOCATION #12

BECKHAM CO

GREER CO

Moravia

1670

1667

1700

1663

1667

1710

1771

1779

1769

27

26

25

30

29

28

27

34

35

36

31

30

33

34

22

23

24

25

26

27

28

27

26

25

30

29

28

27

22

23

24

25

26

27

28

27

26

25

24

23

22

21

34

35

36

31

30

29

28

10

11

12

13

14

15

16

6

7

8

9

10

11

12

23

24

25

26

27

28

29

23

24

25

26

27

28

29

27

26

25

30

29

28

27

34

35

36

31

30

29

28

22

23

24

25

26

27

28

27

26

25

30

29

28

27