



OKLAHOMA DEPARTMENT OF TRANSPORTATION
SURVEY DIVISION

FLOOD INFORMATION FORM

Division #:	1 <input type="checkbox"/> 2 <input checked="" type="checkbox"/> 3 <input type="checkbox"/> 4 <input type="checkbox"/> 5 <input type="checkbox"/> 6 <input type="checkbox"/> 7 <input type="checkbox"/> 8 <input type="checkbox"/>
County:	Atoka
Date Highwater occurred:	4/29/2016
Highway Number:	SH-131
Name of Stream:	North Boggy Creek
Direction and distance from nearest town, or highway junction	4 miles West of Jct. US 69 & 131 S. Kiowa
Section, Township, Range:	Section 12 T 2 N , R 12 E
Description of Location:	SE/4 Sec.12
Latitude	34° 39' 31.40"N
Longitude	95° 59' 21.42"W
Highwater Elevation:	628.04
Level Datum & Source:	NAVD88(ODOT Mon.A-3-743)
Method used:	Leveled from A-3-743
Date Elevation Obtained:	5/16/2016
Apparent Magnitude:	Normal <input type="checkbox"/> Medium <input type="checkbox"/> Extreme <input type="checkbox"/> Unknown <input checked="" type="checkbox"/>
Was Highwater Mark obtained from actual water, drift, local resident, or other source?	Highwater Elevation obtained from McAlester Field Survey Party Personnel who observed highwater.
Explanatory Remarks:	

Name (Signature) 
 Name (Printed) Darrel R Mason
 Date 5/17/2016

Note: Show Vicinity Map on back of form

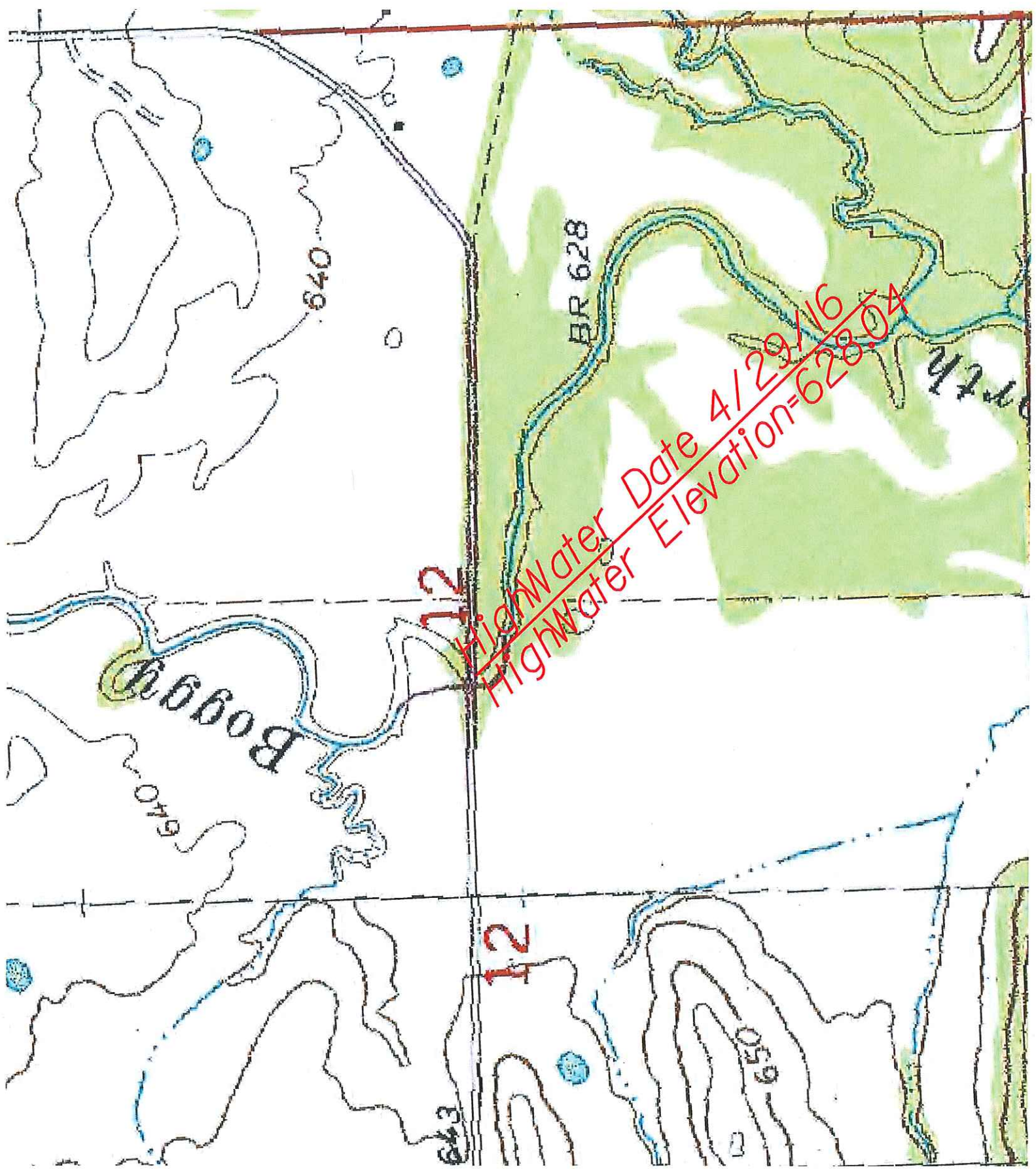

12

12

BR 628

Boggy

640

640

643

650

HighWater Date 4/29/16
HighWater Elevation=628.04