

STATE OF OKLAHOMA
DEPARTMENT OF HIGHWAYS
SURVEY DIVISION

FLOOD INFORMATION FORM

To be used in obtaining and transmitting flood water elevations for Survey Division office record files. This information to be obtained by all Chiefs of Party or others in their vicinity in times of unusual high water, or at any time available from a reliable source. The elevations can be recorded by level reading, by measurement from bridge floor, in relation to a house, above roadbed or any other dependable, clear manner that fits the situation, the highest order possible to be used. Separate report to be made on each crossing or place obtained.

County ATOKA Date highwater occurred OCTOBER 13 & 14, 1981

Highway number SH. 7 Name of stream CLEAR BOGGY

Direction and distance from nearest town, village or store APPROX. 11 MILES WEST OF ATOKA, OKLA. ON CLEAR BOGGY CREEK AT SH. 7.

Section, Township and Range SEC. 24, T-2-S, R-9-E.

Description of Location AT STATION 552+ SMALL BOX UNDER SH. 7, APPROX. 1/2 MILE EAST OF CLEAR BOGGY CREEK OVER FLOW BRIDGE.

Elevation 447.0 Source of levels FROM USPW NRS 388 (A) PLANS.

Method obtained MEASURED FROM ROAD Date obtained OCT. 14, 1981

Did it appear to be normal medium extreme do not know

Was highwater mark obtained from actual water, drift, local resident, U. S. Engineers, etc.? ACTUAL WATER

Explanatory Remarks HEAVY RAIN IN UPPER DRAINAGE AREA. ROAD CLOWED FOR APPROX. 20 HRS. - APPROX. 2.5 FEET OF WATER OVER ROADWAY.

Location to be shown on back of this sheet as a check.

Field Note: To be sent to
Survey Engineer

~~CHIEF OF PARTY~~ LOC. ENGR.

OCTOBER 22, 1981

Date

copy to Bridge Div. 11-4-81

Location No. 2

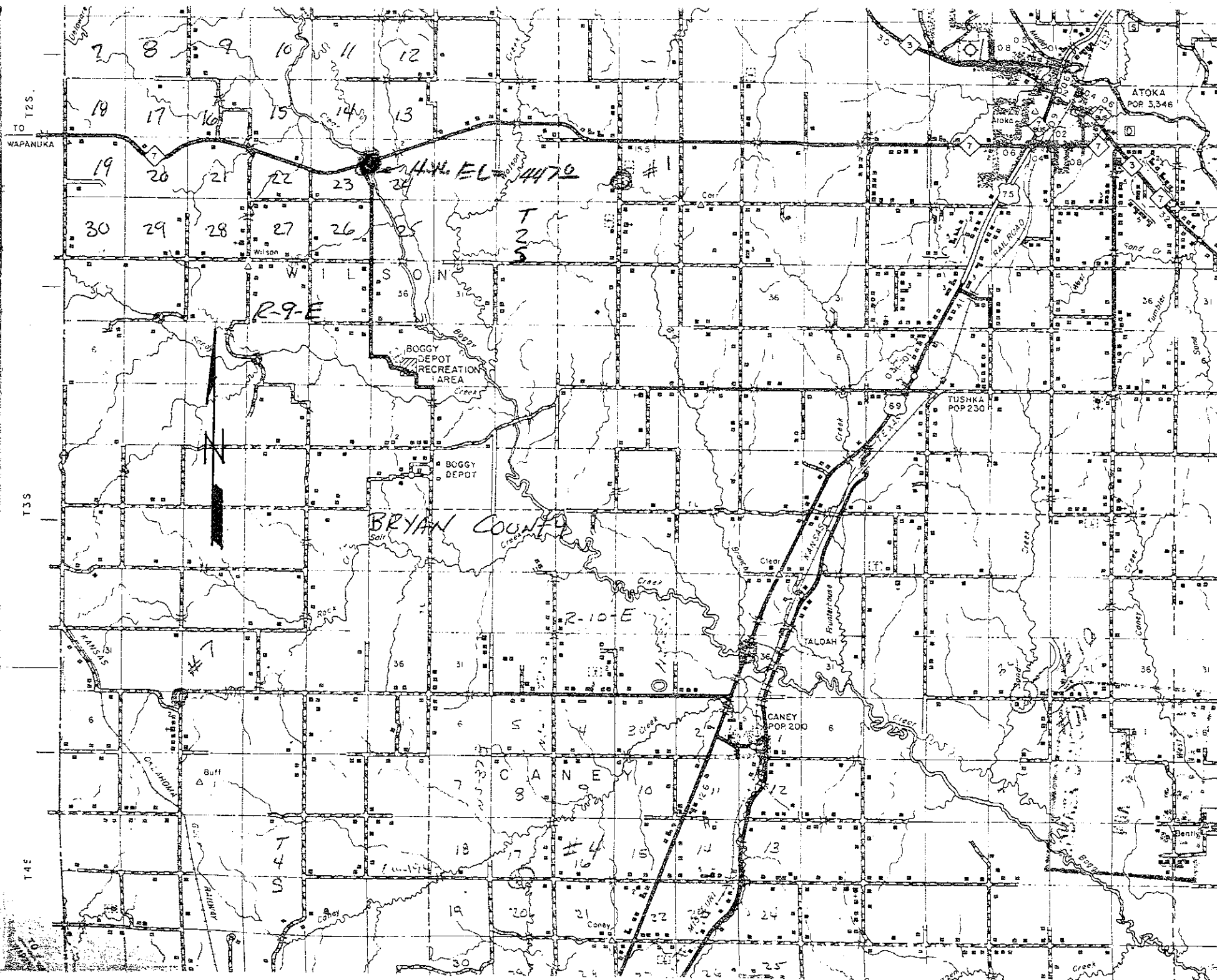

TO T2S.
WAPANUKA

T3S

T4E

2 8 9 10 11 12
19 17 16 15 14 13

30 29 28 27 26 25

R-9-E

BRYAN COUNTY

R-10-E

T-4-S

CANEY

ATOKA
POP 5,346

TUSHKA
POP 230

CANEY
POP 200

BOGGY DEPOT
RECREATION AREA

BOGGY DEPOT

TALOAH

WAGON CREEK

EL 4470

T-2-S

20

21

22

23

24

25

26

27

28

29

30

1

2

3

4

5

6

7

8

9

10

11

12

13

14

15

16

17

18

19

20

21

22

23

24

25

26

27

28

29

30

31

32

33

34

35

36

37

38

39

40

41

42

43

44

45

46

47

48

49

50

51

52

53

54

55

56

57

58

59

60

61

62

63

64

65

66

67

68

69

70

71

72

73

74

75

76

77

78

79

80

81

82

83

84

85

86

87

88

89

90

91

92

93

94

95

96

97

98

99

100

101

102

103

104

105

106

107

108

109

110

111

112

113

114

115

116

117

118

119

120

121

122