

RECEIVED
NOV 2 1981
SURVEY DIVISION

Survey Division
Form No. 16
Rev. Sept. 10, 1961

STATE OF OKLAHOMA
DEPARTMENT OF HIGHWAYS
SURVEY DIVISION

FLOOD INFORMATION FORM

To be used in obtaining and transmitting flood water elevations for Survey Division office record files. This information to be obtained by all Chiefs of Party or others in their vicinity in times of unusual high water, or at any time available from a reliable source. The elevations can be recorded by level reading, by measurement from bridge floor, in relation to a house, above roadbed or any other dependable, clear manner that fits the situation, the highest order possible to be used. Separate report to be made on each crossing or place obtained.

County ATOKA Date highwater occurred OCTOBER 13, 1981

Highway number US 69 Name of stream CLEAR BOGGY

Direction and distance from nearest town, village or store 1.5 MILES ^{North} SOUTH OF CANEY, OKLA. ON US 69.

Section, Township and Range SEC. 36, T-3-S, R-10-E.

Description of Location AT STATION 390 ON FAP 219 (3) - 1946 ASBUILT PLANS.

Elevation 515.0 Source of levels FROM FAP 219 (3) PLANS.

Method obtained MEASURED UP FROM BRIDGE Date obtained OCT. 14, 1981

Did it appear to be normal medium extreme do not know

Was highwater mark obtained from actual water, drift, local resident, U. S. Engineers, etc.? ACTUAL WATER AND DRIFTS.

Explanatory Remarks WATER OVER US 69 -HEAVY RAIN IN AREA AND ON UPPER DRAINAGE AREA.

Location to be shown on back of this sheet as a check.

Field Note: To be sent to
Survey Engineer

Oda Roy Lieb
~~XXXXXX~~
LOC. ENGR.
OCTOBER 22, 1981
Date

Copy to Bridge Div. 11-1-81

Location No. 15

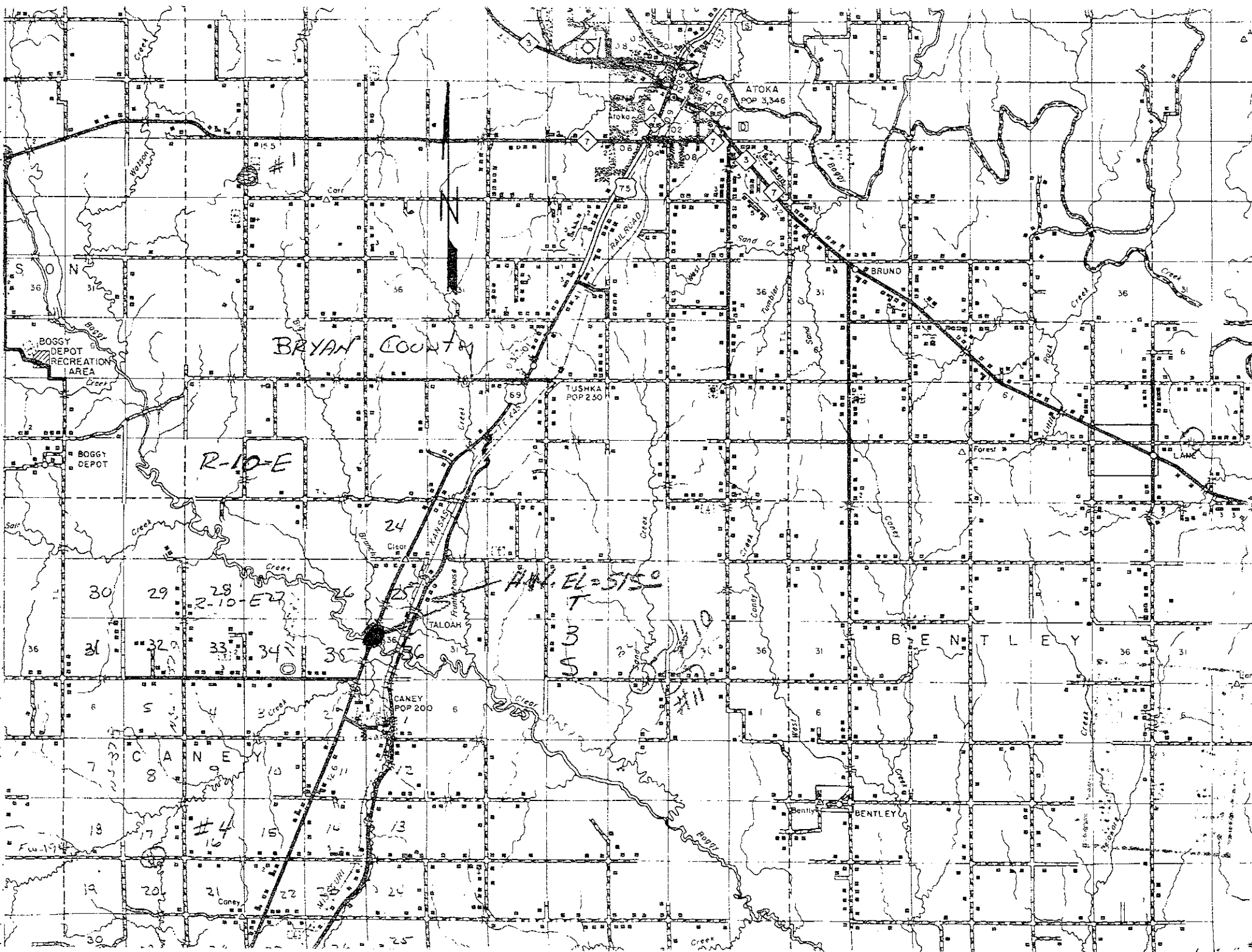

BRYAN COUNTY

ATOKA
POP 3,346

TUSHKA
POP 230

CANEY
POP 200

BRUND

BENTLEY

R-10-E

H.W. EL = 5150

T

3 S

TALOAH

CANEY

#4

MISSOURI

BOGGY DEPOT
RECREATION AREA

BOGGY DEPOT

Feb 1974