

STATE OF OKLAHOMA
DEPARTMENT OF HIGHWAYS
SURVEY DIVISION

FLOOD INFORMATION FORM

To be used in obtaining and transmitting flood water elevations for Survey Division office record files. This information to be obtained by all Chiefs of Party or others in their vicinity in times of unusual high water, or at any time available from a reliable source. The elevations can be recorded by level reading, by measurement from bridge floor, in relation to a house, above roadbed or any other dependable, clear manner that fits the situation, the highest order possible to be used. Separate report to be made on each crossing or place obtained.

County Alfalfa Date highwater occurred 8/15/1932

Highway number US 64 Name of stream _____

Direction and distance from nearest town, village or store In Cherokee, Okla

Section, Township and Range Sec 2 T26N R11W

Description of Location At the intersection of Grand Ave and 8Th St. In Cherokee, Oklahoma.

Elevation 1181.1 Source of levels USO&GS

Method obtained Wye Level Date obtained July 24, 1963

Did it appear to be normal medium extreme do not know

Was highwater mark obtained from actual water, drift, local resident, U. S. Engineers, etc.? Local resident Mr. L. T. Webster-Cherokee Abstract Co. Cherokee, Oklahoma.

Explanatory Remarks This highwater was caused by a dike overflowing from Cottonwood creek North and West of Cherokee. Also from caused from local water from the downpour

Location to be shown on back of this sheet as a check.

Field Note: To be sent to
Survey Engineer

James Perry
Chief of Party

June 24, 1963
Date

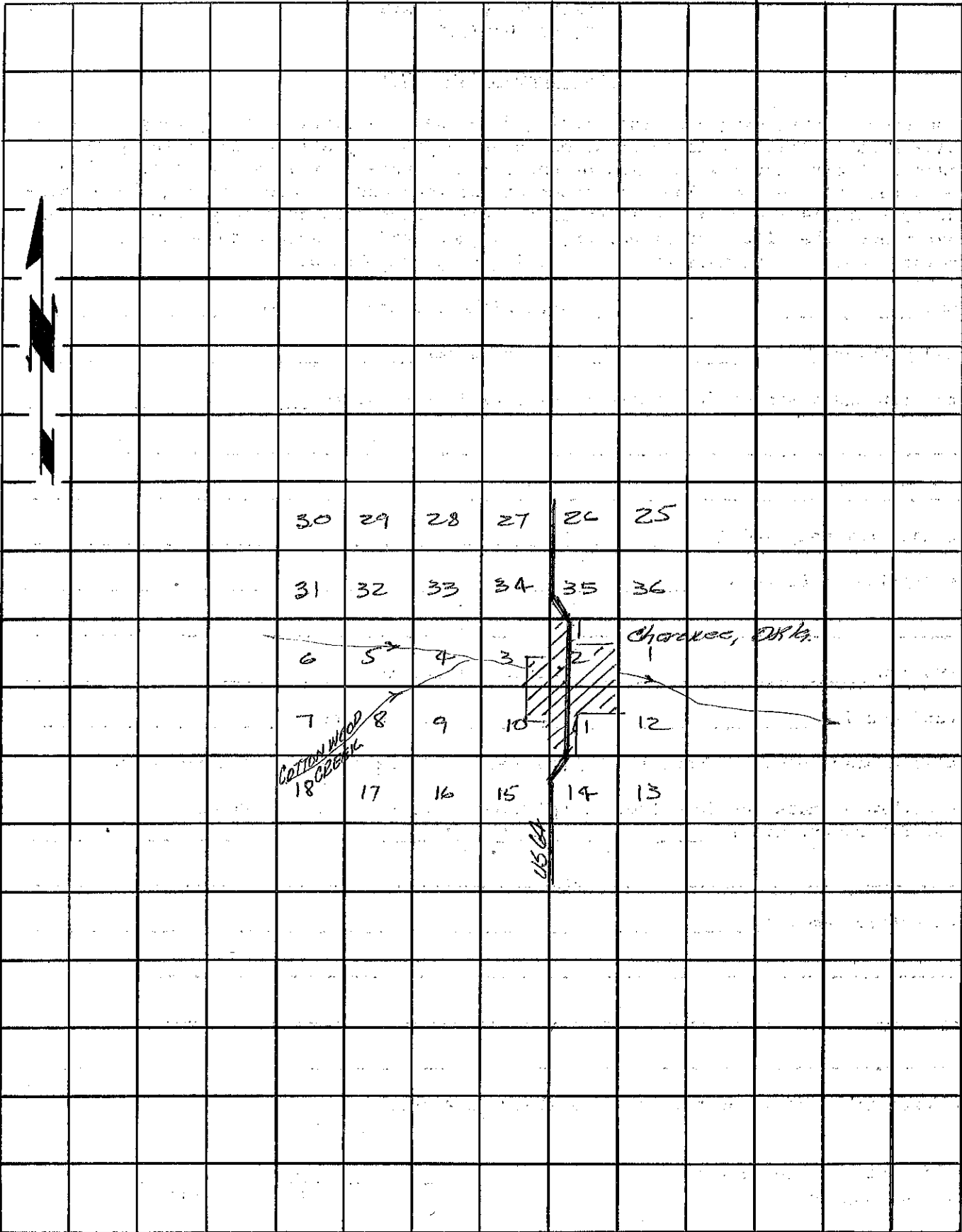

T
26
N

T
25
N

R11 W.