

STATE OF OKLAHOMA  
DEPARTMENT OF HIGHWAYS  
SURVEY DIVISION

FLOOD INFORMATION FORM

To be used in obtaining and transmitting flood water elevations for Survey Division office record files. This information to be obtained by all Chiefs of Party or others in their vicinity in times of unusual high water, or at any time available from a reliable source. The elevations can be recorded by level reading, by measurement from bridge floor, in relation to a house, above roadbed or any other dependable, clear manner that fits the situation, the highest order possible to be used. Separate report to be made on each crossing or place obtained.

County Alfalfa Date highwater occurred June 23, 1963

Highway number US 64 Name of stream \_\_\_\_\_

Direction and distance from nearest town, village or store In Cherokee, Oklahoma

Section, Township and Range Sec 2 T26N R11W

Description of Location At the intersection of Grand Ave and 8 Th St in Cherokee, Oklahoma

Elevation obtained 50 Ft. Mt of Station 360/50 SWO 2568(1)

Elevation 1178.70 Source of levels USC&GS

Method obtained Wye Level Date obtained June 24, 1963

Did it appear to be  normal  medium  extreme  do not know

Was highwater mark obtained from actual water, drift, local resident, U. S. Engineers, etc.? Local resident Mr. Alvin Summers of 800 Grand Ave. Cherokee, Okla. and drift 50 Ft. Mt. of Station 360/40 of SWO 2568(1)

Explanatory Remarks This Highwater was caused by a reported 9-12 inch rain, falling in about Six hours. This water was not as high as it was in 1932 This highwater was caused from local water and not from overflow from Cottonwood Creek

Location to be shown on back of this sheet as a check.

Field Note: To be sent to  
Survey Engineer

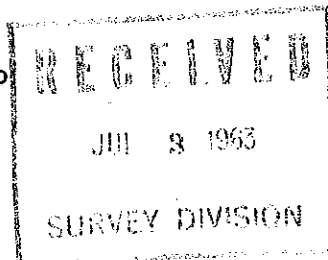

James Berry  
Chief of Party  
June 29, 1963  
Date

LOC. # 10

R11 W.

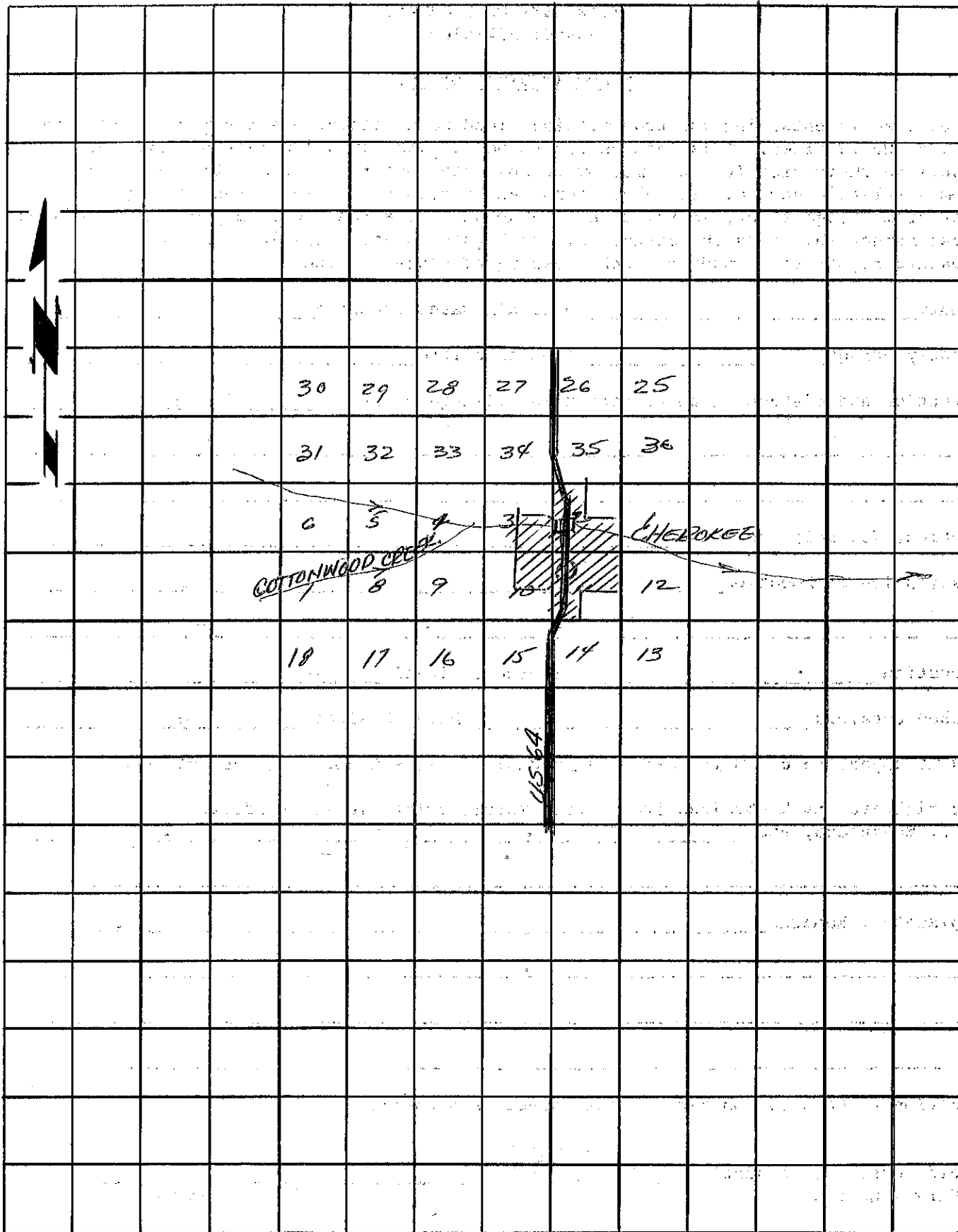

T  
27  
N

T  
26  
N