



OKLAHOMA DEPARTMENT OF TRANSPORTATION  
SURVEY DIVISION

FLOOD INFORMATION FORM

Division #:	1 <input type="checkbox"/> 2 <input type="checkbox"/> 3 <input type="checkbox"/> 4 <input type="checkbox"/> 5 <input type="checkbox"/> 6 <input checked="" type="checkbox"/> 7 <input type="checkbox"/> 8 <input type="checkbox"/>
County:	Alfalfa
Date Highwater occurred:	9/12/2008
Highway Number:	S.H.45
Name of Stream:	none
Direction and distance from nearest town, or highway junction	4.98 miles east of jct. SH45 & SH8.
Section, Township, Range:	Sec. 23, T-24-N, R-11-W
Description of Location:	4' x 2' RCB @ Sta. 218+68
Highwater Elevation:	0.2' above centerline of pavement.
Level Datum & Source:	F.A.S.P. No. S-160(12)CS
Method used:	Conventional Level
Date Elevation Obtained:	9/16/2008
Apparent Magnitude:	Normal <input type="checkbox"/> Medium <input type="checkbox"/> Extreme <input checked="" type="checkbox"/> Don't Know <input type="checkbox"/>
Was Highwater Mark obtained from actual water, drift, local resident, or other source?	Waterline & drift
Explanatory Remarks:	<del>Due to 12" of rain</del> Due to 6" to 12" rains

Note: Show Vicinity Map on back of form

Name (signature)

Name (Printed)

Dary Williams

Date:

Survey Division

Form No. 16

Revised: 5/09/2007

GENERAL HIGHWAY MAP ALFALF

ALL RIGHTS RESERVED

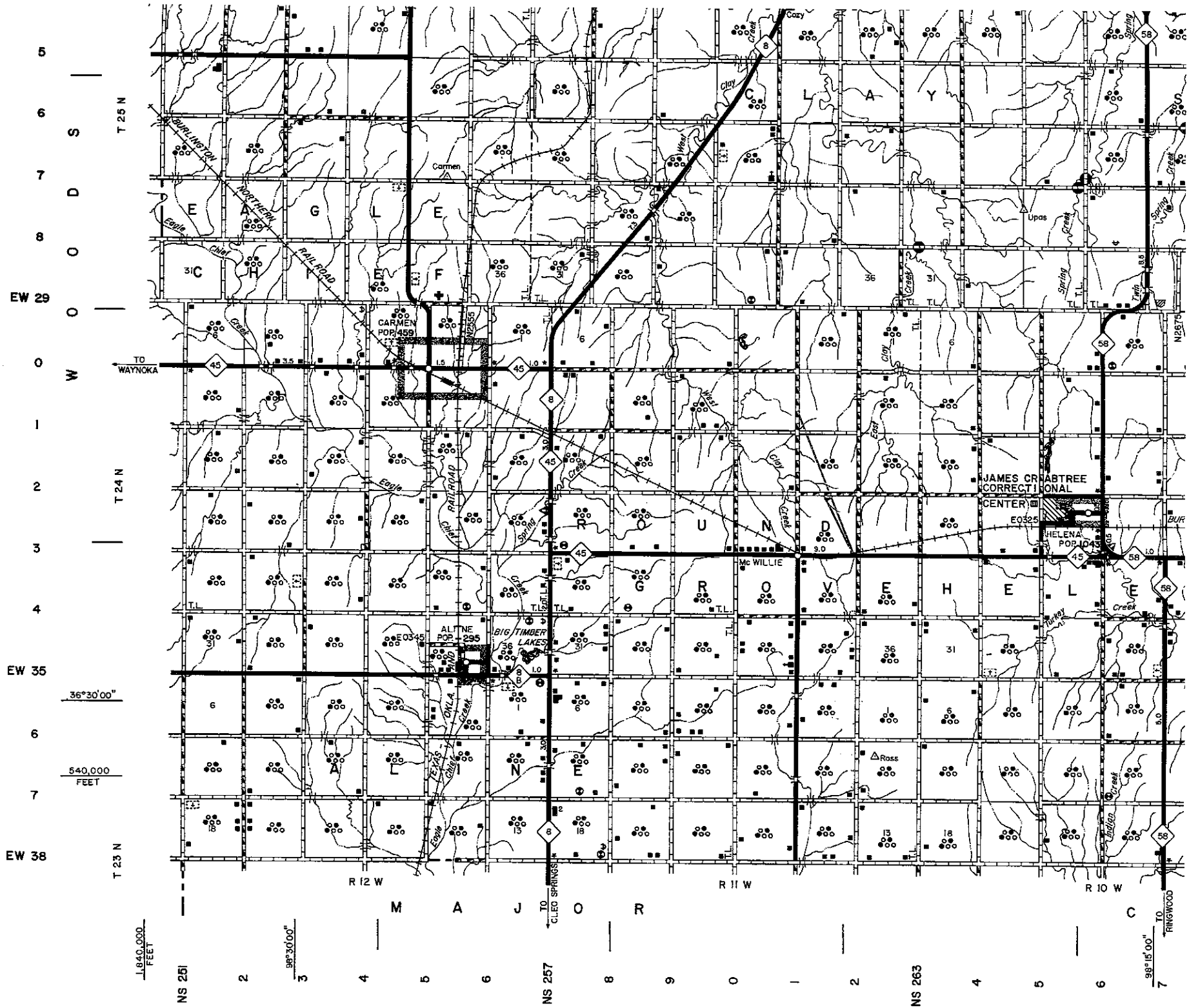

5  
6  
7  
8  
EW 29  
0  
1  
2  
3  
4  
EW 35  
6  
7  
EW 38

T 25 N  
T 24 N  
T 23 N

1:640,000  
FEET

36°30'00"  
540,000  
FEET

NS 251

2

3

4

5

6

7

8

9

0

1

2

3

4

5

6

7

NS 263

2

3

4

5

6

7

1:640,000  
FEET

36°15'00"  
TO RINGWOOD