

OKLAHOMA DEPARTMENT OF TRANSPORTATION
SURVEY DIVISION

FLOOD INFORMATION FORM

Division #:	1 <input type="checkbox"/> 2 <input type="checkbox"/> 3 <input type="checkbox"/> 4 <input type="checkbox"/> 5 <input type="checkbox"/> 6 <input checked="" type="checkbox"/> 7 <input type="checkbox"/> 8 <input type="checkbox"/>
County:	Alfalfa
Date Highwater occurred:	9/12/2008
Highway Number:	S.H.45
Name of Stream:	none
Direction and distance from nearest town, or highway junction	8.06 miles east of jct. SH45 & SH8.
Section, Township, Range:	Sec. 28, T-24-N, R-10-W
Description of Location:	8' x 5' RCB @ Sta. 55+07
Highwater Elevation:	0.8' above centerline of pavement.
Level Datum & Source:	F.A.S.P. No. S-160(12)CS
Method used:	Conventional Level
Date Elevation Obtained:	9/16/2008
Apparent Magnitude:	Normal <input type="checkbox"/> Medium <input type="checkbox"/> Extreme <input checked="" type="checkbox"/> Don't Know <input type="checkbox"/>
Was Highwater Mark obtained from actual water, drift, local resident, or other source?	Waterline & drift
Explanatory Remarks:	Due to 12" of rain Due to 6" to 12" rains

Note: Show Vicinity Map on back of form

Name (signature)
 Name (Printed)
 Date:

Daryl Williams
 Daryl Williams

GENERAL HIGHWAY MAP ALFALFI

ALL RIGHTS RESERVED

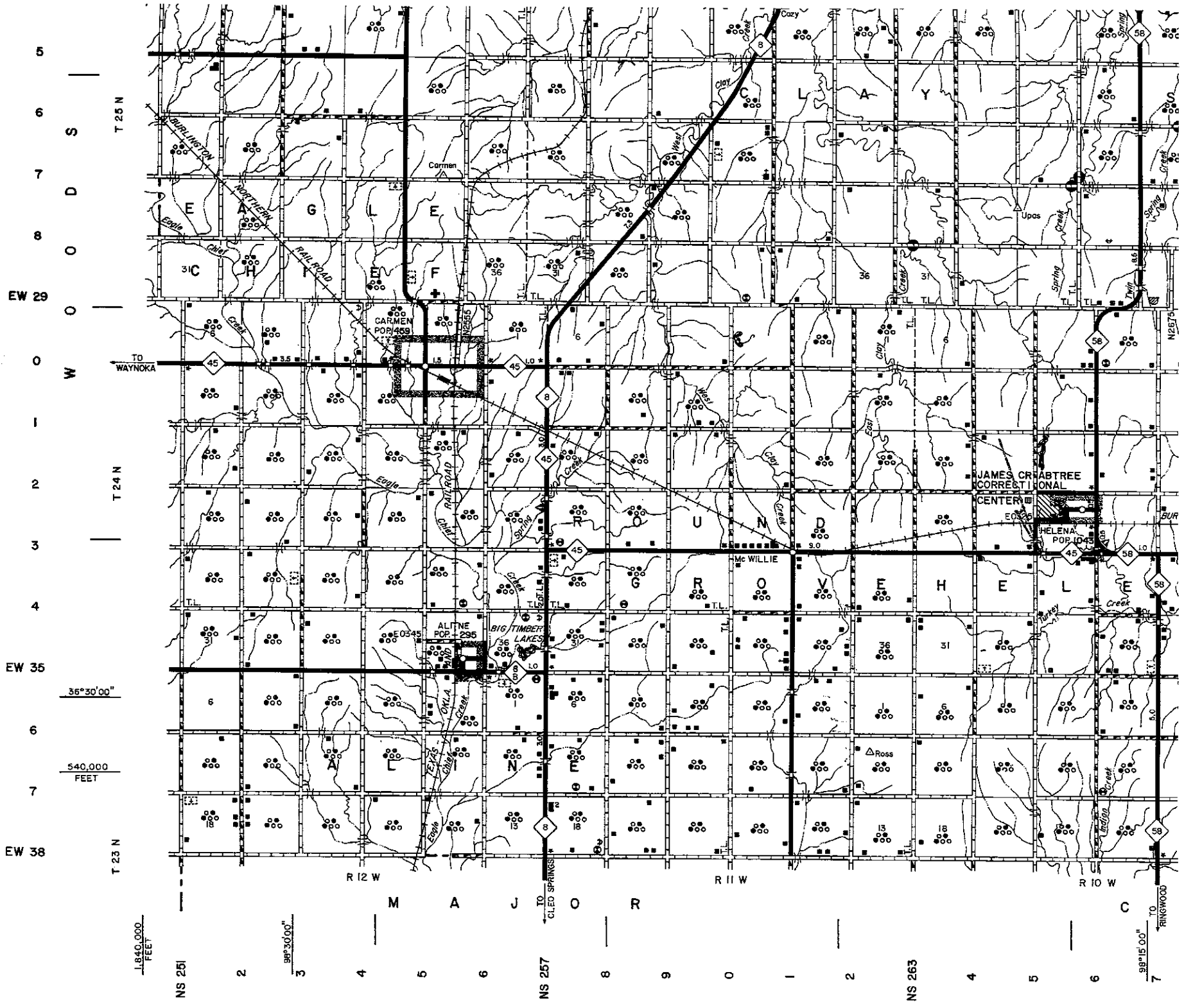

5
6
7
8
EW 29
0
1
2
3
4
EW 35
6
7
EW 38

S
O
D
O
W
T 25 N
T 24 N
T 23 N

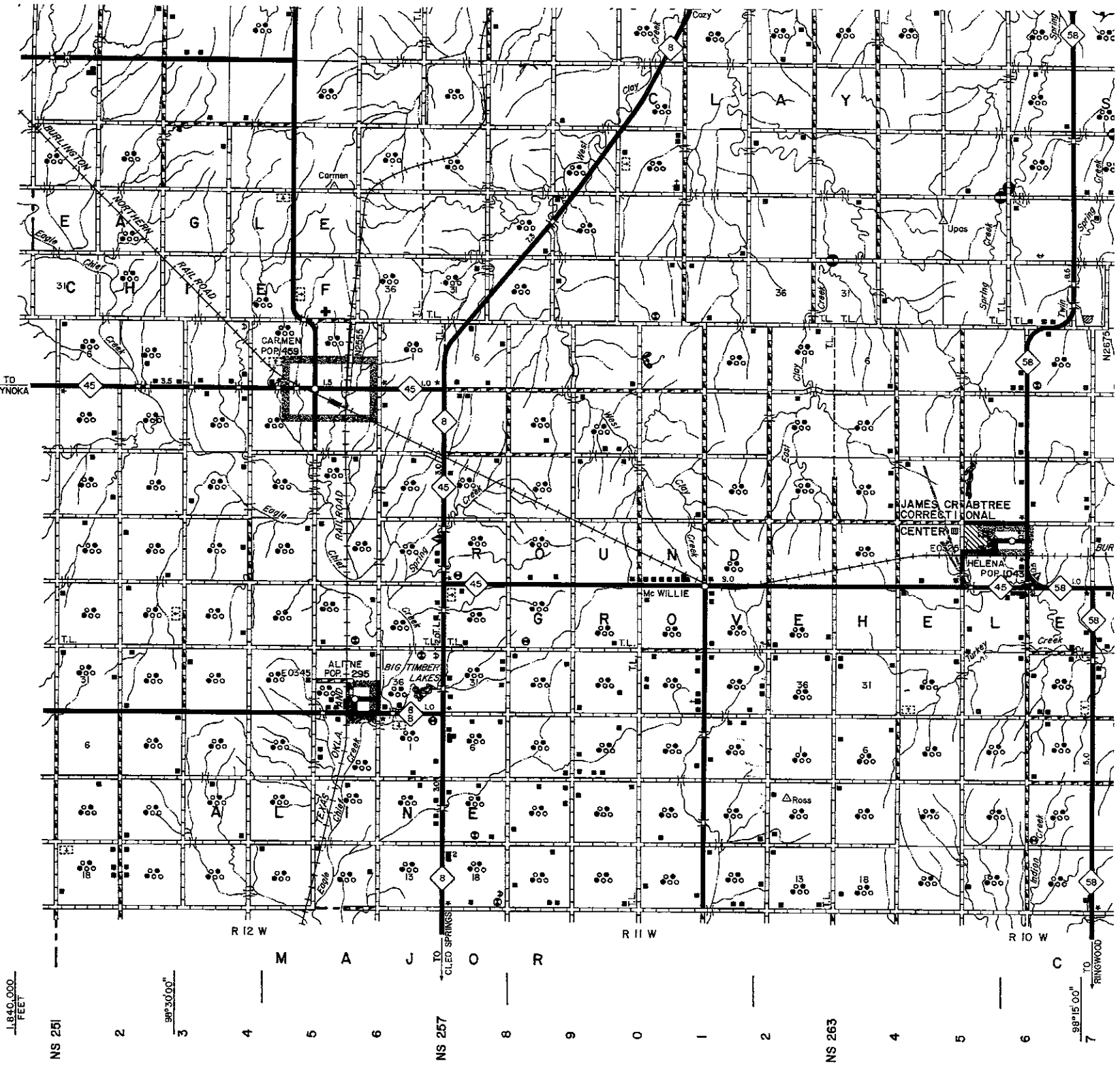

NS 251
2
3
4
5
NS 257
8
9
0
1
2
NS 263
4
5
6
7
TO RINGWOOD

1,840,000 FEET
36°30'00"
540,000 FEET