

OKLAHOMA DEPARTMENT OF TRANSPORTATION SURVEY DIVISION

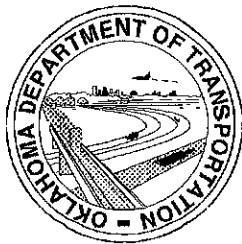

FLOOD INFORMATION FORM

| | |
|---|--|
| Division #: | 1 <input type="checkbox"/> 2 <input type="checkbox"/> 3 <input type="checkbox"/> 4 <input type="checkbox"/> 5 <input type="checkbox"/> 6 <input checked="" type="checkbox"/> 7 <input type="checkbox"/> 8 <input type="checkbox"/> |
| County: | Alfalfa |
| Date Highwater occurred: | 9/12/2008 |
| Highway Number: | S.H.45 |
| Name of Stream: | none |
| Direction and distance from nearest town, or highway junction | 8.07 miles east of jct. SH45 & SH8. |
| Section, Township, Range: | Sec. 28, T-24-N, R-10-W |
| Description of Location: | 8' x 5' RCB @ Sta. 55+30 |
| Highwater Elevation: | 0.5' above centerline of pavement. |
| Level Datum & Source: | F.A.S.P. No. S-160(12)CS |
| Method used: | Conventional Level |
| Date Elevation Obtained: | 9/16/2008 |
| Apparent Magnitude: | Normal <input type="checkbox"/> Medium <input type="checkbox"/> Extreme <input checked="" type="checkbox"/> Don't Know <input type="checkbox"/> |
| Was Highwater Mark obtained from actual water, drift, local resident, or other source? | Waterline & drift |
| Explanatory Remarks: | Due to 10" of rain Due to 6" to 12" rains |

Note: Show Vicinity Map on back of form

Name (signature) Daryl Williams
 Name (Printed) Daryl Williams
 Date:

GENERAL HIGHWAY MAP ALFALFI

ALL RIGHTS RESERVED

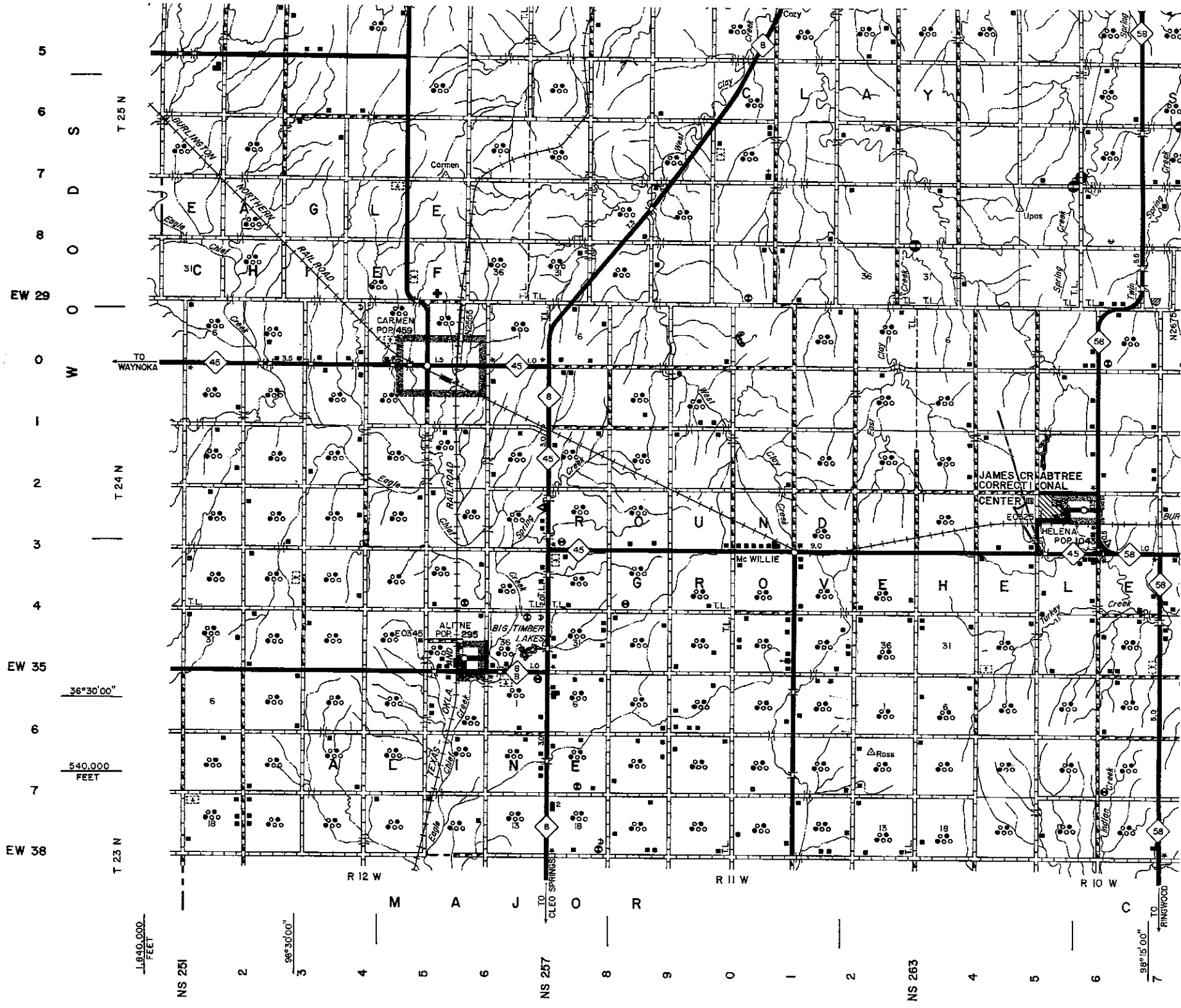

5
6
7
8
EW 29
0
1
2
3
4
EW 35
6
7
FW 38

T 25 N
T 24 N
T 23 N

NS 251
2
3
4
5
6
NS 257
8
9
0
1
2
NS 263
4
5
6
7

36°30'00"
540,000
FEET

1:640,000
FEET

99°30'00"

98°15'00"