

**OKLAHOMA DEPARTMENT OF TRANSPORTATION  
SURVEY DIVISION**

**FLOOD INFORMATION FORM**

<b>Division #:</b>	1 <input type="checkbox"/> 2 <input type="checkbox"/> 3 <input type="checkbox"/> 4 <input type="checkbox"/> 5 <input type="checkbox"/> 6 <input checked="" type="checkbox"/> 7 <input type="checkbox"/> 8 <input type="checkbox"/>
<b>County:</b>	Alfalfa
<b>Date Highwater occurred:</b>	9/12/2008
<b>Highway Number:</b>	S.H.45
<b>Name of Stream:</b>	none
<b>Direction and distance from nearest town, or highway junction</b>	8.38 miles east of jct. SH45 & SH8.
<b>Section, Township, Range:</b>	Sec. 21, T-24-N, R-10-W
<b>Description of Location:</b>	Double 8' x 4' RCB @ Sta. 38+00
<b>Highwater Elevation:</b>	1.4' above centerline of pavement.
<b>Level Datum &amp; Source:</b>	F.A.S.P. No. S-160(12)CS
<b>Method used:</b>	Conventional Level
<b>Date Elevation Obtained:</b>	9/16/2008
<b>Apparent Magnitude:</b>	Normal <input type="checkbox"/> Medium <input type="checkbox"/> Extreme <input checked="" type="checkbox"/> Don't Know <input type="checkbox"/>
<b>Was Highwater Mark obtained from actual water, drift, local resident, or other source?</b>	Waterline & drift
<b>Explanatory Remarks:</b>	<del>Due to 12" rains</del> Due to 6" to 12" rains

Note: Show Vicinity Map on back of form

Name (signature) *Daryl Williams*  
 Name (Printed) Daryl Williams  
 Date: \_\_\_\_\_

GENERAL HIGHWAY MAP ALFALF

ALL RIGHTS RESERVED

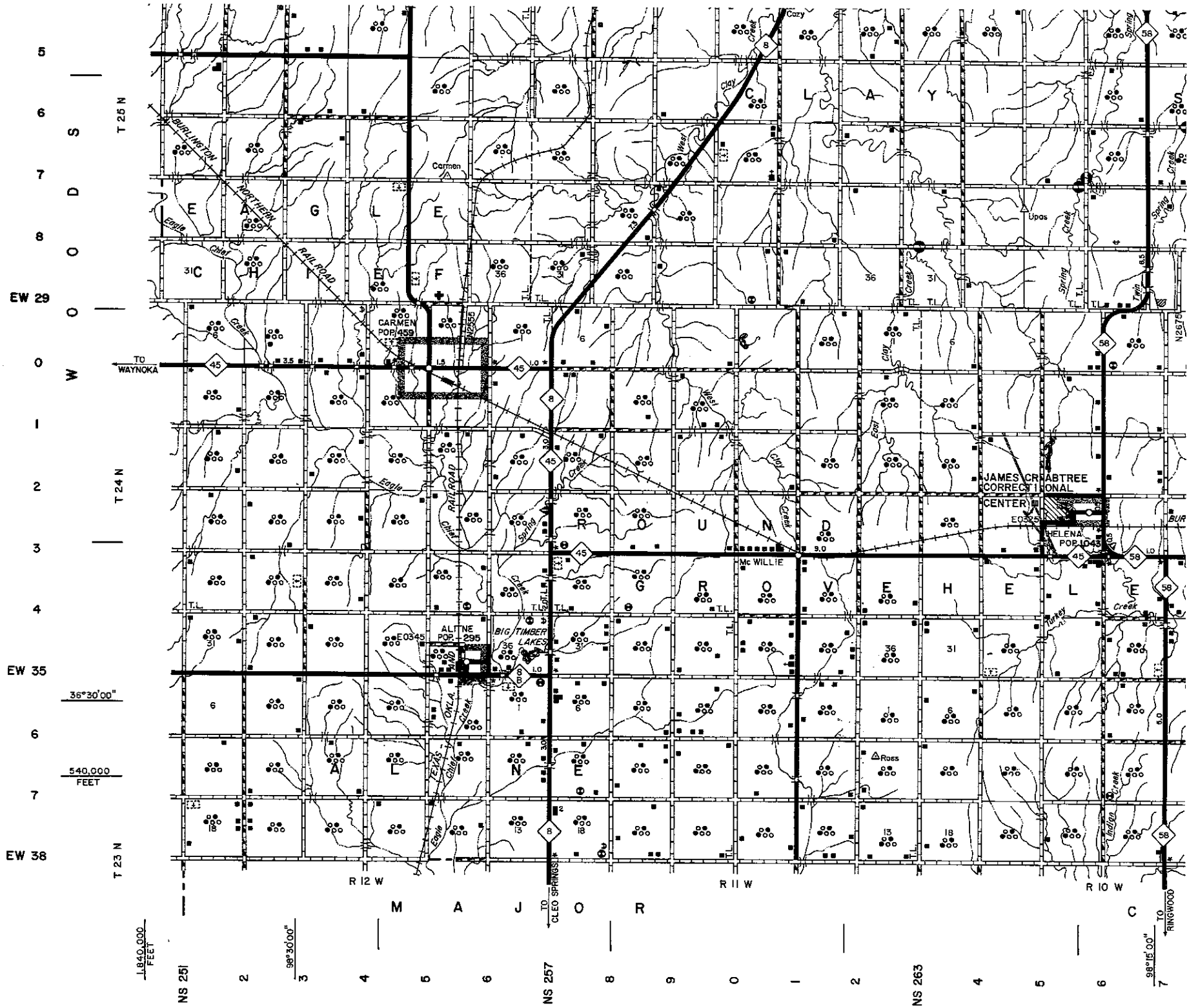

5  
6  
7  
8  
EW 29  
0  
1  
2  
3  
4  
EW 35  
6  
7  
EW 38

T 25 N  
T 24 N  
T 23 N

NS 251  
2  
3  
4  
5  
6  
NS 257  
8  
9  
0  
1  
2  
NS 263  
4  
5  
6  
7

TO WAYNOKA

TO CLEO SPRINGS

TO RINGWOOD

36°30'00"  
540,000  
FEET

1840,000  
FEET

99°30'00"