

OKLAHOMA DEPARTMENT OF TRANSPORTATION
SURVEY DIVISION

FLOOD INFORMATION FORM

Division #:	1 <input type="checkbox"/> 2 <input type="checkbox"/> 3 <input type="checkbox"/> 4 <input type="checkbox"/> 5 <input type="checkbox"/> 6 <input checked="" type="checkbox"/> 7 <input type="checkbox"/> 8 <input type="checkbox"/>
County:	Alfalfa
Date Highwater occurred:	9/12/2008
Highway Number:	S.H.45
Name of Stream:	none
Direction and distance from nearest town, or highway junction	0.35 miles east of jct. of SH45 & SH58 north.
Section, Township, Range:	Sec. 22, T-24-N, R-10-W
Description of Location:	8' x 4' RCB @ Sta. 20+30.3
Highwater Elevation:	1.2' above centerline of pavement.
Level Datum & Source:	F.A.S. No. S-160(1)
Method used:	Conventional Level
Date Elevation Obtained:	9/16/2008
Apparent Magnitude:	Normal <input type="checkbox"/> Medium <input type="checkbox"/> Extreme <input checked="" type="checkbox"/> Don't Know <input type="checkbox"/>
Was Highwater Mark obtained from actual water, drift, local resident, or other source?	Waterline & drift
Explanatory Remarks:	Due to 12" of rain Due to 6" to 12" rains

Note: Show Vicinity Map on back of form

Name (signature)
Name (Printed)
Date:

Daryl Williams
Daryl Williams

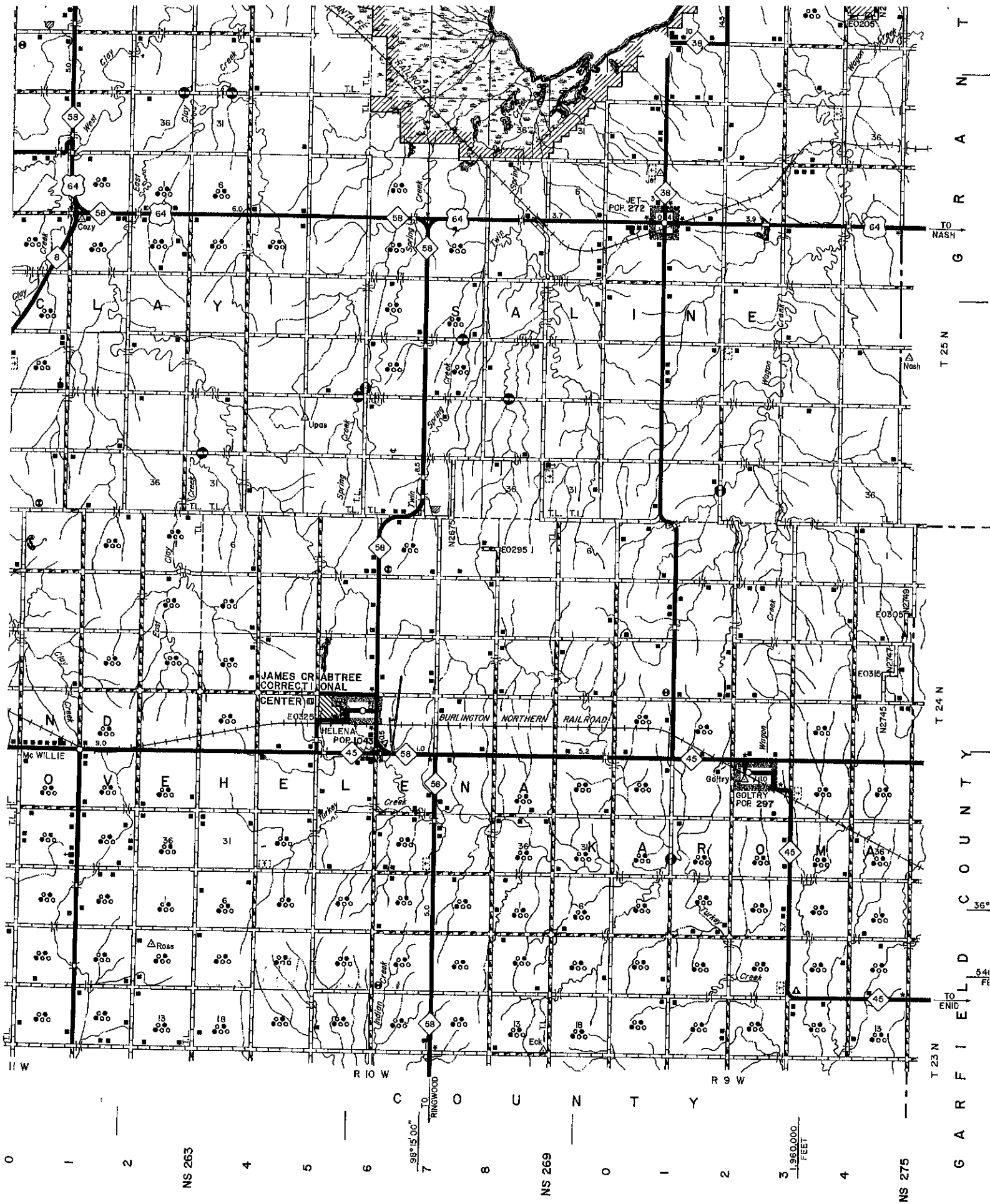

GENERAL HIGHWAY
ALFALFA CO