



**OKLAHOMA DEPARTMENT OF TRANSPORTATION**  
SURVEY DIVISION

**FLOOD INFORMATION FORM**

<b>Division #:</b>	1 <input type="checkbox"/> 2 <input type="checkbox"/> 3 <input type="checkbox"/> 4 <input type="checkbox"/> 5 <input type="checkbox"/> 6 <input checked="" type="checkbox"/> 7 <input type="checkbox"/> 8 <input type="checkbox"/>
<b>County:</b>	Alfalfa
<b>Date Highwater occurred:</b>	9/12/2008
<b>Highway Number:</b>	S.H.45
<b>Name of Stream:</b>	none
<b>Direction and distance from nearest town, or highway junction</b>	0.38 miles east of jct. of SH45 & SH58 north.
<b>Section, Township, Range:</b>	Sec. 22, T-24-N, R-10-W
<b>Description of Location:</b>	3' x 2' RCB @ Sta. 18+59.5
<b>Highwater Elevation:</b>	1.2' above centerline of pavement.
<b>Level Datum &amp; Source:</b>	F.A.S. No. S-160(1)
<b>Method used:</b>	Conventional Level
<b>Date Elevation Obtained:</b>	9/16/2008
<b>Apparent Magnitude:</b>	Normal <input type="checkbox"/> Medium <input type="checkbox"/> Extreme <input checked="" type="checkbox"/> Don't Know <input type="checkbox"/>
<b>Was Highwater Mark obtained from actual water, drift, local resident, or other source?</b>	Waterline & drift
<b>Explanatory Remarks:</b>	<del>Due to 12" rains</del> Due to 6" to 12" rains

Note: Show Vicinity Map on back of form

Name (signature) Daryl Williams  
 Name (Printed) Daryl Williams  
 Date:

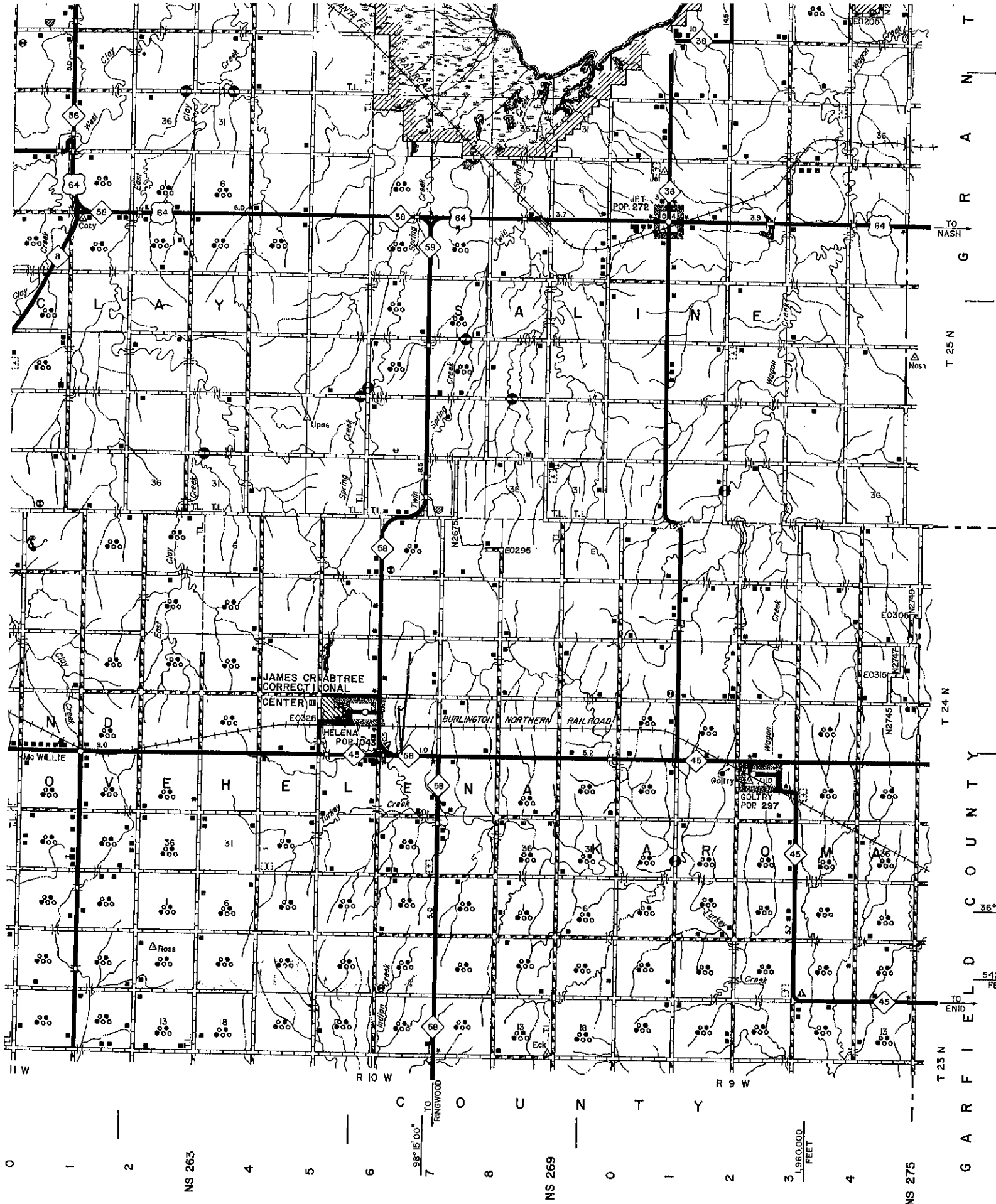

T 25 N  
TO NASH  
G R A N T  
T 24 N  
C O U N T Y  
36°  
TO ENID  
G A R F I E L D  
T 23 N

0 1 2 NS 263 4 5 6 7 8 NS 269 0 1 2 3 4 NS 275  
93° 15' 00" TO RAINWOOD  
1:960,000  
FEET

GENERAL HIGHWAY  
**ALFA CC**