

STATE OF OKLAHOMA
DEPARTMENT OF HIGHWAYS
SURVEY DIVISION

FLOOD INFORMATION FORM

To be used in obtaining and transmitting flood water elevations for Survey Division office record files. This information to be obtained by all Chiefs of Party or others in their vicinity in times of unusual high water, or at any time available from a reliable source. The elevations can be recorded by level reading, by measurement from bridge floor, in relation to a house, above roadbed or any other dependable, clear manner that fits the situation, the highest order possible to be used. Separate report to be made on each crossing or place obtained.

County Alfalpa Date highwater occurred June 23, 1963
Highway number US 64 Name of stream Cottonwood
~~Highway~~ Creek
Direction and distance from nearest town, village or store In Cherokee, Oklahoma

Section, Township and Range Sec. 2 T26N R11W

Description of Location At the light and Water Plant at Cherokee, Oklahoma at the intersection of Grand Ave. and Madison St.

Elevation 1182.0 Source of levels USC&GS

Method obtained Wye Level Date obtained June 24, 1963

Did it appear to be normal medium extreme do not know

Was highwater mark obtained from actual water, drift, local resident, U. S. Engineers, etc.? Obtained from drift and local resident Mr. Roy Hutchinson 401 North Penn St. Cherokee, Oklahoma

Explanatory Remarks There was a water mark 1.1 Ft. on the floor of the light and Water Plant Bldg. in Cherokee, Oklahoma, at Grand and Madison St. in Cherokee. This water was overflow from Cottonwood creek, about $\frac{1}{2}$ block north. this highwater was caused by a reported 9-12 Inch Rain that fell in a six hour period. The water at this time is not as high as it was in 1932. This Highwater was caused from local water and overflow from cottonwood creek.

Location to be shown on back of this sheet as a check.

Field Note: To be sent to
Survey Engineer

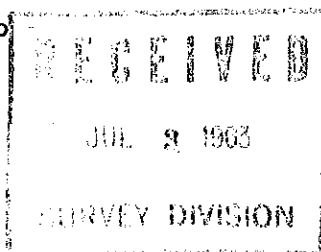

James Perry
Chief of Party
June 29, 1963
Date

R11 W.

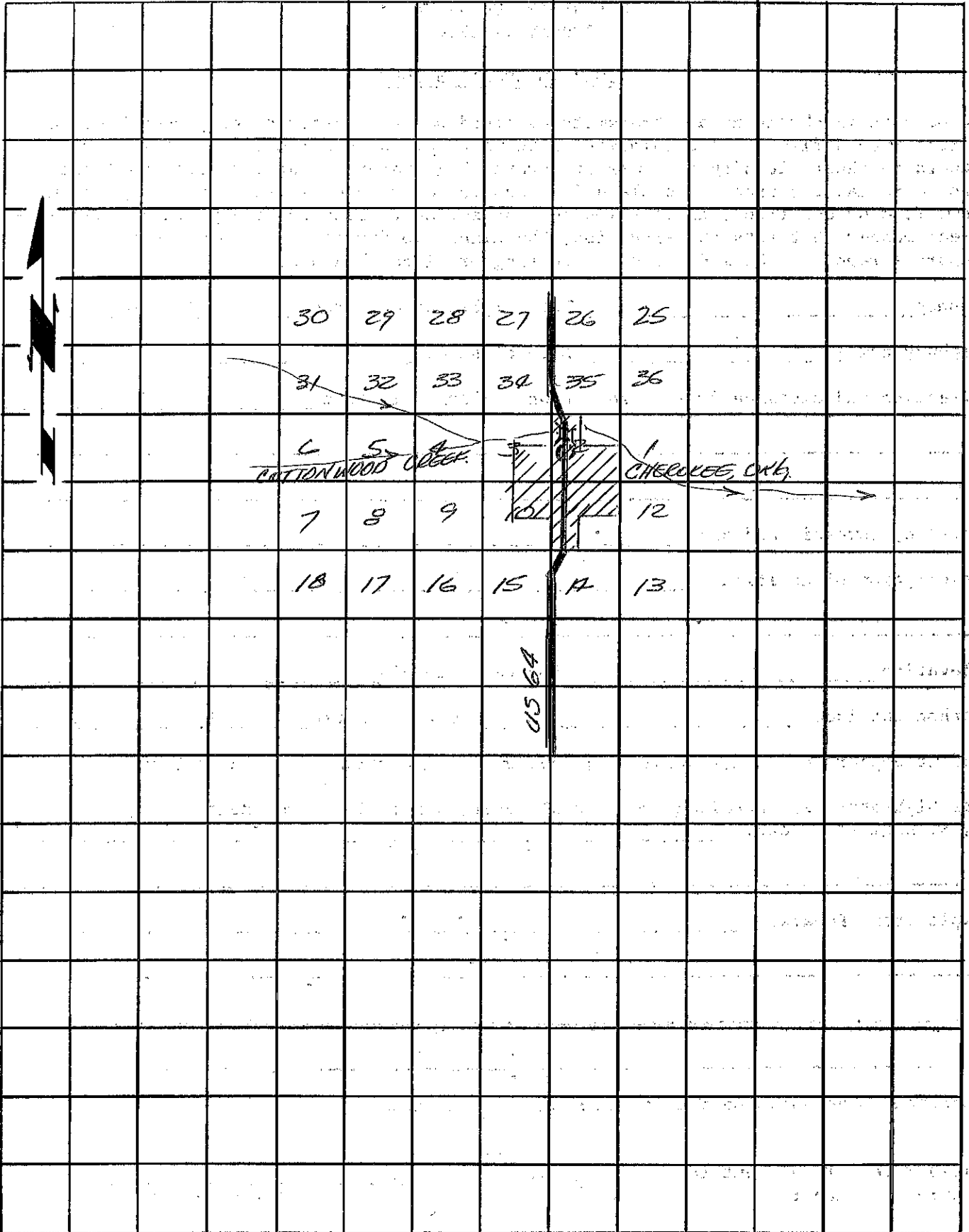

T 27 N

T 26 N