

RECEIVED
AUG 18 1948
PLANS & SURVEYS
DEPARTMENT

Plans & Survey Dept.
Form No. 16
Rev. July 10, 1947

STATE OF OKLAHOMA
DEPARTMENT OF HIGHWAYS
PLANS AND SURVEY DEPARTMENT

FLOOD INFORMATION FORM

To be used in obtaining and transmitting flood water elevations for Plans & Survey office record files. This information to be obtained by all Chiefs of Party in their vicinity in times of unusual high water, or at any time available from a reliable source. The elevations can be recorded by level reading, by measurement from bridge floor, in relation to a house, above roadbed or any other dependable, clear manner that fits the situation, the highest order possible to be used. Separate report to be made on each crossing or place obtained.

County Adair Date highwater occurred August 14, 1948

Highway number US 59 Name of stream Ballard Creek

Direction and distance from nearest town, village or store 0.5 south of store at Ballard or 2.0 miles south of Watts

Section, Township and Range Section 25 - T 19 N - R 24 East

Description of Location at KCS R.R. Bridge Number "B" 238 over Ballard Creek

Note - This is the bridge that is farthest south of the 2

Method obtained 9.30 below top of rail

Elevation _____ Source of levels _____

Was highwater mark obtained from actual water, drift, local resident, U. S. Engineers, etc? Given by Lester Morris Truck Foreman for the Okla. State highway dept. and by water mark on RR bridge

Explanatory Remarks _____

Location to be shown on back of this sheet as a check.

Field Note: To be sent to Engr. of Plans & Survey (1 copy).
Office Note: To be filed in Flood Information by Counties.

[Signature]
Chief of Party

August 17, 1948
Date

LOC. #1

R24E

R25E

N61N

T18N

22 23 24 White 25 26

27 28 29

30

31 32

33

34 35 36 Westville 37 38

39

40

41

42

43

44

45

46

47

48

49

50

Bohland store

High water

Bridge 46 8 233

ADAIR County

U.S. 59

US 59

Bohland Creek

Bohland Creek

SPRINGFIELD

40

STATE

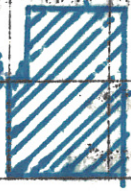
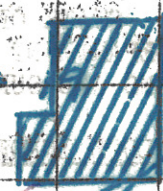

FRANCIS LAKE