

Plans & Survey Dept.  
Form No. 16  
Rev. July 10, 1947

STATE OF OKLAHOMA  
DEPARTMENT OF HIGHWAYS  
PLANS AND SURVEY DEPARTMENT

FLOOD INFORMATION FORM

964 607  
126  
957,093

To be used in obtaining and transmitting flood water elevations for Plans & Survey office record files. This information to be obtained by all Chiefs of Party in their vicinity in times of unusual high water, or at any time available from a reliable source. The elevations can be recorded by level reading, by measurement from bridge floor, in relation to a house, above roadbed or any other dependable, clear manner that fits the situation, the highest order possible to be used. Separate report to be made on each crossing or place obtained.

County Adair Date highwater occurred May 10, 1950

Highway number 45 #59 Name of stream Ballard Creek

Direction and distance from nearest town, village or store 1 1/2 south of Watts at KCS RR. Bridge # A-238

Section, Township and Range Sec 25 T-19-N R-25-E

Description of Location At KCS RR. Bridge # A-238

Method obtained Level

Elevation 957.09 Source of levels USC & G.S.

Was highwater mark obtained from actual water, drift, local resident, U. S. Engineers, etc? Drift & water line on RR Bridge Abut.

Explanatory Remarks \_\_\_\_\_

Location to be shown on back of this sheet as a check.

Field Note: To be sent to Engr. of Plans & Survey (1 copy).  
Office Note: To be filed in Flood Information by Counties.

Walter L. Armstrong  
Chief of Party  
May 12, 1950  
Date

Loc. #2

R-25-E

R-26-E

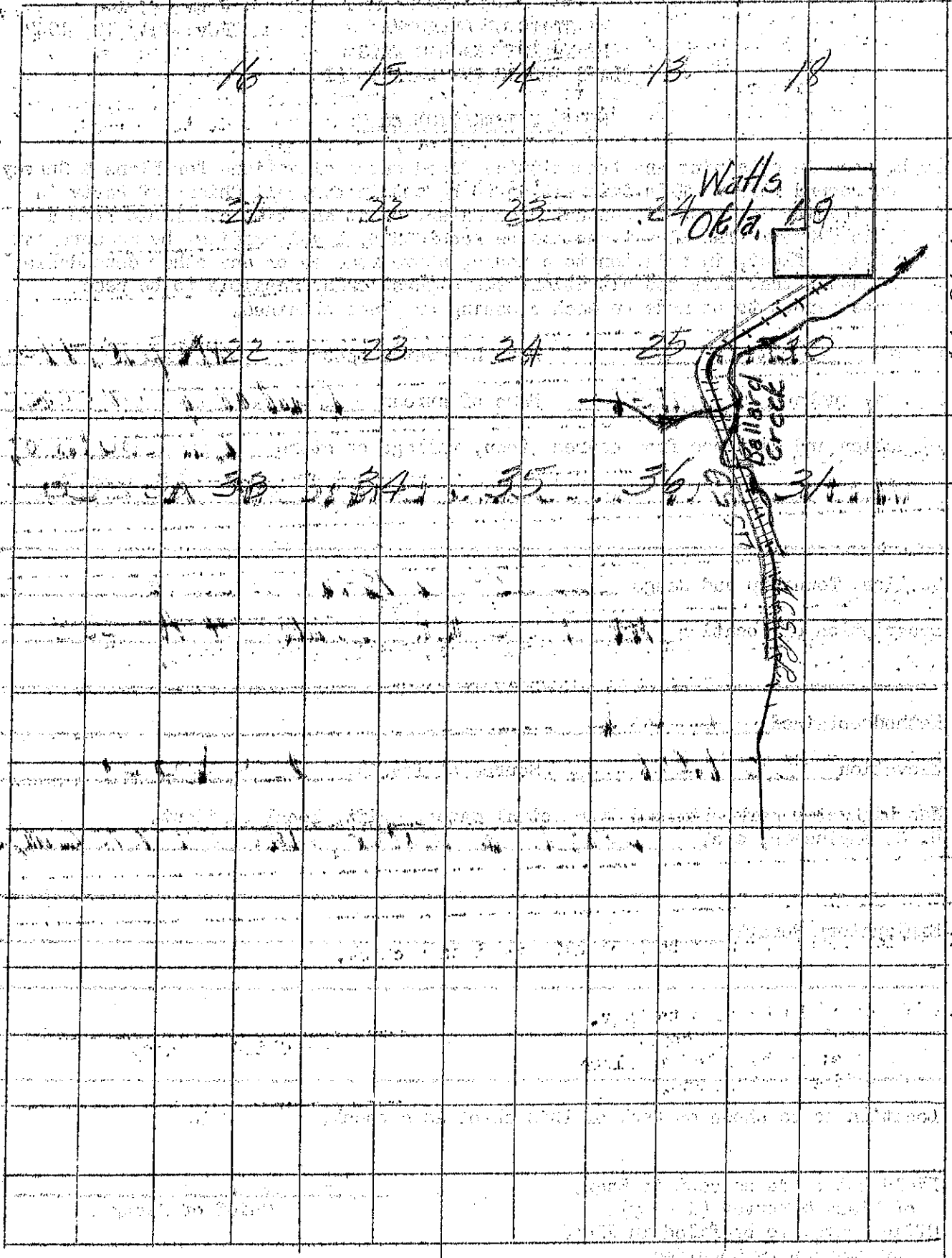

N-61-E