

STATE OF OKLAHOMA
DEPARTMENT OF HIGHWAYS
SURVEY DIVISION

FLOOD INFORMATION FORM

To be used in obtaining and transmitting flood water elevations for Survey Division office record files. This information to be obtained by all Chiefs of Party or others in their vicinity in times of unusual high water, or at any time available from a reliable source. The elevations can be recorded by level reading, by measurement from bridge floor, in relation to a house, above roadbed or any other dependable, clear manner that fits the situation, the highest order possible to be used. Separate report to be made on each crossing or place obtained.

County Adair County Date highwater occurred 5/2/1990

Highway number U.S. 59 Name of stream Illinois River

Direction and distance from nearest town, village or store Approx. 2 miles north of Watts.

Section, Township and Range Sec 18 T19N R26E

Description of Location Approx. 3.3 miles south of West Siloam Springs on U.S. 59

Elevation _____ Source of levels _____

Method obtained Fennel Level Date obtained 5/7/1990

Did it appear to be normal medium extreme do not know

Was highwater mark obtained from actual water, drift, local resident, U. S. Engineers, etc.? Actual water

Explanatory Remarks Top water was down 11.4 from top opening Illinois River Bridge

Location to be shown on back of this sheet as a check.

Field Note: To be sent to
Survey Engineer

Jon R. [Signature]
Professional Land Surveyor

Copy to Bridge Div. 6-19-90 6/13/90
Date

Copy with map to Bridge. 8/19/90 REGISTRATION No. 4

DELAWARE COUNTY

SURVEY LOCATION

SEPTON COUNTY
A R K A N S A S
WASHINGTON COUNTY

C R A W F O R D COUNTY
S T A T E
O F

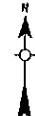

LEGEND

- ROADS
- RAILROADS
- WATER
- LAND
- ...

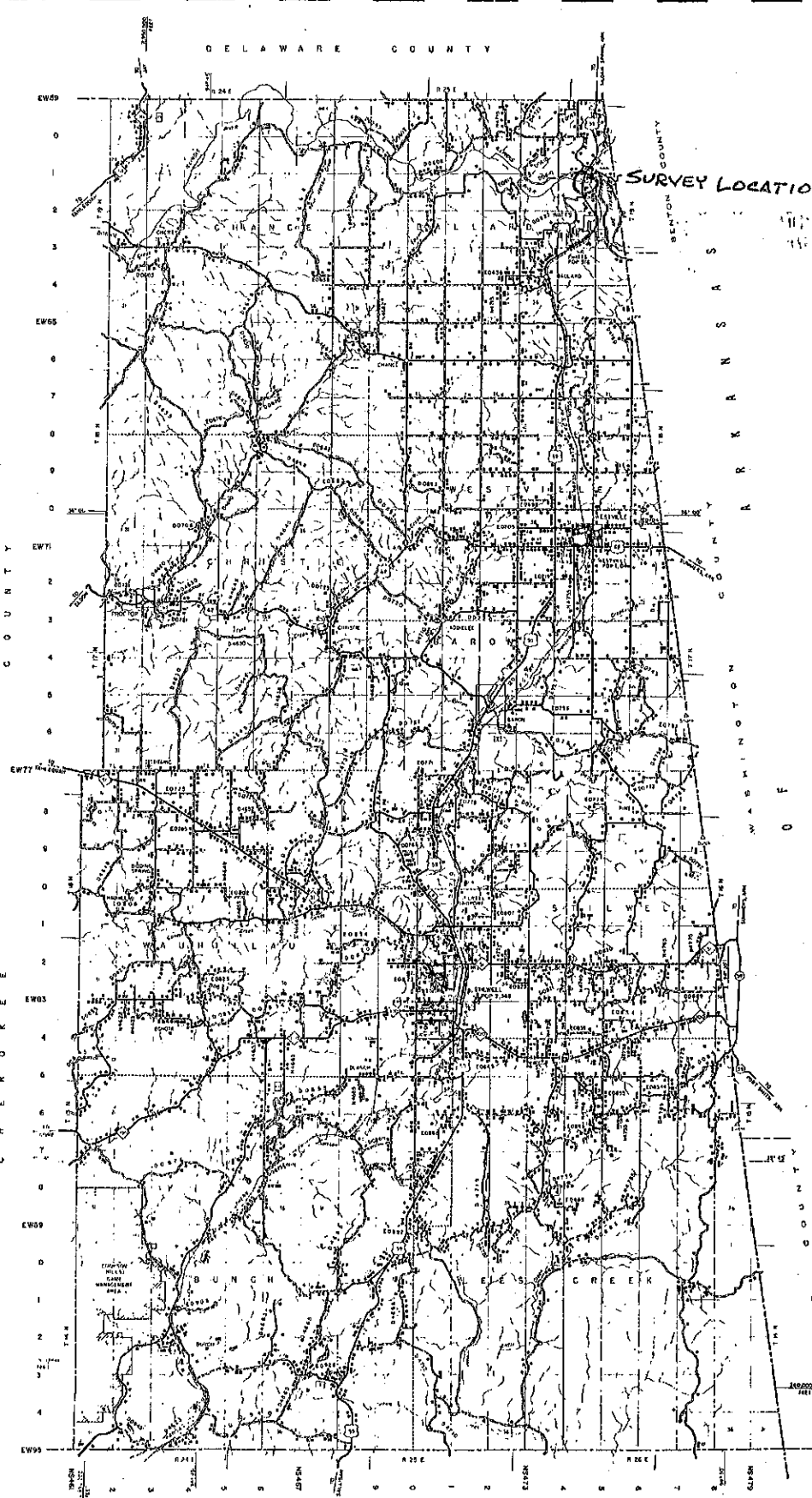

GENERAL INFORMATION MAP ADAPTED FROM THE U.S. GEOLOGICAL SURVEY TOPOGRAPHIC MAPS OF THE STATE OF ARKANSAS, 1890-1900. THE MAP IS A REPRODUCTION OF THE ORIGINAL MAP AND IS NOT A SURVEY. THE BOUNDARIES SHOWN ON THIS MAP ARE NOT GUARANTEED BY THE U.S. GEOLOGICAL SURVEY.