

STATE OF OKLAHOMA  
DEPARTMENT OF HIGHWAYS  
SURVEY DIVISION

Survey Division  
Form No. 16  
Rev. Sept. 10, 1961

FLOOD INFORMATION FORM

To be used in obtaining and transmitting flood water elevations for Survey Division office record files. This information to be obtained by all Chiefs of Party or others in their vicinity in times of unusual high water, or at any time available from a reliable source. The elevations can be recorded by level reading, by measurement from bridge floor, in relation to a house, above roadbed or any other dependable, clear manner that fits the situation, the highest order possible to be used. Separate report to be made on each crossing or place obtained.

County Adair Date highwater occurred 11/24/73

Highway number U.S. 59 Name of stream Ballard Creek

Direction and distance from nearest town, village or store 2.8 miles South of Watts

Section, Township and Range Section 36 T-18-N R-26-E

Description of Location North 6.9 miles on U.S. 59 from Jct. U.S. 62 & U.S. 59 at Westville

Elevation \_\_\_\_\_ Source of levels \_\_\_\_\_

Method obtained \_\_\_\_\_ Date obtained 11/26/73

Did it appear to be  normal  medium  extreme  do not know

Was highwater mark obtained from actual water, drift, local resident, U. S. Engineers, etc.? Obtained from drift

Explanatory Remarks Shot top N. E. Wing Wall for a B.M. Had a 17.3 on drift below bridge for a highwater shot. (B.M. 3.80)

Location to be shown on back of this sheet as a check.

Field Note: To be sent to  
Survey Engineer

James Wayne Haynes  
~~CHIEF OF PARTY~~  
Location Engineer  
12/19/73  
Date

Loc. No. 8

R-26-E

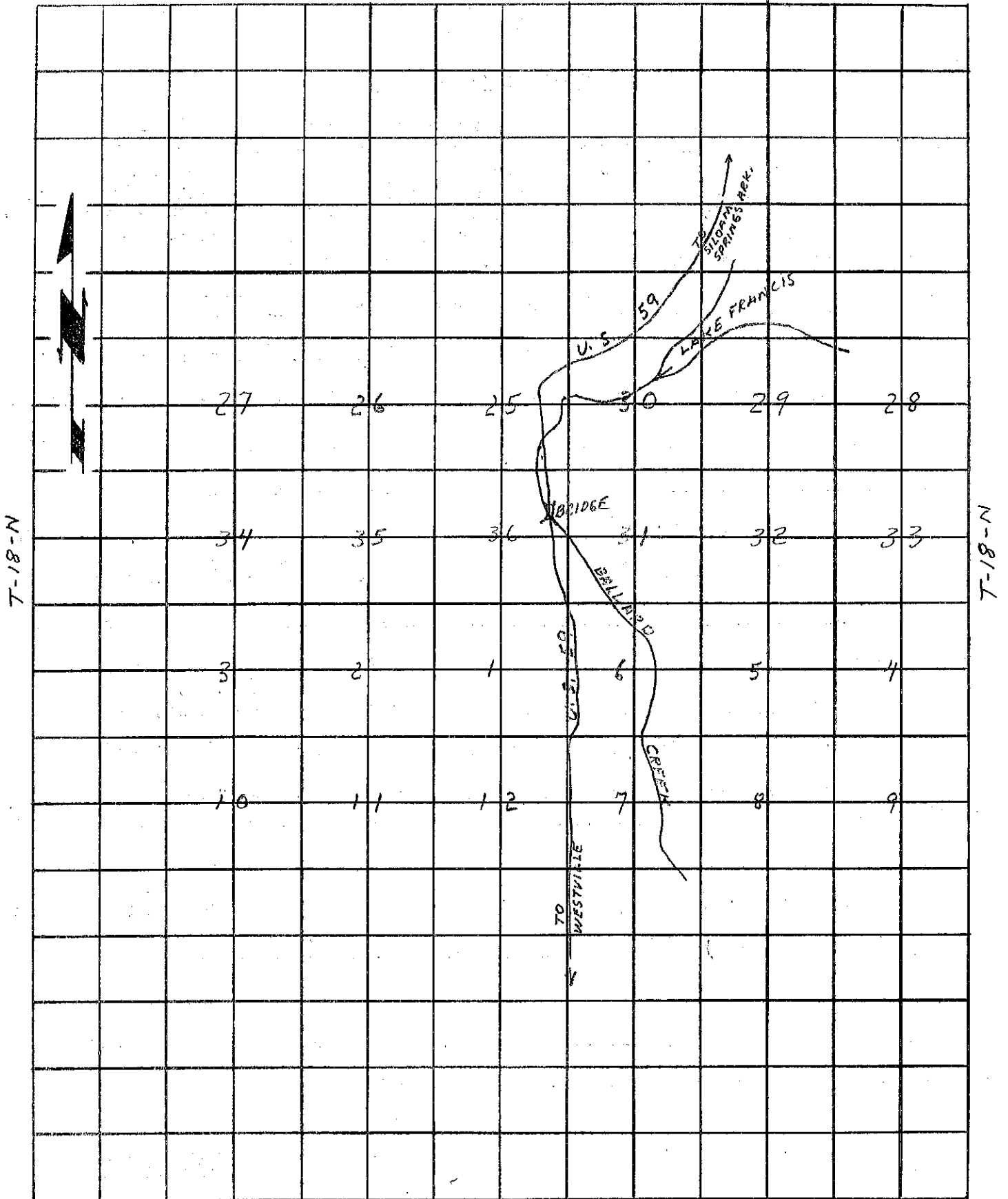

R-26-E